

- POURED IN PLACE CONCRETE**
- POURED IN PLACE CONCRETE MEMBERS ARE DESIGNED ON THE BASIS OF ULTIMATE STRENGTH DESIGN IN ACCORDANCE WITH ACI 318-05. "BUILDING CODE REQUIREMENTS FOR STRUCTURAL CONCRETE."
  - POURED IN PLACE CONCRETE WORK SHALL BE PROPORTIONED IN ACCORDANCE WITH ACI 301, "SPECIFICATIONS FOR STRUCTURAL CONCRETE." THE FOLLOWING CONCRETE SPECIFICATIONS SHALL BE PRODUCED AT 28 DAYS:

MEMBER	STRENGTH (PSI)	MAXIMUM AGG. SIZE	MAXIMUM W/C RATIO
BEAMS	3000	3/4"	0.60
COLUMNS	3000	3/4"	0.60
GROUTED CELLS	3000	3/8"	0.60
  - DESIGN MIXES SHALL MEET OR EXCEED THE SPECIFICATIONS PROVIDED. WHERE STRENGTH AND WATER-CEMENT RATIOS ARE PROVIDED, THE MOST STRINGENT SHALL GOVERN.
  - CONCRETE SLUMP LIMITATIONS SHALL BE 4" MINIMUM, AND 6" MAXIMUM. SLUMP LIMITATIONS FOR MASONRY GROUTED CELLS SHALL BE 9" MAXIMUM.
  - UNDER NO CIRCUMSTANCES SHALL WATER BE ADDED TO A CONCRETE MIX AFTER CONCRETE HAS BEEN DISCHARGED FROM THE BATCH PLANT.
  - POURED IN PLACE CONCRETE TRANSPORTED AT THE JOB BY CONCRETE PUMP SHALL BE DESIGNED ACCORDINGLY.
  - ALL POURED IN PLACE CONCRETE SHALL BE CONSOLIDATED THROUGH THE USE OF MECHANICAL VIBRATORS.
  - CONCRETE COVER TO REINFORCING STEEL SHALL BE IN ACCORDANCE WITH ACI 318, WITH THE FOLLOWING MINIMUM REQUIREMENTS:

SLABS	1"
BEAMS AND COLUMNS	1-1/2"
FORMED CONCRETE BELOW GRADE	2"
CONCRETE CAST AGAINST SOIL	3"
  - POURED IN PLACE CONCRETE SHALL BE CURED IN ACCORDANCE WITH ACI 318. CURING COMPOUNDS SHALL BE APPLIED THE SAME DAY THE CONCRETE IS POURED, ONCE THE CONCRETE HARDENS, AND AS WEATHER CONDITIONS MAY DICTATE. FOLLOW MANUFACTURER'S RECOMMENDATIONS WHEN APPLYING CURING COMPOUNDS.

NEW SLAB NOTE:  
PROVIDE NEW 6" THICK CONCRETE SLAB W/ DBL. LAYER 6X6 - W1.4 X W1.4 WELDED WIRE FABRIC OVER 6 MIL VAPOR BARRIER OVER COMPACTED SOIL. PROVIDE 8" WIDE X 12" DEEP THICKENED EDGE @ PERIMETER OF SLAB, W/ 1-#5 CONT. BAR. (PROVIDE DESITY TESTS FOR APPROVAL) PROVIDE SAW CUT JOINTS @ 15' O.C. MAX  
SEE STRUCTURAL NOTES THIS SHEET

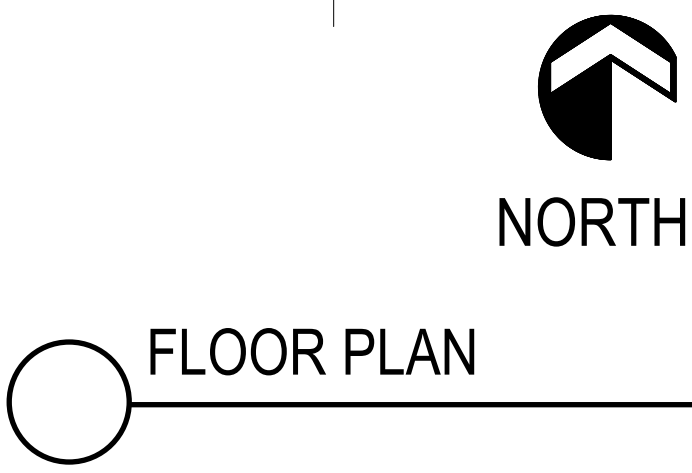

1/4"= 1'-0"

1100 SOUTH FEDERAL HWY SUITE #2  
BOYNTON BEACH, FLORIDA 33435  
888.686.5565

HAROLD TUTTLE  
AR #0015395

**ANNE MARIES RESTAURANT**  
2403 STATE ROAD #7  
MARGATE, FLORIDA

REVISIONS	DATE

Contract	
Permit	
Bid	
Date	4/1/14
Scale	AS NOTED
Drawn	HT
Job	2013-123
Sheet	A2.01
Of	X/X
Sheets	

©2014 HAROLD TUTTLE