





[illegible]

 **STONER & ASSOCIATES, Inc.**  
**SURVEYORS - MAPPERS**  
Florida Licensed Surveying  
and Mapping Business No. 06033  
4341 S.W. 62nd AVENUE, TOWN OF DAVIE, FLORIDA 33314  
TEL (954) 585-0997  
www.stonersurveyors.com



1051

DATE: Jun 20, 2017 - 12:11pm EST  
FILE: F:\Draw\CPZ Architects\17-8548 David Park Marqate\01-Drawing\17-8548.dwg



















CONSULTANT:

100

---



DRAWING TITLE:

---

---

1. CONTRACTOR TO FIELD VERIFY EXISTING CONDITIONS, WHETHER SHOWN

ANDREW C. HAYES, JR.

---

---



CONSULTANT:

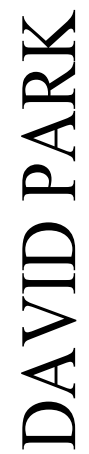

6199 NW 10TH ST.  
MARGATE, FL 33063

CPZ ARCHITECTS, INC.

4316 WEST BROWARD BOULEVARD  
PLANTATION, FLORIDA 33317  
PHONE: (954) 792-8525 FAX: (954) 337-0359  
A #26000685 WWW.CPZARCHITECTS.COM



DRAWN	
CHECKED	CR
DATE	06.23.11
SCALE	AS NOTED
PROJECT NO. 1559A	
SHEET:	

# C3.00

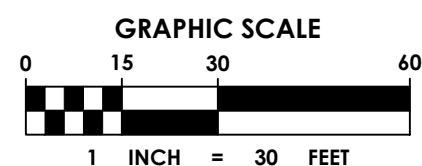

1. MINIMUM FINISHED FLOOR ELEVATION +11.32' N.A.D. ACTUAL BUILDING ELEVATIONS WILL BE DETERMINED AND SUBMITTED FOR PERMITS PRIOR TO CONSTRUCTION.
2. ALL SIDEWALKS SHALL MEET ALL A.D.A. REQUIREMENTS (5% MAX. LONGITUDINAL SLOPE AND 2% MAX. TRANSVERSE SLOPE).
3. ALL INLETS SHALL BE TYPE "C" AND MANHOLES SHALL BE TYPE "P-7" AND, ALL H-20 RATED, UNLESS OTHERWISE NOTED ON PLAN.
4. CONCRETE PIPE FOR STORM SEWERS SHALL CONFORM TO ASTM 176-79, TABLE III, WALL B, OR LATEST EDITION. ALL RCP SHALL HAVE MODIFIED TONGUE AND GROOVE JOINTS, AND HAVE RUBBER GASKETS, UNLESS OTHERWISE SPECIFIED.
5. BEDDING AND INITIAL BACKFILL OVER DRAINAGE PIPE SHALL BE SAND WITH NO ROCK LARGER THAN 1" DIAMETER.
6. ALL MATERIAL UNDER PAVED AREAS SHALL BE COMPACTED TO 98% OF THE MAXIMUM DENSITY AS DETERMINED BY AASHTO T-180.
7. BACKFILL MATERIAL UNDER AREAS NOT TO BE PAVED SHALL BE COMPACTED TO 95% OF THE MAXIMUM DENSITY AS DETERMINED BY AASHTO T-180.
8. ALL EXISTING UTILITIES SHALL BE REPAIRED PRIOR TO ENGINEER'S ACCEPTANCE.
9. CONTRACTOR TO PROVIDE DETAILLED AS-BUILTS SURVEYS THAT CLEARLY DEFINE THE AREAS OF WORK COMPLETED UNDER THIS CONTRACT INCLUDING BUT NOT LIMITED TO ALL RIM ELEVATIONS (EXISTING AND PROPOSED STRUCTURES), ALL INVERTS, BOTTOM OF STRUCTURE, SUFFICIENT SNALE ELEVATIONS TO DETERMINE GRADE, ALL EXISTING AND PROPOSED DRIVEWAYS, LOCATION OF EXFILTRATION TRENCH, LOCATION OF DRIVEWAY RESTORATION, AND RESTORED ASPHALT PAVEMENT.

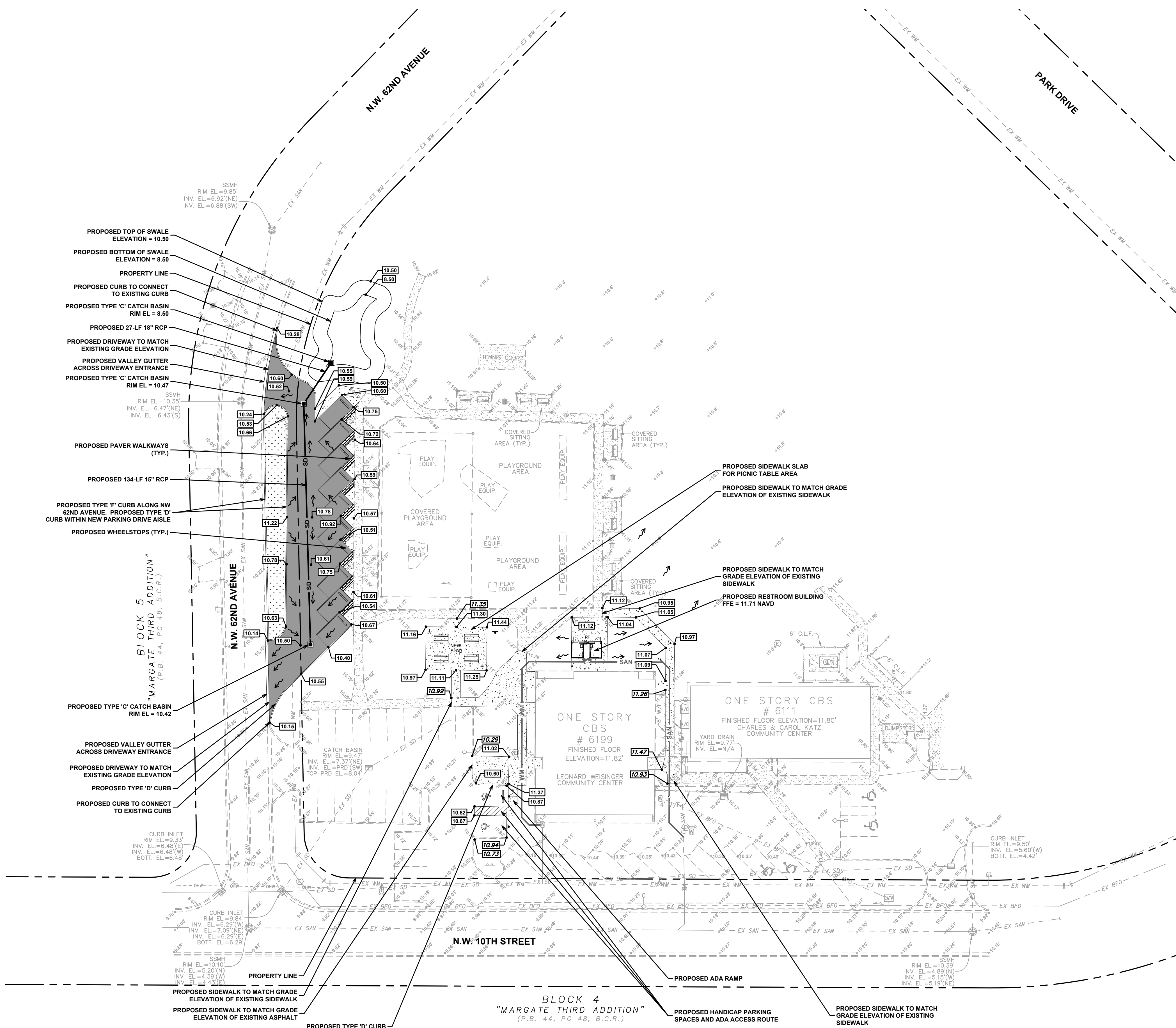

**ANDREW SAVAGE P.E.**  
 LICENSE NO. 82408  
 STATE OF FLORIDA

DATE: 06.23.17

## 100% DRC SUBMITTAL



CONSULTANT:

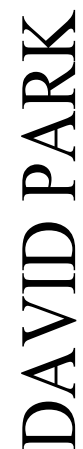

6199 NW 10TH ST.  
MARGATE, FL 33063

CPZ ARCHITECTS, INC.

4316 WEST BROWARD BOULEVARD  
PLANTATION, FLORIDA 33317  
PHONE: (954) 792-8525 FAX: (954) 337-0359  
A #26000685 WWW.CPZARCHITECTS.COM









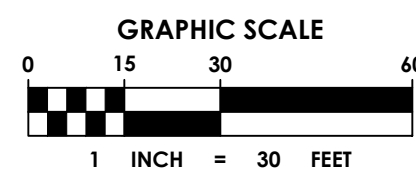





## UTILITY PLAN

SHEET:

# C4.00



## LEGEND

 **WM**  **PROPOSED WATER MAIN**  
 **S**  **PROPOSED WATER METER**  
 **S**  **PROPOSED WATER METER**  
 **S**  **PROPOSED SERVICE LATERAL**  
 **S**  **PROPOSED BACKFLOW PREVENTER**  
 **SAN**  **PROPOSED SANITARY SEWER MAIN**  
 **EX WM**  **EXISTING WATER MAIN**  
 **EX SAN**  **EXISTING SANITARY SEWER MAIN**

**WATER AND SEWER NOTES:**

1. CONTRACTOR SHALL PLAN ALL UTILITY CROSSINGS TO CONFORM HORIZONTAL AND VERTICAL SEPARATIONS PRIOR TO CONSTRUCTION.
2. WATER & SEWER LINES SHALL BE LAID WITH A MINIMUM 36" (FOOT) LATERAL SEPARATION FROM ALL OTHER STRUCTURES (E.T.C.) AND A MINIMUM TEN (10) FOOT CLEARANCE FROM TREES. FIRE HYDRANTS SHALL HAVE A 7.5' CLEARANCE OF ANY OBSTRUCTIONS.
3. ALL EXISTING WATER, GROUND DRAINAGE & SEWER LINES UNLESS OTHERWISE SPECIFIED ON PLAN, 10' MINIMUM HORIZONTAL CLEARANCE IS REQUIRED BETWEEN WATER MAIN AND FORCE MAIN.
4. CONTRACTOR SHALL REMOVE FIRE HYDRANTS THAT ARE TO BE REMOVED SHALL REMAIN ACTIVE UNTIL A CLEARANCE LETTER HAS BEEN ISSUED AND THE NEW WATER MAINS AND FIRE HYDRANTS ARE ACTIVATED.
5. CONTRACTOR SHALL CONDUCT SURVEYS THAT CLEARLY DEFINE THE AREAS OF WORK COMPLETED UNDER THIS CONTRACT INCLUDING BUT NOT LIMITED TO PIPE, PIPE ELEVATION, TOP OF ALL FITTINGS, ETC.
6. EXISTING SEWER LINES SHALL BE REPAIRED WITH EPOXY LINING IF GROUND COVER IS LESS THAN 2 FEET, OTHERWISE THE SEWER LATERAL WILL BE SDR 26 PVC.

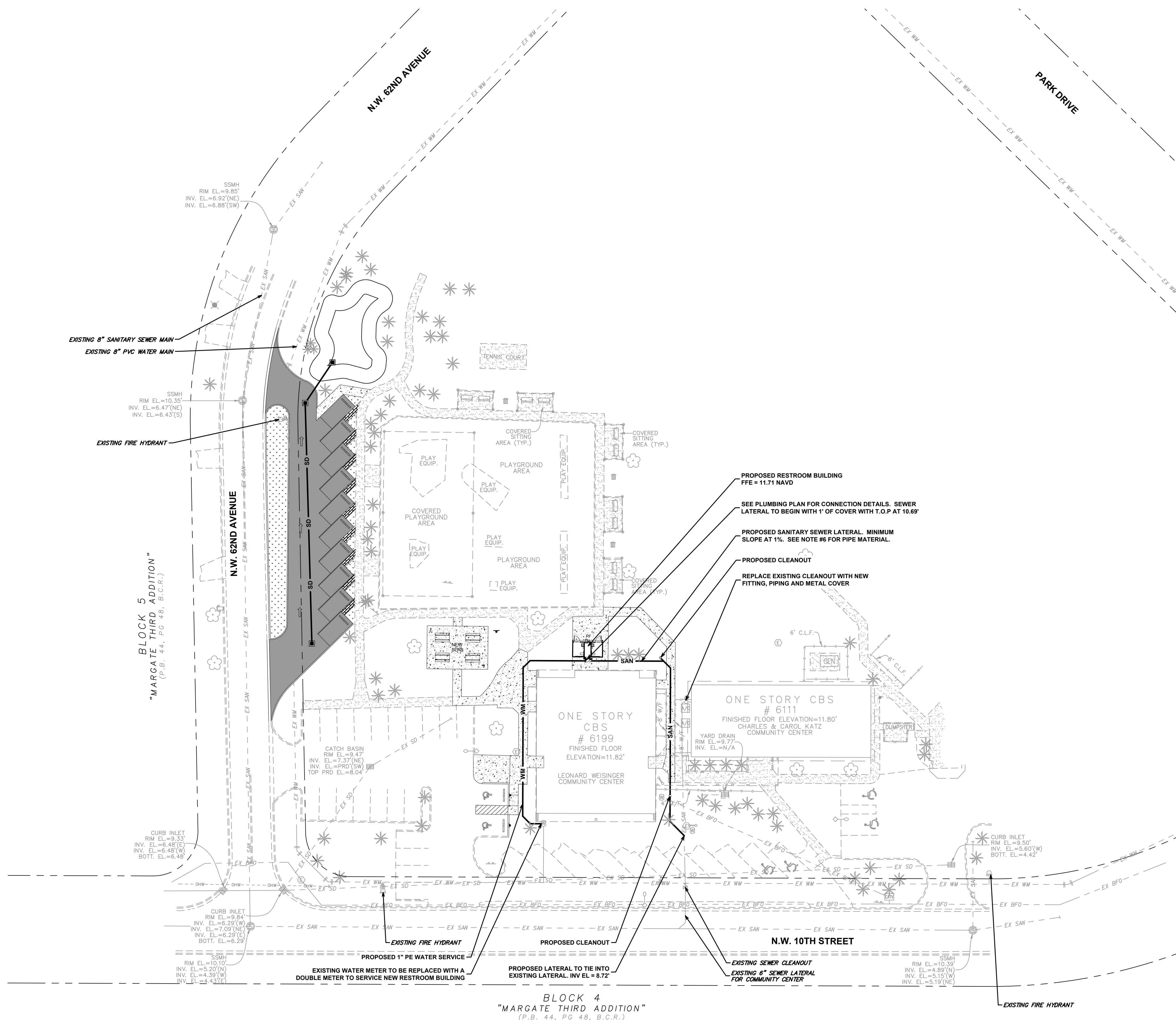

NOT FOR CONSTRUCTION

**ANDREW SAVAGE P.E.**  
 LICENSE NO. 82408  
 STATE OF FLORIDA

DATE: 06.23.17

## 100% DRC SUBMITTAL



1. SANITARY SEWERS AND FORCE MAINS SHOULD CROSS UNDER WATER MAINS WHENEVER POSSIBLE. SANITARY SEWERS AND FORCE MAINS CROSSING WATER MAINS SHALL BE LAID TO PROVIDE A MINIMUM VERTICAL DISTANCE OF 18 INCHES BETWEEN THE INVERT OF THE UPPER PIPE AND THE CROWN OF THE LOWER PIPE WHENEVER POSSIBLE.
2. WHERE SANITARY SEWERS OR FORCE MAINS MUST CROSS A WATER MAIN WITH LESS THAN 18 INCHES VERTICAL DISTANCE, BOTH THE SEWER AND THE WATER MAIN SHALL BE CONSTRUCTED OF DUCTILE IRON PIPE (D.I.P.) AT THE CROSSING. SUFFICIENT LENGTHS OF D.I.P. MUST BE USED TO PROVIDE A MINIMUM SEPARATION OF 10 FEET BETWEEN TWO JOINTS. ALL JOINTS ON THE WATER MAIN WITHIN 20 FEET OF THE CROSSING MUST BE MECHANICALLY RESTRAINED. A MINIMUM VERTICAL CLEARANCE OF 6 INCHES MUST BE MAINTAINED AT ALL CROSSING.
3. ALL CROSSINGS SHALL BE ARRANGED SO THAT THE SEWER PIPE JOINTS AND THE WATER MAIN PIPE JOINTS ARE EQUIDISTANT FROM THE POINT OF CROSSING (PIPES CENTERED ON CROSSING).
4. WHERE A NEW PIPE CONFLICTS WITH AN EXISTING PIPE WITH LESS THAN 18 INCHES VERTICAL CLEARANCE, THE NEW PIPE SHALL BE ARRANGED TO MEET THE CROSSING REQUIREMENTS ABOVE.
5. A MINIMUM 10 FOOT HORIZONTAL SEPARATION SHALL BE MAINTAINED BETWEEN ANY TYPE OF SEWER AND WATER MAIN PARALLEL INSTALLATIONS WHENEVER POSSIBLE.
6. IN CASES WHERE IT IS NOT POSSIBLE TO MAINTAIN A 10 FOOT HORIZONTAL SEPARATION, THE WATER MAIN MUST BE LAID IN A SEPARATE TRENCH OR ON AN UNDISTURBED EARTH SHELF LOCATED ON ONE SIDE OF THE SEWER OR FORCE MAIN AT SUCH AN ELEVATION THAT THE BOTTOM OF THE WATER MAIN IS AT LEAST 18 INCHES ABOVE THE TOP OF THE SEWER.
7. WHERE IT IS NOT POSSIBLE TO MAINTAIN A VERTICAL DISTANCE OF 18 INCHES IN PARALLEL INSTALLATIONS, THE WATER MAIN SHALL BE CONSTRUCTED OF D.I.P. AND THE SANITARY SEWER OR THE FORCE MAIN SHALL BE CONSTRUCTED OF D.I.P. WITH A MINIMUM VERTICAL DISTANCE OF 6 INCHES. THE WATER MAIN SHOULD ALWAYS BE ABOVE THE SEWER. JOINTS ON THE WATER SHALL BE LOCATED AS FAR APART AS POSSIBLE FROM JOINTS ON THE SEWER OR FORCE MAIN (STAGGERED JOINTS).
8. ALL D.I.P. SHALL BE CLASS 50 OR HIGHER, ADEQUATE PROTECTIVE MEASURES AGAINST CORROSION SHALL BE USED AS DETERMINED BY THE DESIGN.

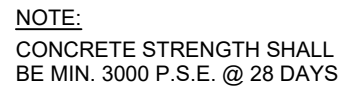
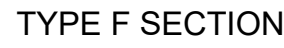
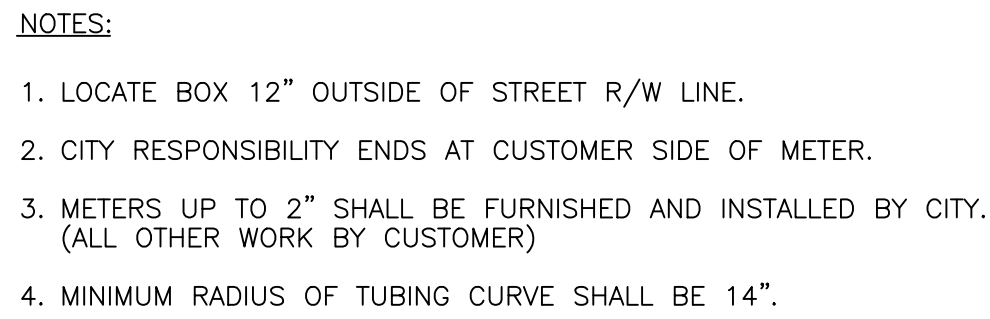
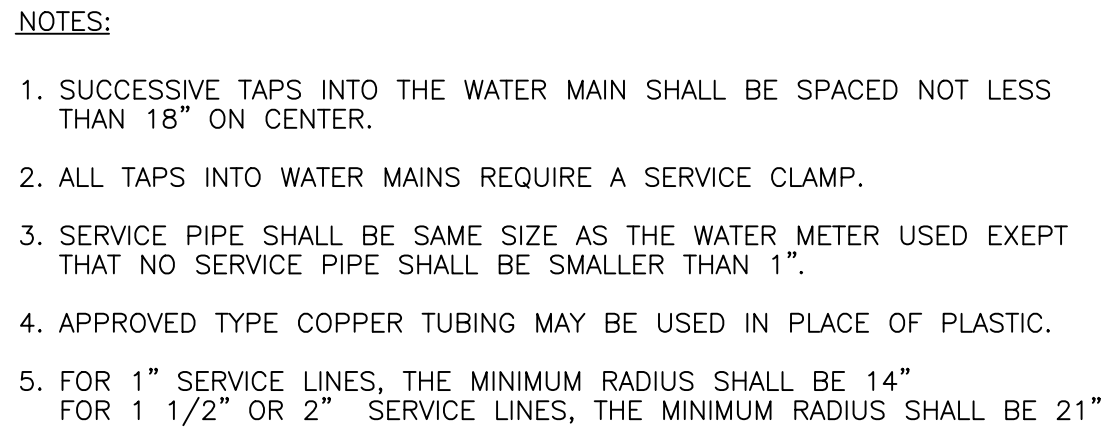

N.T.S. CITY OF MARGATE

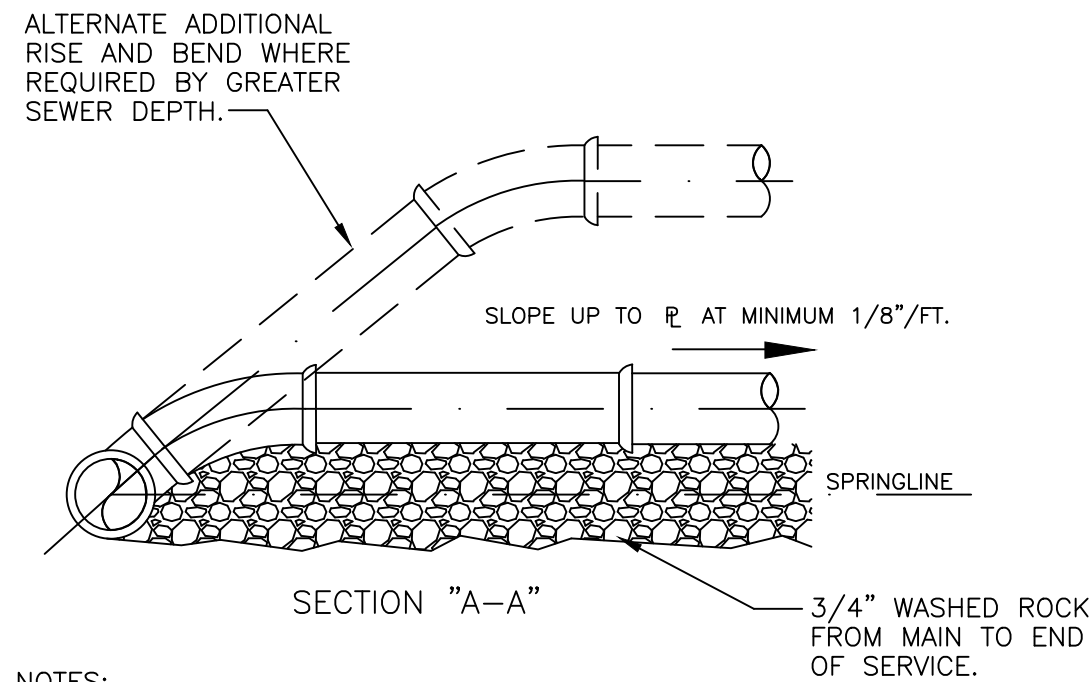

- NOTES:
1. SINGLE SERVICE CONNECTIONS SHALL USE 6" PIPE AND FITTINGS.
  2. DOUBLE SERVICE CONNECTIONS SHALL USE 6" PIPE AND FITTINGS.
  3. USE RISER CONNECTION WHEN INV. OF SEWER IS MORE THAN 7'-0" DEEP.

N.T.S. CITY OF MARGATE

N.T.S. CITY OF MARGATE

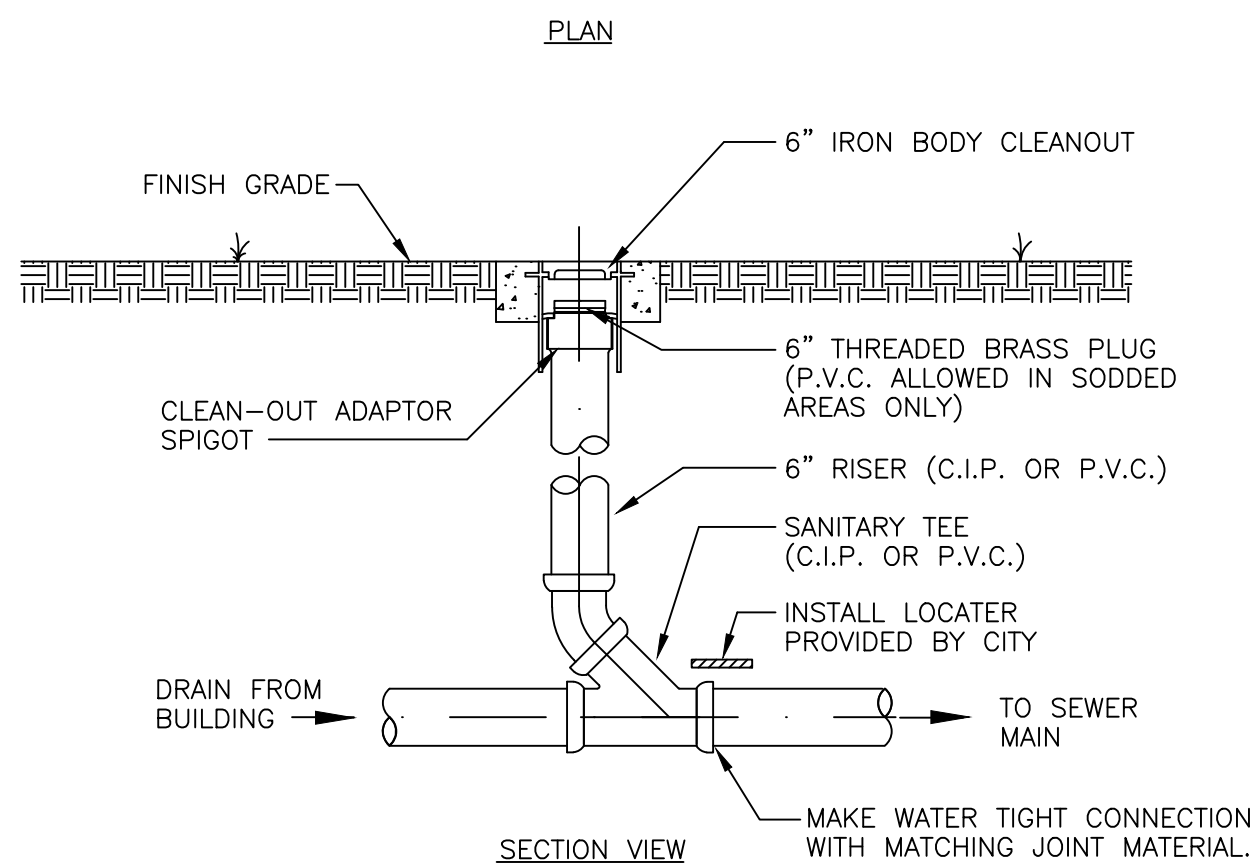

N.T.S. CITY OF MARGATE

N.T.S. CITY OF MARGATE



N.T.S. CITY OF MARGATE

N.T.S. CITY OF MARGATE

## CONSULTANT:

**&ASSOCIATES**

6199 NW 10TH ST.  
MARGATE FL 33063

4316 WEST BROWARD BOULEVARD  
PLANTATION, FLORIDA 33317  
PHONE: (954) 792-8525 FAX: (954) 337-0359  
AA #26000685 WWW.CPZARCHITECTS.COM

DRAWING TITLE:

AWN	
ECKED	CP
TE	06.23.17
SALE	AS NOTED
JECT NO.	1559A
REET:	

NOT FOR CONSTRUCTION

**ANDREW SAVAGE P.E.**  
 LICENSE NO. 82408  
 STATE OF FLORIDA

DATE: 06.23.17

**C5.00**



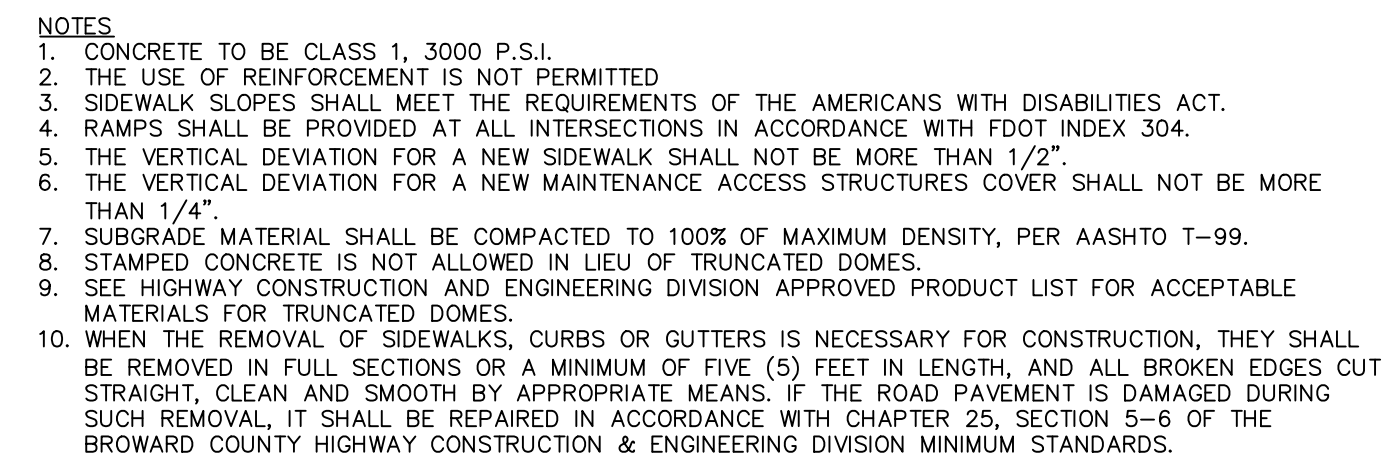
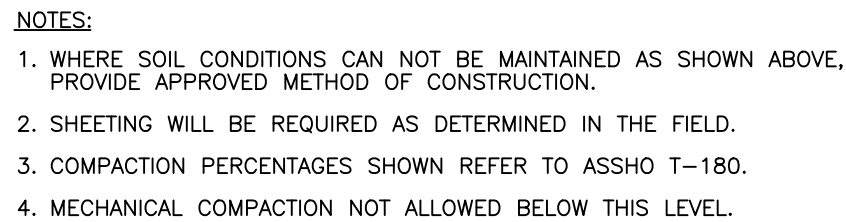
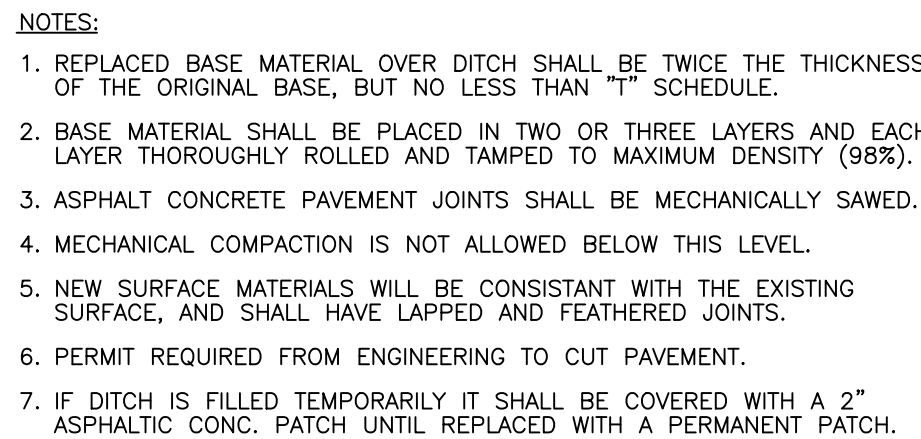

N.T.S. CITY OF MARGATE

(2) N.T.S. CITY OF MARGATE

3 N.T.S. CITY OF MARGATE

4 N.T.S.

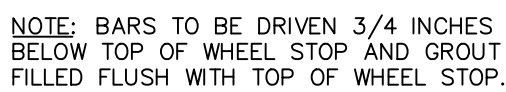
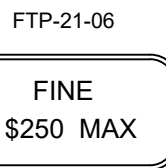
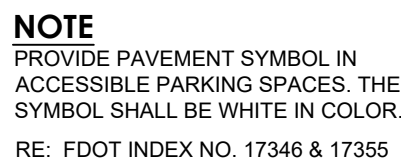

5) N.T.S.

N.T.S.

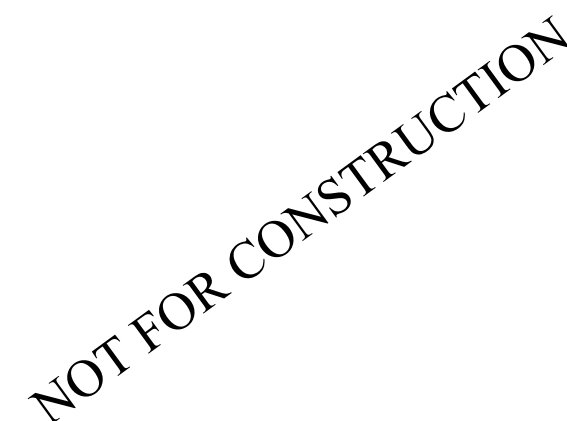

**ANDREW SAVAGE P.E.**  
 LICENSE NO. 82408  
 STATE OF FLORIDA

DATE: 06.23.17

[illegible]

CONSULTANT:



**CHEN • MOORE**  
& ASSOCIATES

DAVID PARK

6199 NW 10TH ST.  
MARGATE, FL 33063

CPZ ARCHITECTS, INC.

4316 WEST BROWARD BOULEVARD  
PLANTATION, FLORIDA 33317  
PHONE: (954) 792-8525 FAX: (954) 337-0359  
AA #2600685 WWW.CPZARCHITECTS.COM



DRAWING TITLE:

## CIVIL DETAILS

DRAWN	
CHECKED	CP
DATE	06.23.11
SCALE	AS NOTED
PROJECT NO.	1559A
SHEET:	

# C5.01

## 100% DRC SUBMITTAL



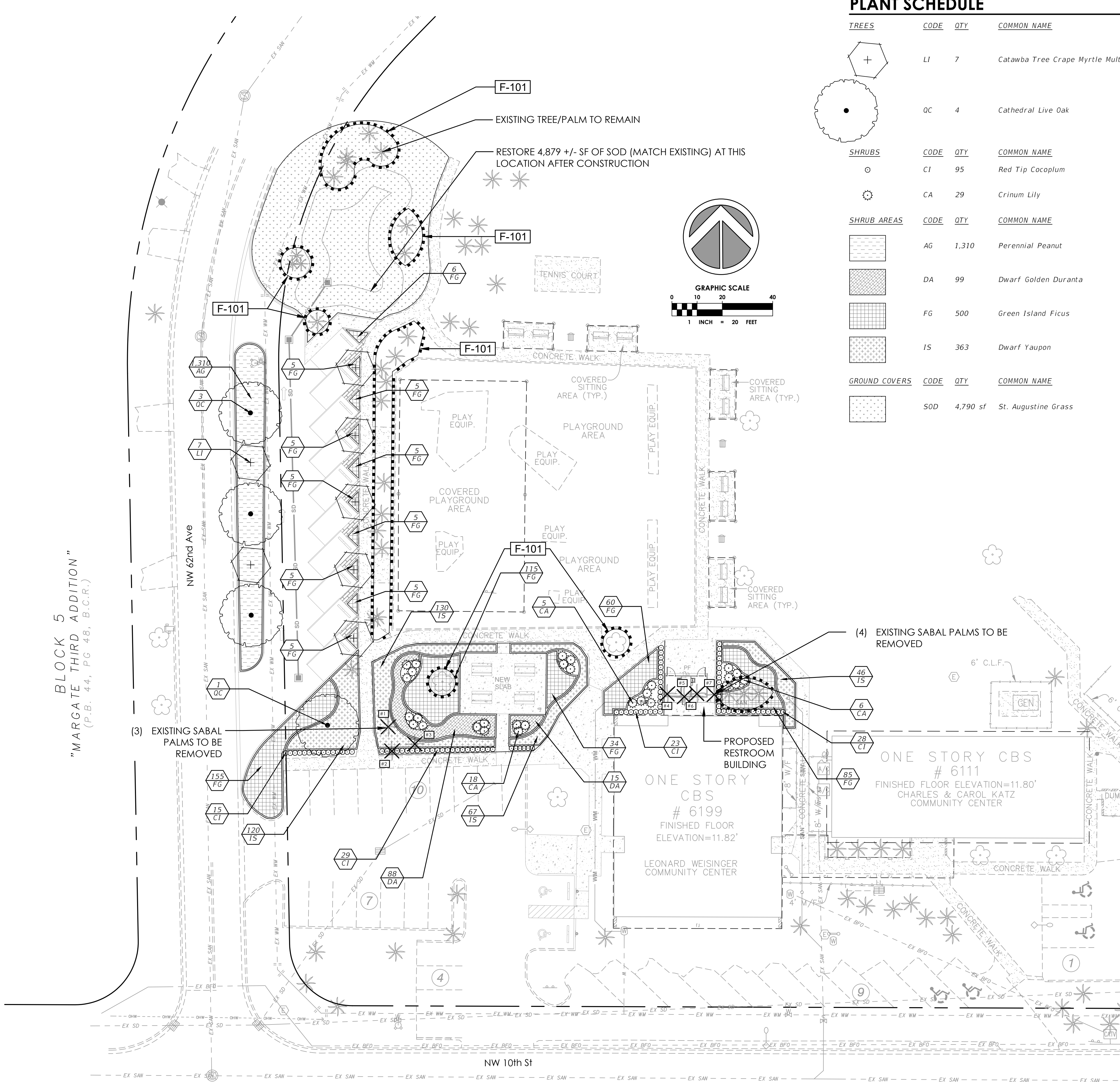

PLANT SCHEDULE

TREES	CODE	QTY	COMMON NAME	BOTANICAL NAME	CONT	SIZE	NATIVE	REMARKS	
	LI	7	Catawba Tree Crape Myrtle Multi-Trunk	Lagerstroemia indica 'Catawba'	FG	5-6' OAH	No	Multi-Stem, Matched	
	QC	4	Cathedral Live Oak	Quercus virginiana 'Cathedral'	FG	18'-20' OAH., 8-10' SPR., 5" CAL.	Yes	Category 1 Mitigation Tree	
SHRUBS	CODE	QTY	COMMON NAME	BOTANICAL NAME	CONT	SIZE	NATIVE	SPACING	REMARKS
	CI	95	Red Tip Cocoplum	Chrysobalanus icaco 'Red Tip'	3 gal	24" HT, 24" SPRD	Yes	24" o.c.	
	CA	29	Crinum Lily	Crinum augustum	10 gal	3' HT, 3' SPRD	No	48" o.c.	
SHRUB AREAS	CODE	QTY	COMMON NAME	BOTANICAL NAME	CONT	SIZE	NATIVE	SPACING	REMARKS
	AG	1,310	Perennial Peanut	Arachis glabrata	See Size	6"x6"	No	12" o.c.	
	DA	99	Dwarf Golden Duranta	Duranta repens aurea	3 gal	18" HT, 18" SPRD	No	24" o.c.	
	FG	500	Green Island Ficus	Ficus microcarpa 'Green Island'	See Size	18"x18"	No	24" o.c.	
	IS	363	Dwarf Yaupon	Ilex vomitoria 'Stokes Dwarf'	3 gal	12" HT, 12" SPRD	Yes	24" o.c.	
GROUND COVERS	CODE	QTY	COMMON NAME	BOTANICAL NAME	CONT	SIZE	NATIVE	REMARKS	
	SOD	4,790 sf	St. Augustine Grass	Stenotaphrum secundatum	Sod				

PLANT DISPOSITION CHART/CALC'S

Tree Number	Botanical / Common Name	Trunk Diameter (in)	Canopy Spread (ft)	Overall Height (ft)	Clear Trunk (ft)	Condition Rating (%)	Disposition	Specimen Tree	Tree Canopy Replacement (SF)	Tree Appraised Value (Specimen Only)
1	Sabal Palmetto - Cabbage Palm	14			18	100	Remove			
2	Sabal Palmetto - Cabbage Palm	12			16	100	Remove			
3	Sabal Palmetto - Cabbage Palm	11			14	100	Remove			
4	Sabal Palmetto - Cabbage Palm	14			18	100	Remove			
5	Sabal Palmetto - Cabbage Palm	12			16	100	Remove			
6	Sabal Palmetto - Cabbage Palm	11			14	100	Remove			
7	Sabal Palmetto - Cabbage Palm	11			14	100	Remove			
		85		= SF REMOVED						
SEC.23-20 TREE REMOVAL (NON-SPECIMEN TREES)										
CITY OF MARGATE, FL										
TOTAL SF OF NON-SPECIMEN TREE CANOPY PROPOSED FOR REMOVAL										
				37						
CATEGORY TREE	CREDIT (SF)	PROPOSED CANOPY PROVIDED		TOTAL (SF) REMOVED						
CATEGORY 1	300	300		85		-1 CAT. 1 TREE PROVIDED ON PLAN				
CATEGORY 2	150	0		0						
CATEGORY 3	100	0		0						
CATEGORY 4	50	0		0						
TOTAL NON- SPECIMEN CANOPY REPLACEMENT REQUIRED (SF)										
				85						
TOTAL CANOPY REPLACEMENT PROVIDED (SF)										
				300						
NET DIFFERENCE										
				215						
GENERAL NOTES: TREE REPLACEMENT REQUIREMENTS										
*CATEGORY 1 MIN 12' OAH 2" DBH										
*CATEGORY 2 MIN 8' OAH										
*CATEGORY 3 MIN. 6' OAH										
*CATEGORY 4 REPLACEMENT PALM TREES, MIN 6' CT/OR GW										

REFERENCE NOTES SCHEDULE

SYMBOL	FENCE DESCRIPTION	QTY	DETAIL
F-101	TREE PRESERVATION FENCING	607 lf	

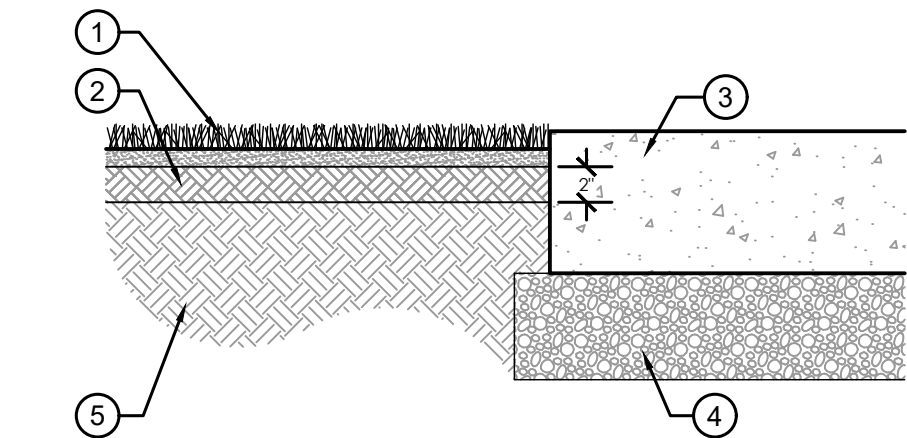

1 SOD PLANTING  
1 1/2" = 1'-0"

100% DRC SUBMITTAL

ERIC HARRISON, R.L.A.  
LICENSE NO. 6667129  
STATE OF FLORIDA

DATE: 08.28.17

NO.	REVISION	DATE
001	SUBMITTAL	08-28-17

CONSULTANT:  
**CHEN-MOORE**  
& ASSOCIATES

DAVID PARK  
6199 NW 10TH ST.  
MARGATE, FL 33063

CPZ ARCHITECTS, INC.  
4316 WEST BROADWAY BOULEVARD  
PLANTATION, FLORIDA 33317  
TEL: 954.337.0550  
FAX: 954.337.0550  
WWW.CPZARCHITECTS.COM



DRAWING TITLE:

LANDSCAPE PLAN

DRAWN  
CHECKED CP  
DATE 06.23.17  
SCALE AS NOTED  
PROJECT NO. 1559A  
SHEET:

L1.00















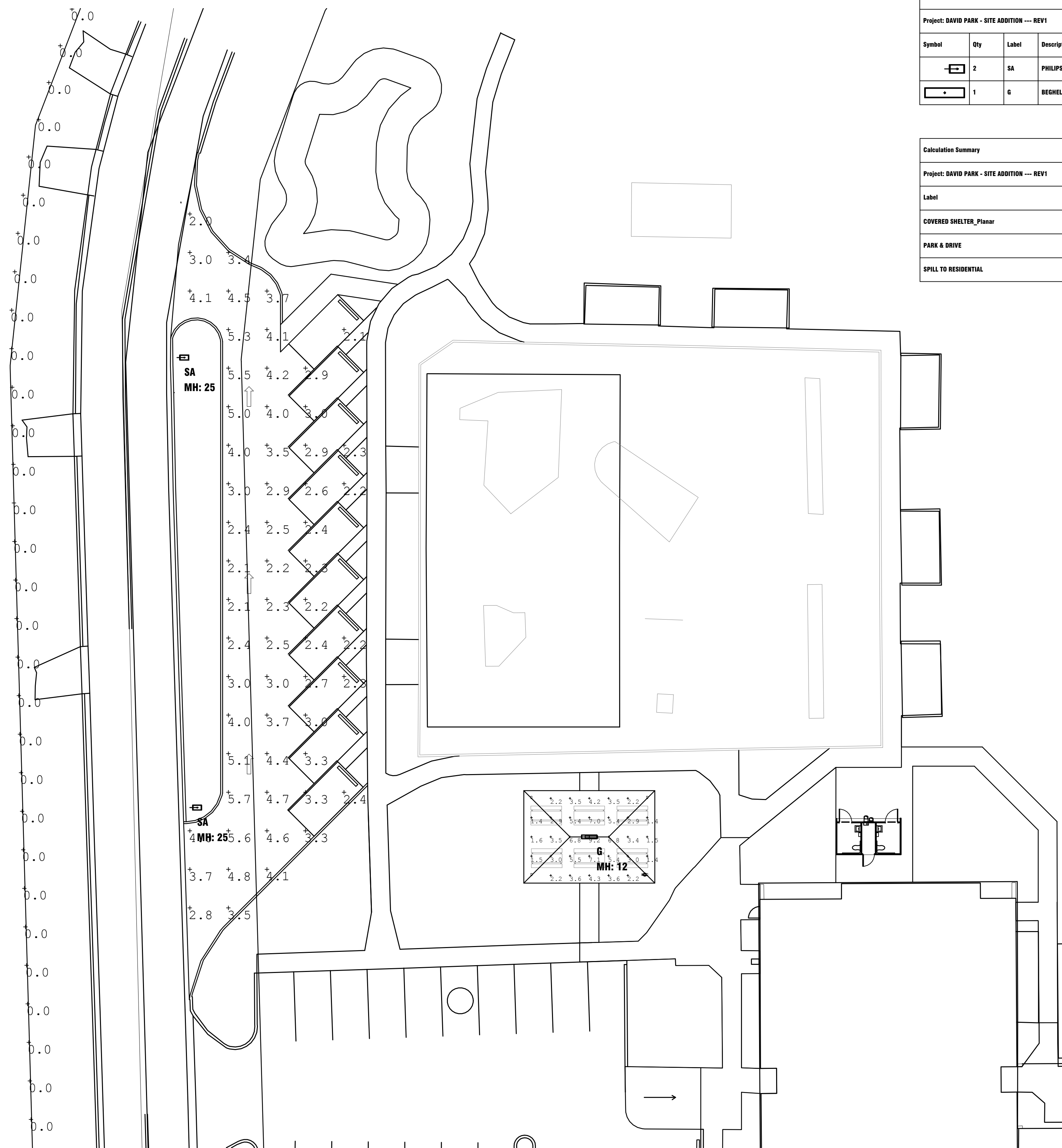

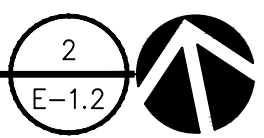

ELECTRICAL PHOTOMETRICS  
SCALE: 1/16"=1'-0"



Luminaire Schedule								
Project: DAVID PARK - SITE ADDITION --- REV1								
Symbol	Qty	Label	Description	LLD	LDD	LLF	Lum. Watts	Total Watts
	2	SA	PHILIPS GARDCO ECF-I-9BL-1A-NW-62-3-HIS POLE MOUNT 25' A.F.G.	0.900	0.900	0.810	313.6667	627.3334
	1	G	BEGHELLI BS100 LED - PARKING GARAGE BS100LEDPGHT00WWT35 AT SURFACE 12FT AFG	1.000	1.000	0.850	67.848	67.848

Calculation Summary					
Project: DAVID PARK - SITE ADDITION --- REV1					
Label	Avg	Max	Min	Avg/Min	Max/Min
COVERED SHELTER_Planar	3.79	8.2	1.4	2.71	6.57
PARK & DRIVE	3.34	5.7	2.0	1.87	2.85
SPILL TO RESIDENTIAL	0.00	0.0	0.0	N.A.	N.A.

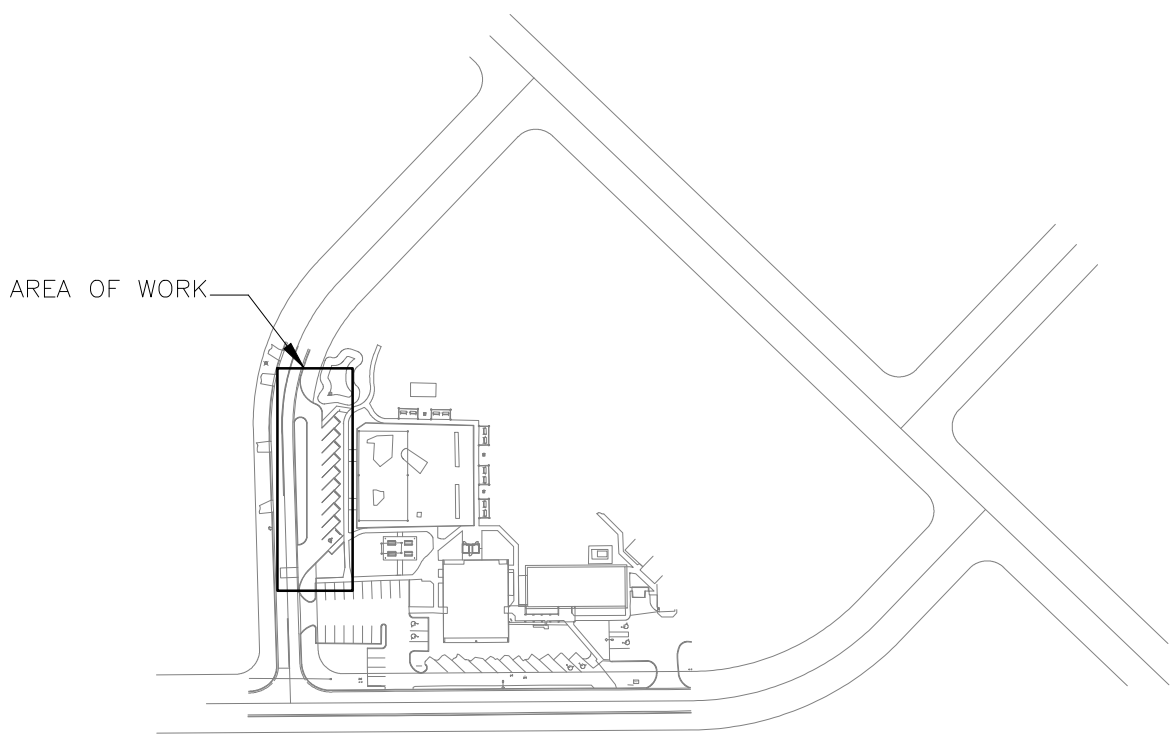

KEY PLAN  
SCALE: N.T.S.

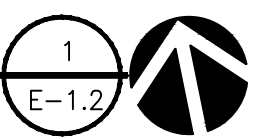

NO.	REVISION	DATE
DRC	SUBMITTAL	08.28.17

CONSULTANT:

**OSBORN**  
ENGINEERING  
1945 E. SUMMIT BLVD. SUITE 100 FORT LAUDERDALE, FL 33304  
(954) 707-8888  
www.osborn-eng.com

*project* **CAINE**  
an Osborn Engineering company

DAVID PARK  
6199 NW 10TH ST.  
MARGATE, FL 33063

CPZ ARCHITECTS, INC.  
614 WEST BROWARD BOULEVARD  
SUITE 200  
FORT LAUDERDALE, FL 33304  
PHONE: (954) 790-8825 FAX: (954) 337-0359  
AA 026000685 WWW.CPZARCHITECTS.COM

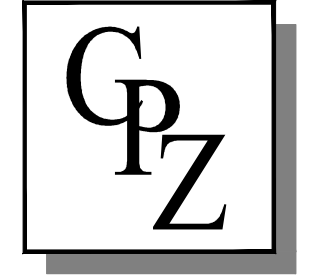

DRAWING TITLE:	
ELECTRICAL PHOTOMETRICS	
DRAWN	
CHECKED	CP
DATE	08.28.17
SCALE	AS NOTED
PROJECT NO.	1559A
SHEET:	

E-1.2





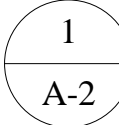

CONSULTANT:

SCALE:  $1/8" = 1'-0"$

**ROOF COLOR: ROMAN BLUE**

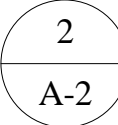

SCALE: 1/4" = 1'-0"



STATE OF FLORIDA  
CHRISTOPHER P. ZIMMERMANN  
— \* —  
REGISTERED ARCHITECT  
AR 10995

DATE: 08/28/17

**CPZ ARCHITECT**  
4316 WEST BROWARD BOULEVARD  
PLANTATION, FLORIDA 33317  
PHONE: (954) 792-8525 FAX: (954) 337-0359  
A.A.#7600685 WWW.CPZARCHITECTS.COM

**DRAWING TITLE:**

SHEET:

A-2

ZICPZ Architects 2015 Project Files\1559A Margate David Park\02 Design Development\00 Progress Model\1559A David Park- DD.rvt  
8/22/2017 9:45:54 AM