

**REVISED**  
**BEST AND FINAL OFFER PRICE SHEET**

**RFP NO. 2019-008 PARK IMPROVEMENTS – SOUTHGATE PARK**

The below items are **MANADATORY** and numbered as per original RFP Proposal Form, please complete all line items.

1. Updated RFP 2019-008 Proposal Form (Revised Item Specifications)

- A. Remove/Replace Existing Playground  
(Price Line A using the following  
Manufacturer's for shade covering and  
turf. Also see specifications on lighting.)

\$ 402,299.00

**Shade Canopy** – Shade Systems Inc.

**Turf** – ForeverLawn Playground Extreme  
Playground Grass with zero infill.

**Lighting** – Four (4) LED lights with automatic  
light controls to include diming capabilities.

2. Additional Line Items

- G. Concrete curbing to border sides of walking  
path. (Curb height level with walking path)

\$ 27,384.00

- H. Remove all 4 FT high fencing. Replace with  
4 FT high black vinyl 11 gauge interior  
chain-link fence material with top and  
bottom rails.

\$ 29,425.00

- I. Outdoor Fitness Equipment:  
Six (6) station fitness equipment along  
walking path. Open to all major  
manufacturers.

\$ 47,969.00

- J. Remove and replace existing basketball  
posts and goals with:  
Jay Pro Sports: 4 ½" Diameter Gooseneck  
Post – 4" offset/43" Rectangular Acrylic  
Backboard (ACRB-72M), Double Rim Goal  
(GDR-54), Item #996-AC-DR

\$ 7,209.00

K. Provide and install five (5) Park Benches  
(Along walking path) with:  
Pride Enterprises: Plastic Contour Bench/  
Size: 6'/Color: Cedar Plank, Black Frame  
Powdered Coated/In-ground mount.

\$ 4,864.00

L. Provide and install outdoor chilled drinking  
fountain with bottle filler to be located  
between the basketball courts and  
playground. Open to all major  
manufacturers.

\$ 12,102.00

M. Permit Fees Allowance

\$ 40,000.00

(Allowance shall be a direct pass through for  
permit fee costs only. Documentation of permit  
fees will be required for approval.)

The below items are **NON-MANADATORY** and you are not required to provide an  
alternative product. However, the City will give consideration to alternate products  
proposed in lieu of the shade canopy and turf specified in 1A.

**Shade Canopy** - LSI Shade

Alternate manufacturer for shade canopy that  
covers 100% of playground area. Please  
provide specification sheet and warranty  
information for alternate canopy.

\$ +/- -3,000.00  
(+plus or -minus  
Line A Proposal  
Form)

**Turf**

Playground Safety Surface (GRASS)  
with ASTM safety standards and no  
infill. Please provide specification sheet and  
warranty information for alternate turf.

\$ +/- N/A  
(+plus or -minus  
Line A Proposal  
Form)

Company Name: DW Recreation Services, Inc.

Proposer's Name: Donald West

Proposer's Signature: [Signature]

Date: 7/5/19



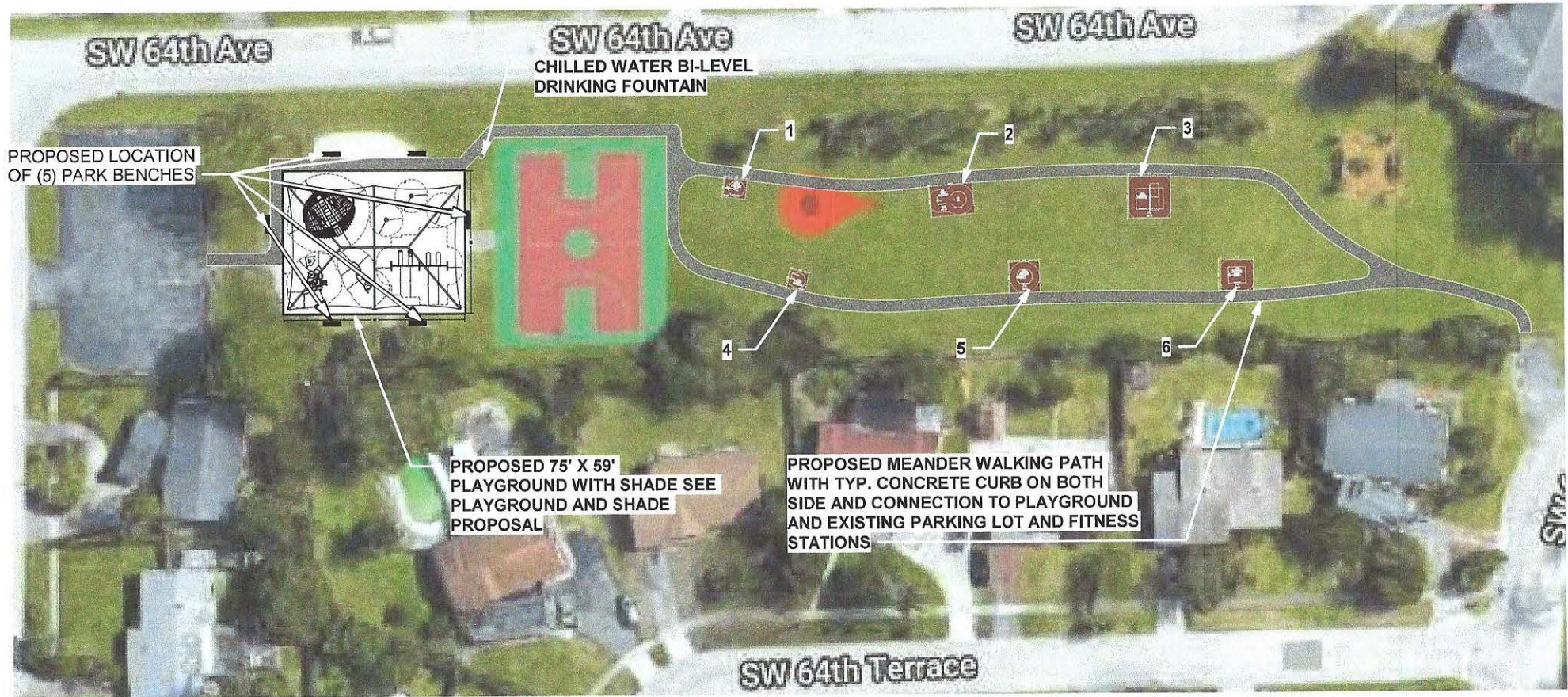

**ADDITIONAL KEY NOTES:**

- ALL 4' HIGH CHAIN-LINK FENCE AND ASSOCIATED ITEMS TO INSTALL A NEW 4' HIGH CHAIN-LINK FENCE.
- BASKETBALL GOAL POSTS, BACK BOARDS AND ALL ASSOCIATED ITEMS TO BE REMOVE AND REPLACED WITH NEW
- ALL FITNESS STAQTIONS (6) TO HAVE A TYP. CURB AND MULCH AROUND THEM



**WEST ARCHITECTURE + DESIGN, LLC**

MATTHEW F. WEST  
AR 93859

820 N. 4TH STREET, LANTANA,  
FLORIDA, 33462

T 561-588-2027 F 561-582-9419

www.west-arch.com

DESIGN BUILD FOR: CITY OF MARGATE  
SOUTHGATE PARK

SW 64th AVE, MARGATE, FL 33068

**CONCEPTUAL SITE PLAN**

PROJECT # A19 - 042  
DATE: 07-03-19  
DRAWN: DA  
MANAGED: PG

**.AS-0.00**

Scale 1" = 40'-0"



7/3/2019 4:24:48 PM



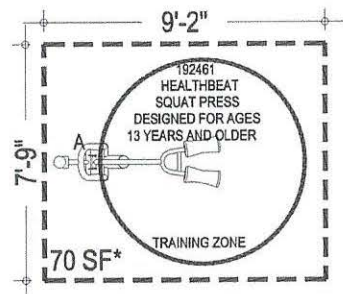

FITNESS STATION # 1

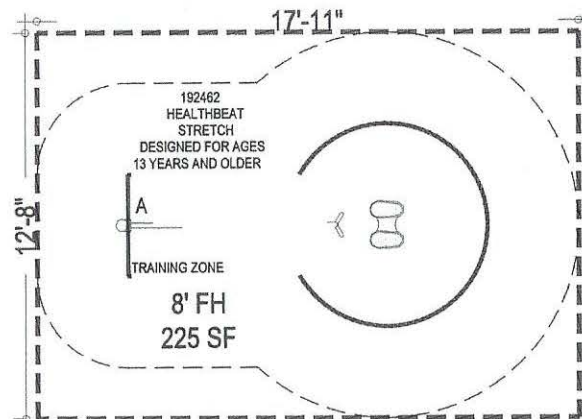

FITNESS STATION # 2

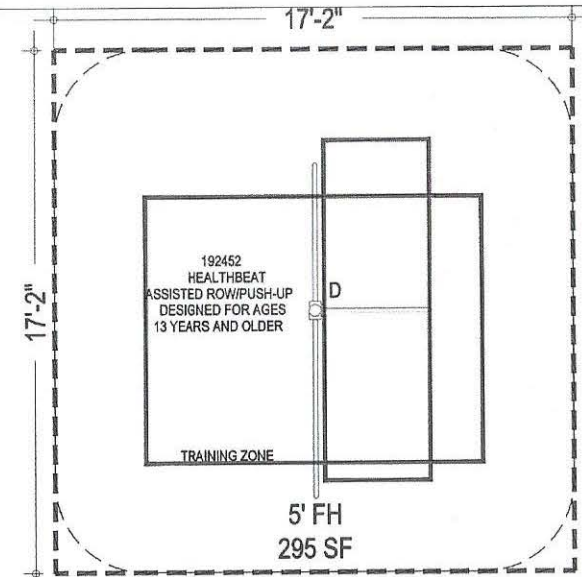

FITNESS STATION # 3

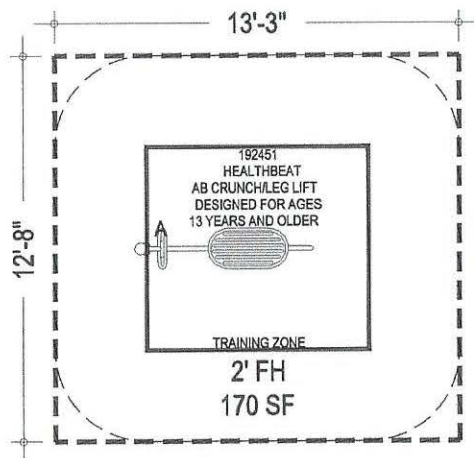

FITNESS STATION # 4

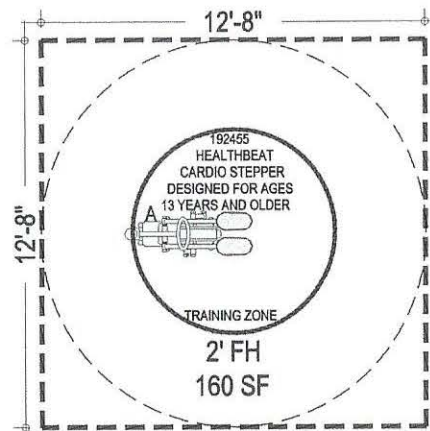

FITNESS STATION # 5

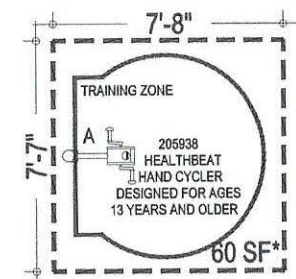

FITNESS STATION # 6

WEST ARCHITECTURE + DESIGN, LLC

MATTHEW F. WEST  
AR 93859

820 N. 4TH STREET, LANTANA,  
FLORIDA, 33462

T 561-588-2027 F 561-582-9419

www.west-arch.com

DESIGN BUILD FOR: CITY OF MARGATE  
SOUTHGATE PARK

SW 64th AVE, MARGATE, FL 33068

PROPOSED FITNESS STATIONS

PROJECT # A19 - 042  
DATE: 07-03-19  
DRAWN: DA  
MANAGED: PG

.AS-0.01

Scale 1/4" = 1'-0"



## City of Margate- Southgate Park

HB peacock July 3, 2019 16672-2-1 HB

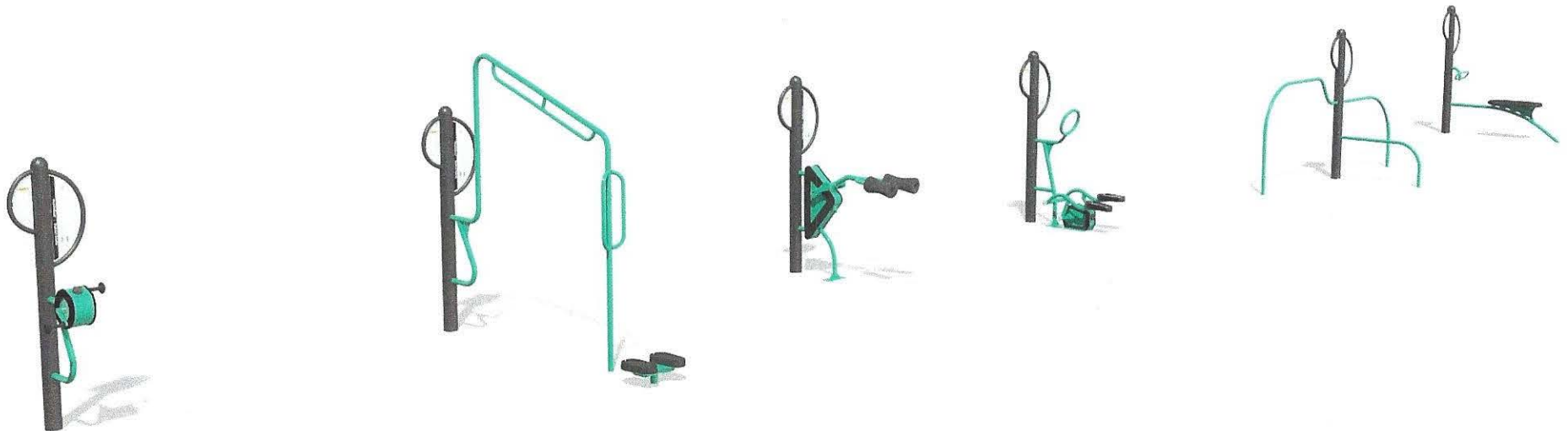

*landscape*  
structures



FOR A BETTER TOMORROW  
**WE PLAY TODAY**

[shapedbyplay.com](http://shapedbyplay.com)

Proudly presented by:

Debbie Levine



**REP SERVICES, INC.**  
Experts at Play & Outdoor Spaces



## 996 OUTDOOR BASKETBALL GOOSE NECK

ALUMINUM FAN / STEEL RECT / ACRYLIC / PERFORATED STEEL AND ALUMINUM  
DIRECT MOUNT 4 FOOT EXTENSION

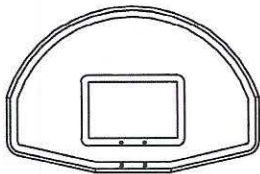

ALB-24BT  
(RED BORDER & TARGET)  
\* NO REAR BRACING REQUIRED

Rugged all galvanized steel 4 1/2 diameter post with direct mount welded to goose neck for durability and stability. Easy to install and virtually maintenance free. See selection chart for backboard and goal combinations.

\*Actual dimensions may vary depending on choice of backboard used.

### Boards:

ALB-24BT - Fan Aluminum  
850RB-BB - Rectangular Steel  
SR-PERF - Steel Perforated  
AL-PERF - Aluminum Perforated  
ACRB-72M - Acrylic Board

### Goals:

GBSG-50 - Super Goal  
UBG-500 - Ultimate Playground  
GB-55FL - Competitor Side Court Flex

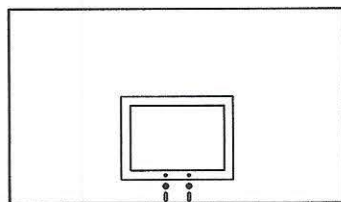

850RB-BB  
RECTANGULAR STEEL  
REAR BRACING INCLUDED

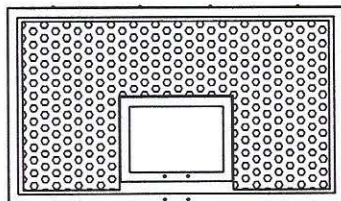

SR-PERF / AL-PERF  
ALUMINUM OR STEEL PERFORATED BOARD  
REAR BRACING INCLUDED

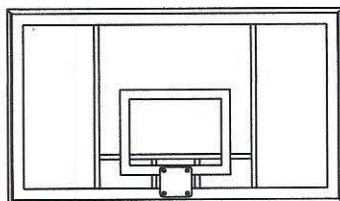

ACRB-72M  
ACRYLIC BOARD

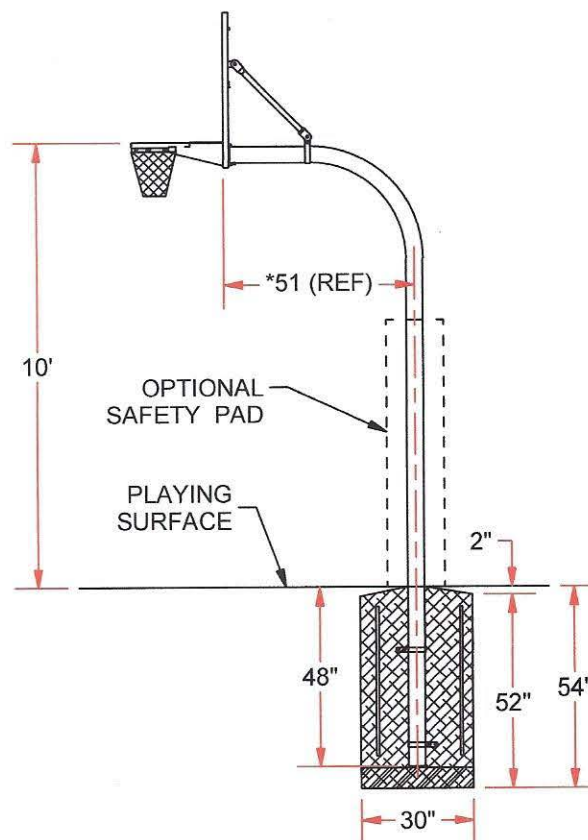

## 996

OUTDOOR BASKETBALL GOOSE NECK

© COPYRIGHT 2016 JAYPRO SPORTS, LLC. ALL RIGHTS RESERVED  
THIS PRINT IS THE PROPERTY OF JAYPRO SPORTS, LLC. AND MAY  
NOT BE REPRODUCED WITHOUT WRITTEN PERMISSION

www.jaypro.com  
(800) 243-0533  
976 Hartford Turnpike  
Waterford, CT 06385 USA

Sheet 1 of 1



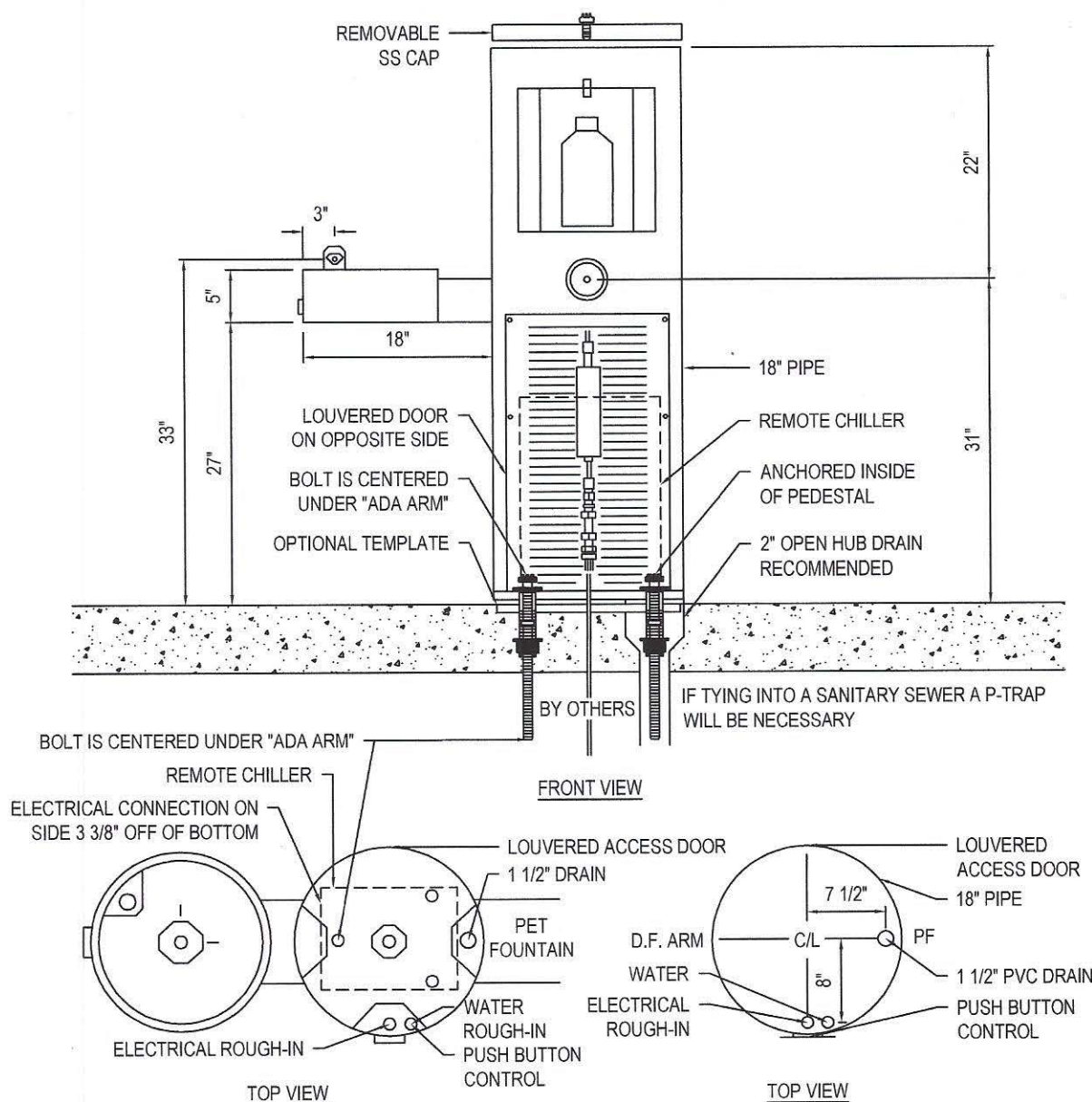

NOTES:

1. INSTALLATION TO BE COMPLETED IN ACCORDANCE WITH MANUFACTURER'S SPECIFICATIONS.
2. NOTE TO ARCHITECT, SCALE DRAWING IN AUTOCAD MODEL SPACE.
3. THIS DRAWING IS INTENDED FOR USE BY ARCHITECTS, ENGINEERS, CONTRACTORS, CONSULTANTS AND DESIGN PROFESSIONALS FOR PLANNING PURPOSES ONLY. THIS DRAWING MAY NOT BE USED FOR CONSTRUCTION.
4. ALL INFORMATION CONTAINED HEREIN WAS CURRENT AT THE TIME OF DEVELOPMENT BUT MUST BE REVIEWED AND APPROVED BY THE PRODUCT MANUFACTURER TO BE CONSIDERED ACCURATE.
5. CONTRACTOR'S NOTE: FOR PRODUCT AND COMPANY INFORMATION VISIT [www.CADdetails.com/info](http://www.CADdetails.com/info) AND ENTER REFERENCE NUMBER 3354-21.12

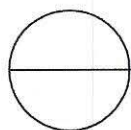

**MODEL 10135-18 SM**

SHOWN W/ REMOTE CHILLER, SHOWN W/ OPTIONAL TEMPLATE

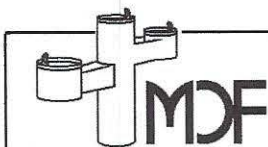

## PEDESTAL BOTTLE FILLER CHILLED SPECIFICATIONS

### WATER QUALITY (LEAD FREE)

#### ■ STANDARD PEDESTAL

OR

#### ■ STAINLESS STEEL PEDESTAL

### RECEPTOR BOWL

Section 9, California Proposition 6 and the Federal Safe Drinking Water Act.  
One piece weld construction with MDF standard 3/16" wall thickness.

One piece weld construction with MDF standard 304 schedule 10 stainless steel.

18 gauge electro-polished stainless steel bowl. Bowl overlaps pedestal, preventing buildup of residue in visual drinking area. Optional stainless steel Bowl Strainer recommended for areas with sand. Not applicable on Model 1012518 SM/SMSS.

### BOTTLE FILLER SPOUT

Sanitary recessed nozzle.

### BUBBLER HEAD

Stainless steel anti-squirt head (weighing a pound and a half) mounted with a lock nut and washer to prevent tampering. Lock nut pin holds bubbler in locked position to prevent twisting or turning. The MDF bubbler head has a unique design that features a steady stream trajectory and a built in natural shield from contamination. Not applicable on Model 1012518 SM/SMSS.

### PUSH BAR

304 stainless steel with circumference exceeding 8.6". Mushroom style push bar overlaps and prevents sand and other objects from sticking push bar in the ON position. Stainless steel bubbler housing standard.

### CONTROL VALVE

Requires less than 5 lbs to operate. Non-cartridge O-ring valve delivers steady stream of water through an adjustable valve. This valve design is to operate and function at 30 to 80 PSI. Ideal operating pressure is 60 PSI.

### WATER SUPPLY (LEAD FREE)

Maintenance free reinforced nylobraid tubing - **this tubing is not plastic**. It is supplied with a 1/2" MIP threaded inlet with stainless steel strainer. Union fittings at every connection. Supply line stops above grade. Water Filter is standard on this model.

### DRAIN

1 1/2" schedule 40 PVC pipe. Drain line stops above grade.

### FINISH

Oven baked powder coat. Choice of colors are: ☐ green, ☐ blue, ☐ black, ☐ red, ☐ yellow, ☐ orange, ☐ brown and ☐ white. Textured color choices: ☐ emerald, ☐ sapphire, ☐ pyrite, ☐ text-black, ☐ burgundy, ☐ gold vein, ☐ copper and ☐ sand-stone. Stainless steel models are powder coated for added protection. The color ☐ chrome is available for stainless steel models only.

### INSTALLATION

**Surface Mount** installation, is designed to be anchored on top of an existing surface (concrete, etc.) with anchor bolts through a mounting plate that is welded to the fountain. Surface Mount Fountains provide an access door with vandal resistant stainless steel screws. Surface mount carrier recommended for all surface mount installations. Access door standard on all pedestal fountains.

### CHILLER and WINTERIZATION

Chilling capacity 8 gallons per hour. NO lead design. 115 VAC. Shut off water and drain down. Remove water filter and chiller if applicable.

### WARRANTY

One year warranty, labor not included.

### SHIPPING WEIGHT

Model 1012518 SM.....	290 lbs	Model 1014518 SM.....	408 lbs	Model 1015518 SM.....	320 lbs
Model 1012518 SMSS...	290 lbs	Model 1014518 SMSS...	408 lbs	Model 1015518 SMSS...	320 lbs
Model 1013518 SM.....	390 lbs	Model 1015018 SM.....	380 lbs		
Model 1013518 SMSS...	390 lbs	Model 1015018 SMSS...	380 lbs		

**MOST DEPENDABLE FOUNTAINS, INC.™**  
(800) 552-6331 • (901) 867-0039 • Fax (901) 867-4008  
5705 COMMANDER DR. • ARLINGTON, TN 38002-0587  
[www.mostdependable.com](http://www.mostdependable.com)







Landscape Structures Inc. ("Manufacturer") warrants that all equipment sold will conform in kind and in quality to the specifications manual for the products identified in the Acknowledgment of Order and will be free of defects in manufacturing and material. Manufacturer further warrants:

**20-Year Limited Warranty** On all SkyWays® and CoolToppers® steel components against structural failure due to material or manufacturing defects.

**10-Year Limited Warranty** On SkyWays® and CoolToppers® fabric and thread against failure from significant fading, deterioration, breakdown, mildew, outdoor heat, cold or discoloration. This warranty is limited to the design loads as stated in the manual. Should the fabric need to be replaced under the warranty, Manufacturer will manufacture and ship a new fabric at no charge for the first 6 years, thereafter pro-rated at 18% per annum over the last 4 years. This warranty applies to standard colors only.

**3-Year Limited Warranty** On all other parts, including Rapid Release®, against failure due to corrosion/natural deterioration or manufacturing defects.

The environment near a saltwater coast can be extremely corrosive. Some corrosion and/or deterioration is considered "normal wear" in this environment. Product installed within 500 yards (457 meters) of a saltwater shoreline will only be covered for half the period of the standard product warranty, up to a maximum of five years, for defects caused by corrosion. Products installed in direct contact with saltwater or that are subjected to salt spray are not covered by the standard warranty for any defects caused by corrosion.

This warranty does not include any cosmetic issues or wear and tear from normal use of the product, or misuse or abuse of the product. It is valid only if the equipment is erected to conform with Landscape Structures' installation instructions and maintained according to the maintenance procedures furnished by Landscape Structures Inc. Maintenance is particularly critical in regions where dirt and/or sand may cause abrasion of the fabric.

This warranty is void if conditions exceed local building codes.



## 2019 SkyWays® and CoolToppers® Shade Warranty

You have our word.

All the warranties commence on date of Manufacturer's invoice. Should any failure to conform to the above express warranties appear within the applicable warranty period, Manufacturer shall, upon being notified in writing promptly after discovery of the defect and within the applicable warranty period, correct such nonconformity either by repairing any defective part or parts, or by making available a replacement part within 60 days of written notification. Manufacturer shall deliver the repaired or replacement part or parts to the site free of charge, but will not be responsible for providing labor or the cost of labor for the removal of the defective part or parts, the installation of any replacement part or parts or for disposal costs of any part or parts. Replacement parts will be warranted for the balance of the original warranty.

THIS WARRANTY IS EXCLUSIVE AND IN LIEU OF ALL OTHER WARRANTIES, WHETHER EXPRESSED OR IMPLIED, INCLUDING BUT NOT LIMITED TO ANY WARRANTY OF MERCHANTABILITY OR OF FITNESS FOR A PARTICULAR PURPOSE.

The remedies hereby provided shall be the exclusive and sole remedies of the purchaser. Manufacturer shall not be liable for any direct, indirect, special, incidental or consequential damages.

Manufacturer neither assumes nor authorizes any employee, representative or any other person to assume for Manufacturer any other liability in connection with the sale or use of the structures sold, and there are no oral agreements or warranties collateral to or affecting this agreement. The warranties stated above are valid only if the structures and/or equipment are erected in conformance with Landscape Structures' installation instructions and maintained according to the maintenance procedures furnished by Landscape Structures Inc.; have been subjected to normal use for the purpose for which the goods were designed; have not been exposed to saltwater or salt spray; have not been subject to misuse, negligence, vandalism, or accident; have not been subjected to addition or substitution of parts; and have not been modified, altered, or repaired by persons other than Manufacturer or Manufacturer's designees in any respect which, in the judgement of Manufacturer, affects the condition or operation of the structures.

To make a claim, send your written statement of claim, along with the original job number or invoice number to: Landscape Structures Inc. 601 7th Street South, Delano, Minnesota, 55328-8605.

Signed:  President Date: 01/01/2019