



Gardco EcoForm Gen-2 combines economy with performance in an LED area luminaire. Capable of delivering up to 26,400 lumens or more in a compact, low profile LED luminaire, EcoForm offers a new level of customer value. EcoForm features an innovative retrofit arm kit, simplifying site conversions to LED by eliminating the need to drill additional holes in most existing poles. Integral control systems available for further energy savings. Includes Service Tag, our innovative way to provide assistance throughout the life of the product.

Project:	
Location:	
Cat.No:	
Type:	
Lamps:	Qty:
Notes:	

Ordering guide

example: ECF-S-64L-900-NW-G2-AR-5-120-HIS-MGY

Prefix	Number of LEDs	Drive Current	LED Color - Generation	Mounting	Distribution	Voltage	Options					Finish
							Dimming controls	Motion sensing lens	Photo-sensing	Electrical	Luminaire	
ECF-S												
ECF-S	32L 32 LEDs (2 modules)	530 530 mA 700 700 mA 1A 1050 mA 1.2A 1200 mA	WW-G2 Warm White 3000K, 70 CRI Generation 2 NW-G2 Neutral White 4000K, 70 CRI Generation 2	AR Arm Mount (standard) ² The following mounting kits must be ordered separately (See accessories) SF Slip Fitter Mount ³ (fits to 2 3/8" O.D. tenon) WS Wall mount with surface conduit rear entry permitted RAM Retrofit arm mount kit ²	Type 2 2 Type 2 2-90 Rotated left 90° 2-270 Rotated right 270° Type 3 3 Type 3 3-90 Rotated left 90° 3-270 Rotated right 270° Type 4 4 Type 4 4-90 Rotated left 90° 4-270 Rotated right 270° Type 5 5 Type 5 5W Type 5W AFR Auto Front Row AFR-90 Auto Front Row, Rotated left 90° AFR-270 Auto Front Row, Rotated right 270°	120 120V 208 208V 240 240V 277 277V 347 347V 480 480V UNV 120-277V (50/60Hz) HVU 347-480V (50/60Hz)	DD 0-10V External dimming (by others) ⁴ DCC Dual Circuit Control ^{4,5,6} FAWS Field Adjustable Wattage Selector ^{4,5} SW Interface module for SiteWise ^{4,6,7} LLC Integral wireless module ^{4,6,8} BL Bi-level functionality ⁴ DynaDimmer: Automatic Profile Dimming CS50 Safety 50% Dimming, 7 hours ^{4,8} CM50 Median 50% Dimming, 8 hours ^{4,8} CE50 Economy 50% Dimming, 9 hours ^{4,8} DA50 All Night 50% Dimming ^{4,8} CS30 Safety 30% Dimming, 7 hours ^{4,8} CM30 Median 30% Dimming, 8 hours ^{4,8} CE30 Economy 30% Dimming, 9 hours ^{4,8} DA30 All Night 30% Dimming ^{4,8}	IMRI3 Integral with #3 lens ¹⁵ IMRI7 Integral with #7 lens ¹⁶ IMRO Pole mounted motion sensor ¹⁵ (see accessories)	PCB Photocontrol Button ^{8,9} TLRD5 Twist Lock Receptacle 5 Pin ¹⁰ TLRD7 Twist Lock Receptacle 7 Pin ¹⁰ TLRPC Twist Lock Receptacle w/ Photocell ^{9,11}	Fusing F1 Single (120, 277, 347VAC) ⁹ F2 Double (208, 240, 480VAC) ⁹ Pole Mount Fusing FP1 Single (120, 277, 347VAC) ⁹ FP2 Double (208, 240, 480VAC) ⁹ FP3 Canadian Double Pull (208, 240, 480VAC) ⁹ Surge Protection (10kA standard) SP2 Increased 20kA	Square Pole Adapter included in standard product TB Terminal Block ¹² RPA Round Pole Adapter (fits to 3"-3.9" O.D. pole) ¹³ HIS Internal Housing Side Shield ¹⁴	Textured BK Black WH White BZ Bronze DGY Dark Gray MGY Medium Gray Customer specified RAL Specify optional color or RAL (ex: RAL7024) CC Custom color (Must supply color chip for required factory quote)
	48L 48 LEDs (3 modules)	900 900 mA 1A 1050 mA 1.2A 1200 mA	CW-G2 Cool White 5000K, 70 CRI Generation 2									
	64L 64 LEDs (4 modules)	900 900 mA 1A 1050 mA										

- BL-IMRI3/7 equipped with out-boarded sensor housing when voltage is HVU (347-480V)
- Mounts to a 4" round pole with adapter included for square poles.
- Limited to a maximum of 45 degrees aiming above horizontal.
- Not available with other dimming control options.
- Not available with motion sensor.
- Not available with photocontrol.

- Available only in 120 or 277V.
- Not available in 347 or 480V
- Must specify input voltage.
- Dimming will not be connected to NEMA receptacle if ordering with other control options.
- Not available in 480V.
- Not available with DCC.
- Not available with SF and WS. RPAs provided with black finish standard.

- HIS not available with Type 5 and 5W optics.
- Available only with SW, LLC, and BL control options.
- Available only with SW and BL control options.

ECF-S EcoForm small

Area luminaire

EcoForm Accessories (ordered separately, field installed)

Controls Accessories

Pole Mount Motion Sensor

MS-A-120V 120V Input
MS-A-277V 277V Input

Wireless system

Remote mount module

LLCR3-(F) #3 lens

Central Remote Motion Response
(used connected to SiteWise main panel)

MS2-A-FVR-3
MS2-A-FVR-7

Shielding Accessories

House Side shield

Standard optic orientation:

HIS-80-H¹⁴ Internal House Side Shield for 80 LEDs (5 modules)
HIS-96-H¹⁴ Internal House Side Shield for 96 LEDs (6 modules)

Optic at 90 or 270 orientation:

HIS-80-V¹⁴ Internal House Side Shield for 80 LEDs (5 modules)
HIS-96-V¹⁴ Internal House Side Shield for 96 LEDs (6 modules)

14. Not available with Type 5 or 5W optics

Luminaire Accessories

ECF-BD-G2 Bird deterrent
ECF-RAM-G2-(F) Retrofit Arm mount kit
ECF-SF-G2-(F) Slip Fitter Mount (fits to 2 3/8" O.D. tenon)
ECF-WG-G2-(F) Wall mount with surface conduit rear entry permitted

EcoForm PTF2
(pole top fitter fits 23/8-21/2" OD x 4" depth tenon)

PTF2-ECF-S/L-1-90-(F) 1 luminaire at 90°
PTF2-ECF-S/L-2-90-(F) 2 luminaires at 90°
PTF2-ECF-S/L-2-180-(F) 2 luminaires at 180°
PTF2-ECF-S/L-3-90-(F) 3 luminaires at 90°
PTF2-ECF-S/L-4-90-(F) 4 luminaires at 90°
PTF2-ECF-S/L-3-120-(F) 3 luminaires at 120°

(F) = Specify finish

EcoForm PTF3
(pole top fitter fits 3-31/2" OD x 6" depth tenon)

PTF3-ECF-S/L-1-90-(F) 1 luminaire at 90°
PTF3-ECF-S/L-2-90-(F) 2 luminaires at 90°
PTF3-ECF-S/L-2-180-(F) 2 luminaires at 180°
PTF3-ECF-S/L-3-90-(F) 3 luminaires at 90°
PTF3-ECF-S/L-4-90-(F) 4 luminaires at 90°
PTF3-ECF-S/L-3-120-(F) 3 luminaires at 120°

EcoForm PTF4
(pole top fitter fits 31/2-4" OD x 6" depth tenon)

PTF4-ECF-S/L-1-90-(F) 1 luminaire at 90°
PTF4-ECF-S/L-2-90-(F) 2 luminaires at 90°
PTF4-ECF-S/L-2-180-(F) 2 luminaires at 180°
PTF4-ECF-S/L-3-90-(F) 3 luminaires at 90°
PTF4-ECF-S/L-4-90-(F) 4 luminaires at 90°
PTF4-ECF-S/L-3-120-(F) 3 luminaires at 120°

Predicted Lumen Depreciation Data

Predicted performance derived from LED manufacturer's data and engineering design estimates, based on IESNA LM-80 methodology. Actual experience may vary due to field application conditions. L₇₀ is the predicted time when LED performance depreciates to 70% of initial lumen output. Calculated per IESNA TM21-11. Published L₇₀ hours limited to 6 times actual LED test hours

Ambient Temperature °C	Driver mA	Calculated L ₇₀ Hours	L ₇₀ per TM-21	Lumen Maintenance % at 60,000 hrs
25°C	up to 1200 mA	>100,000 hours	>60,000 hours	>88%

Optical distribution

Based on configuration ECF-S-48L-1A-NW-G2 (159W) mounted at 20ft.

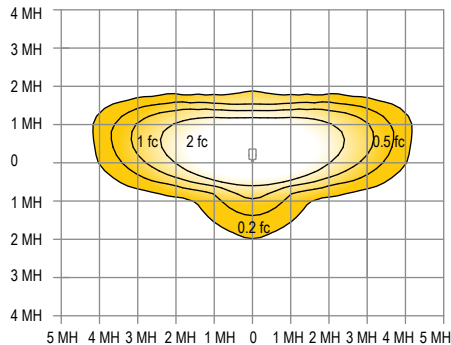

Type 2

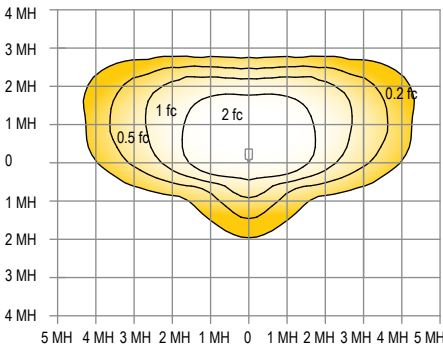

Type 3

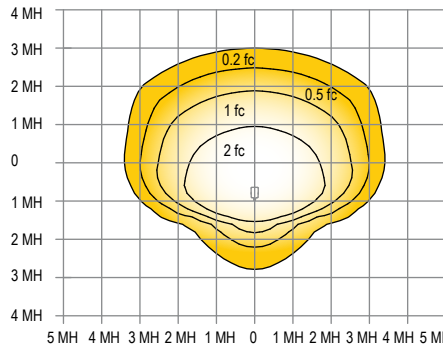

Type 4

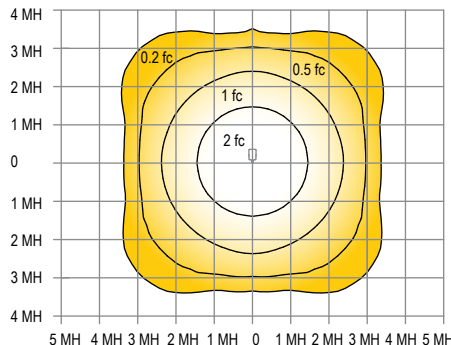

Type 5

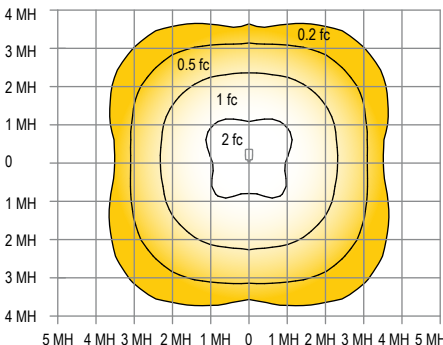

Type 5W

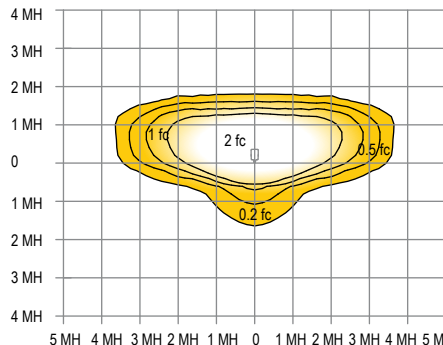

AFR

ECF-S EcoForm small

Area luminaire

3000K LED Wattage and Lumen Values

Ordering Code	Total LEDs	LED Current (mA)	Color Temp.	Average System Watts	Type 2			Type 3			Type 4		
					Lumen Output	BUG Rating	Efficacy (LPW)	Lumen Output	BUG Rating	Efficacy (LPW)	Lumen Output	BUG Rating	Efficacy (LPW)
ECF-S-32L-530-WW-G2-x	32	530	3000	56	6,178	B2-U0-G1	111	6,044	B1-U0-G2	109	6,323	B1-U0-G2	114
ECF-S-32L-700-WW-G2-x	32	700	3000	73	7,968	B2-U0-G2	109	7,795	B1-U0-G2	107	8,156	B1-U0-G2	112
ECF-S-32L-1A-WW-G2-x	32	1050	3000	106	11,218	B2-U0-G2	106	10,974	B2-U0-G2	104	11,482	B2-U0-G2	109
ECF-S-32L-1.2A-WW-G2-x	32	1200	3000	122	12,443	B3-U0-G2	102	12,173	B2-U0-G2	100	12,736	B2-U0-G3	105
ECF-S-48L-900-WW-G2-x	48	900	3000	135	14,768	B3-U0-G3	109	14,448	B2-U0-G3	107	15,116	B2-U0-G3	112
ECF-S-48L-1A-WW-G2-x	48	1050	3000	159	16,723	B3-U0-G3	105	16,360	B3-U0-G3	103	17,116	B2-U0-G3	108
ECF-S-48L-1.2A-WW-G2-x	48	1200	3000	183	18,564	B3-U0-G3	102	18,162	B3-U0-G3	99	19,001	B3-U0-G4	104
ECF-S-64L-900-WW-G2-x	64	900	3000	178	19,545	B3-U0-G3	110	19,121	B3-U0-G3	108	20,005	B3-U0-G4	113
ECF-S-64L-1A-WW-G2-x	64	1050	3000	206	22,020	B3-U0-G3	107	21,543	B3-U0-G4	105	22,538	B3-U0-G4	109

Ordering Code	Total LEDs	LED Current (mA)	Color Temp.	Average System Watts	Type 5			Type 5W			Type AFR		
					Lumen Output	BUG Rating	Efficacy (LPW)	Lumen Output	BUG Rating	Efficacy (LPW)	Lumen Output	BUG Rating	Efficacy (LPW)
ECF-S-32L-530-WW-G2-x	32	530	3000	56	6,400	B2-U0-G1	115	6,672	B3-U0-G2	120	6,458	B3-U0-G2	116
ECF-S-32L-700-WW-G2-x	32	700	3000	73	8,254	B2-U0-G1	113	8,606	B3-U0-G2	118	8,330	B4-U0-G2	114
ECF-S-32L-1A-WW-G2-x	32	1050	3000	106	11,621	B3-U0-G2	110	12,116	B4-U0-G2	115	11,727	B4-U0-G2	111
ECF-S-32L-1.2A-WW-G2-x	32	1200	3000	122	12,890	B3-U0-G2	106	13,440	B4-U0-G2	111	13,008	B4-U0-G2	107
ECF-S-48L-900-WW-G2-x	48	900	3000	135	15,299	B3-U0-G2	113	15,951	B4-U0-G2	118	15,438	B4-U0-G2	114
ECF-S-48L-1A-WW-G2-x	48	1050	3000	159	17,324	B3-U0-G2	109	18,062	B4-U0-G2	114	17,482	B5-U0-G3	110
ECF-S-48L-1.2A-WW-G2-x	48	1200	3000	183	19,231	B3-U0-G2	105	20,051	B5-U0-G3	110	19,407	B5-U0-G3	106
ECF-S-64L-900-WW-G2-x	64	900	3000	178	20,247	B3-U0-G2	114	21,111	B5-U0-G3	119	20,432	B5-U0-G3	115
ECF-S-64L-1A-WW-G2-x	64	1050	3000	206	22,811	B3-U0-G2	111	23,784	B5-U0-G3	116	23,020	B5-U0-G3	112

4000K LED Wattage and Lumen Values

Ordering Code	Total LEDs	LED Current (mA)	Color Temp.	Average System Watts	Type 2			Type 3			Type 4		
					Lumen Output	BUG Rating	Efficacy (LPW)	Lumen Output	BUG Rating	Efficacy (LPW)	Lumen Output	BUG Rating	Efficacy (LPW)
ECF-S-32L-530-NW-G2-x	32	530	4000	56	6,864	B2-U0-G2	123	6,715	B1-U0-G2	121	7,025	B1-U0-G2	126
ECF-S-32L-700-NW-G2-x	32	700	4000	73	8,853	B2-U0-G2	121	8,661	B2-U0-G2	119	9,062	B1-U0-G2	124
ECF-S-32L-1A-NW-G2-x	32	1050	4000	106	12,464	B3-U0-G2	118	12,194	B2-U0-G2	115	12,757	B2-U0-G3	121
ECF-S-32L-1.2A-NW-G2-x	32	1200	4000	122	13,826	B3-U0-G3	114	13,526	B2-U0-G3	111	14,151	B2-U0-G3	116
ECF-S-48L-900-NW-G2-x	48	900	4000	135	16,409	B3-U0-G3	121	16,053	B2-U0-G3	119	16,795	B2-U0-G3	124
ECF-S-48L-1A-NW-G2-x	48	1050	4000	159	18,581	B3-U0-G3	117	18,178	B3-U0-G3	115	19,018	B2-U0-G4	120
ECF-S-48L-1.2A-NW-G2-x	48	1200	4000	183	20,627	B3-U0-G3	113	20,180	B3-U0-G4	110	21,112	B3-U0-G4	116
ECF-S-64L-900-NW-G2-x	64	900	4000	178	21,717	B3-U0-G3	122	21,246	B3-U0-G4	119	22,228	B3-U0-G4	125
ECF-S-64L-1A-NW-G2-x	64	1050	4000	206	24,467	B3-U0-G3	119	23,936	B3-U0-G4	116	25,043	B3-U0-G4	122

Ordering Code	Total LEDs	LED Current (mA)	Color Temp.	Average System Watts	Type 5			Type 5W			Type AFR		
					Lumen Output	BUG Rating	Efficacy (LPW)	Lumen Output	BUG Rating	Efficacy (LPW)	Lumen Output	BUG Rating	Efficacy (LPW)
ECF-S-32L-530-NW-G2-x	32	530	4000	56	7,414	B3-U0-G2	133	7,175	B3-U0-G2	129	7,111	B2-U0-G1	128
ECF-S-32L-700-NW-G2-x	32	700	4000	73	9,563	B3-U0-G2	131	9,255	B4-U0-G2	127	9,172	B2-U0-G1	126
ECF-S-32L-1A-NW-G2-x	32	1050	4000	106	13,462	B4-U0-G2	127	13,030	B4-U0-G2	123	12,912	B3-U0-G2	122
ECF-S-32L-1.2A-NW-G2-x	32	1200	4000	122	14,933	B4-U0-G2	123	14,453	B4-U0-G2	119	14,322	B3-U0-G2	118
ECF-S-48L-900-NW-G2-x	48	900	4000	135	17,723	B4-U0-G2	131	17,154	B5-U0-G3	127	16,999	B3-U0-G2	126
ECF-S-48L-1A-NW-G2-x	48	1050	4000	159	20,069	B5-U0-G3	126	19,424	B5-U0-G3	122	19,248	B3-U0-G2	121
ECF-S-48L-1.2A-NW-G2-x	48	1200	4000	183	22,279	B5-U0-G3	122	21,563	B5-U0-G3	118	21,368	B3-U0-G2	117
ECF-S-64L-900-NW-G2-x	64	900	4000	178	23,456	B5-U0-G3	132	22,702	B5-U0-G3	128	22,497	B3-U0-G2	127
ECF-S-64L-1A-NW-G2-x	64	1050	4000	206	26,427	B5-U0-G3	128	25,577	B5-U0-G4	124	25,346	B3-U0-G2	123

ECF-S EcoForm small

Area luminaire

5000K LED Wattage and Lumen Values

Ordering Code	Total LEDs	LED Current (mA)	Color Temp.	Average System Watts	Type 2			Type 3			Type 4		
					Lumen Output	BUG Rating	Efficacy (LPW)	Lumen Output	BUG Rating	Efficacy (LPW)	Lumen Output	BUG Rating	Efficacy (LPW)
ECF-S-32L-530-CW-G2-x	32	530	5000	56	6,658	B2-U0-G2	120	6,514	B1-U0-G2	117	6,815	B1-U0-G2	122
ECF-S-32L-700-CW-G2-x	32	700	5000	73	8,588	B2-U0-G2	118	8,402	B2-U0-G2	115	8,790	B1-U0-G2	121
ECF-S-32L-1A-CW-G2-x	32	1050	5000	106	12,090	B3-U0-G2	114	11,828	B2-U0-G2	112	12,375	B2-U0-G3	117
ECF-S-32L-1.2A-CW-G2-x	32	1200	5000	122	13,411	B3-U0-G3	110	13,120	B2-U0-G3	108	13,726	B2-U0-G3	113
ECF-S-48L-900-CW-G2-x	48	900	5000	135	15,917	B3-U0-G3	118	15,572	B2-U0-G3	115	16,291	B2-U0-G3	121
ECF-S-48L-1A-CW-G2-x	48	1050	5000	159	18,023	B3-U0-G3	114	17,633	B3-U0-G3	111	18,447	B2-U0-G4	116
ECF-S-48L-1.2A-CW-G2-x	48	1200	5000	183	20,008	B3-U0-G3	110	19,574	B3-U0-G4	107	20,479	B3-U0-G4	112
ECF-S-64L-900-CW-G2-x	64	900	5000	178	21,065	B3-U0-G3	118	20,609	B3-U0-G4	116	21,561	B3-U0-G4	121
ECF-S-64L-1A-CW-G2-x	64	1050	5000	206	23,733	B3-U0-G3	115	23,218	B3-U0-G4	113	24,291	B3-U0-G4	118

Ordering Code	Total LEDs	LED Current (mA)	Color Temp.	Average System Watts	Type 5			Type 5W			Type AFR		
					Lumen Output	BUG Rating	Efficacy (LPW)	Lumen Output	BUG Rating	Efficacy (LPW)	Lumen Output	BUG Rating	Efficacy (LPW)
ECF-S-32L-530-CW-G2-x	32	530	5000	56	6,897	B2-U0-G1	124	7,191	B3-U0-G2	129	6,960	B3-U0-G2	125
ECF-S-32L-700-CW-G2-x	32	700	5000	73	8,896	B2-U0-G1	122	9,276	B3-U0-G2	127	8,978	B4-U0-G2	123
ECF-S-32L-1A-CW-G2-x	32	1050	5000	106	12,524	B3-U0-G2	119	13,058	B4-U0-G2	124	12,639	B4-U0-G2	120
ECF-S-32L-1.2A-CW-G2-x	32	1200	5000	122	13,893	B3-U0-G2	114	14,485	B4-U0-G2	119	14,020	B4-U0-G2	115
ECF-S-48L-900-CW-G2-x	48	900	5000	135	16,489	B3-U0-G2	122	17,192	B4-U0-G2	127	16,639	B5-U0-G3	123
ECF-S-48L-1A-CW-G2-x	48	1050	5000	159	18,671	B3-U0-G2	118	19,467	B5-U0-G3	123	18,841	B5-U0-G3	119
ECF-S-48L-1.2A-CW-G2-x	48	1200	5000	183	20,727	B3-U0-G2	113	21,611	B5-U0-G3	118	20,916	B5-U0-G3	114
ECF-S-64L-900-CW-G2-x	64	900	5000	178	21,822	B3-U0-G2	123	22,753	B5-U0-G3	128	22,021	B5-U0-G3	124
ECF-S-64L-1A-CW-G2-x	64	1050	5000	206	24,586	B3-U0-G2	119	25,634	B5-U0-G3	124	24,810	B5-U0-G4	120

ECF-S EcoForm small

Area luminaire

Dimensions

Standard Arm (AR)

Weight: 22 Lbs (9.9 Kg) EPA: 0.21ft² (.019m²)

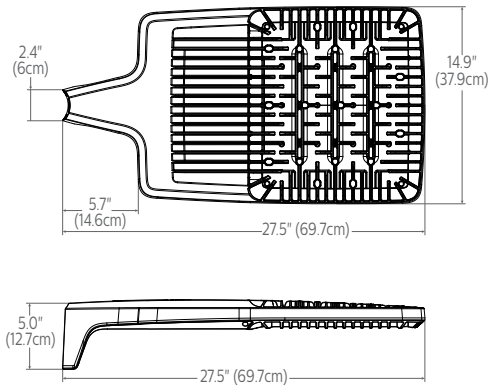

Wall (WS)

Weight: 27 Lbs. (12. 2Kg) EPA: 0.27ft² (.025m²)

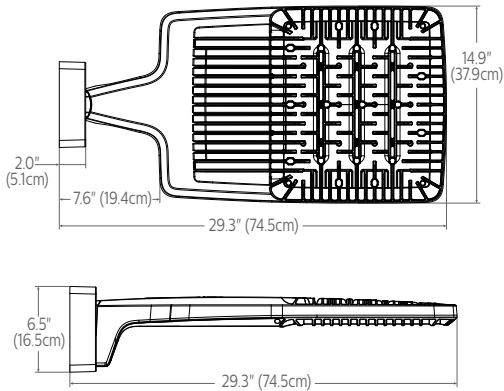

Retrofit Arm (RAM)

Weight: 24 Lbs (10.9 Kg) EPA: 0.24ft² (.022m²)

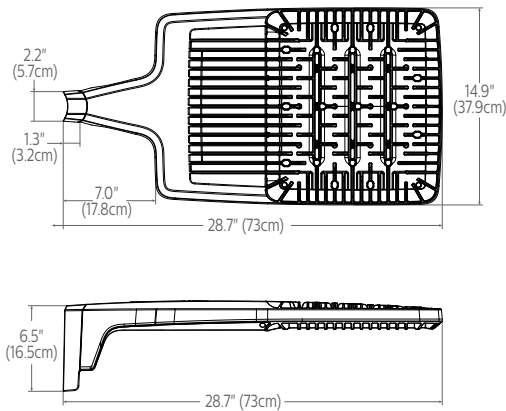

Slip fitter (SF)

Weight: 27 Lbs (12.2 Kg) EPA: 0.33ft² (.031m²)

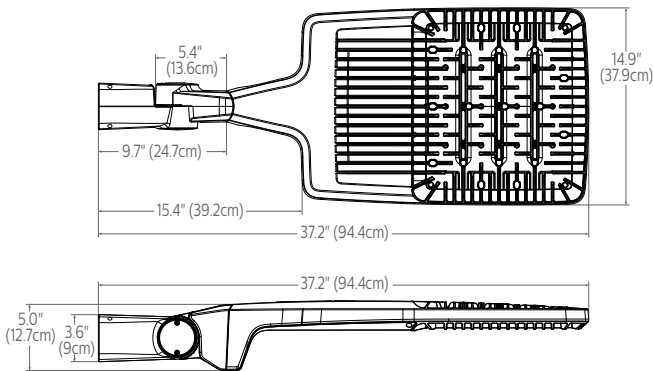

Outboard IMR-HVU sensor

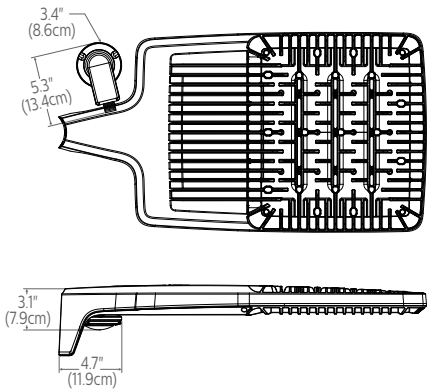

Standard Arm (AR) drill pattern

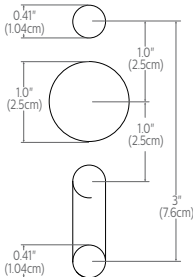

Retrofit Arm (RAM) drill pattern

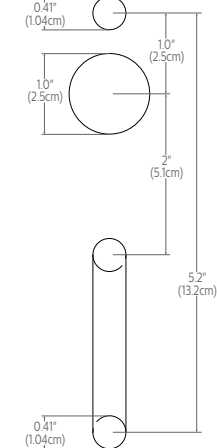

ECF-S EcoForm small

Area luminaire

Optical Orientation Information

Standard Optic Position

Luminaires ordered with asymmetric optical systems in the standard optic position will have the optical system oriented as shown below:

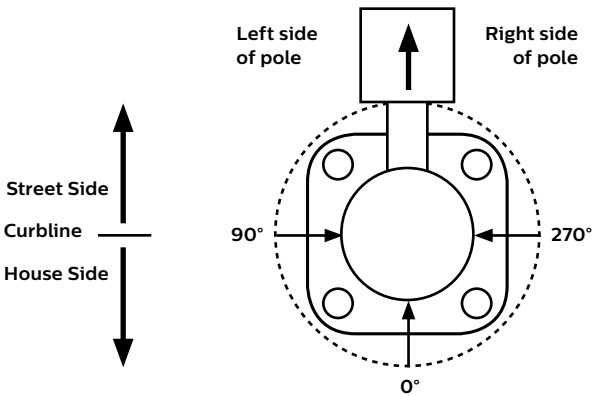

Note: The hand hole will normally be located on the pole at the 0° point.

Optic Rotated Left (90°) Optic Position

Luminaires ordered with optical systems in the Optic Rotated Left (90°) optic position will have the optical system oriented as shown below (Type 5 and 5W optics are not available with factory set rotatable optics):

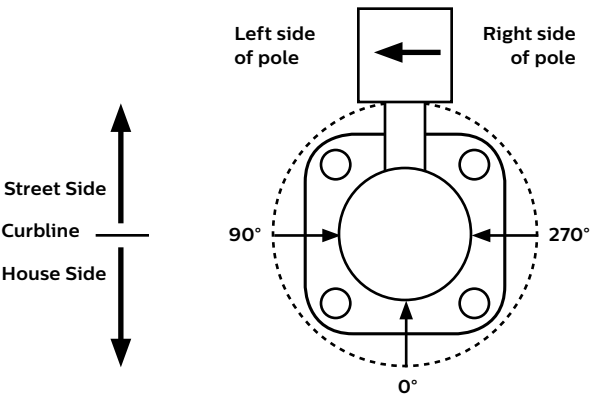

Note: The hand hole will normally be located on the pole at the 0° point.

Optic Rotated Right (270°) Optic Position

Luminaires ordered with optical systems in the Optic Rotated Right (270°) optic position will have the optical system oriented as shown below (Type 5 and 5W optics are not available with factory set rotatable optics):

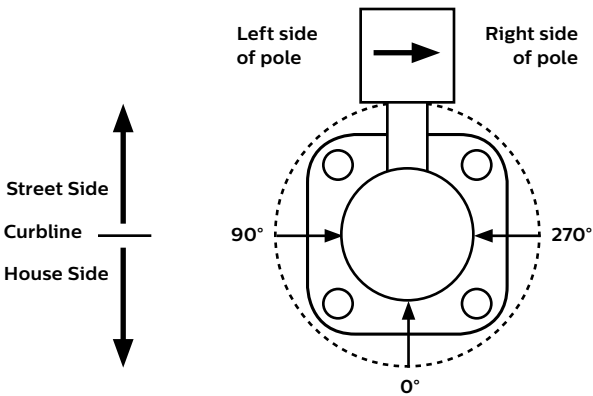

Note: The hand hole will normally be located on the pole at the 0° point.

Twin Luminaire Assemblies with Type-90/Type-270 Rotated Optical Systems

Twin luminaire assemblies installed with rotated optical systems are an excellent way to direct light toward the interior of the site (Street Side) without additional equipment. It is important, however, that care be exercised to insure that luminaires are installed in the proper location.

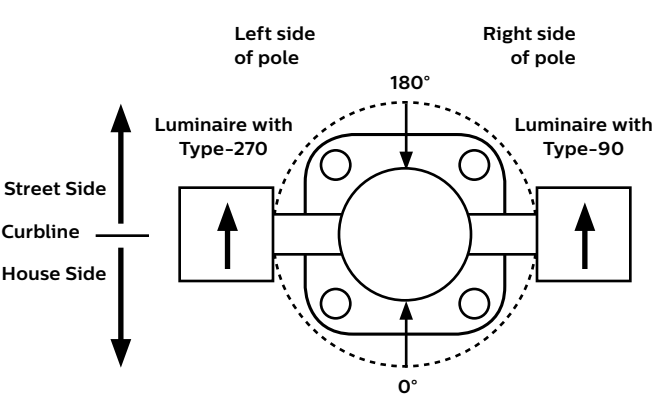

Luminaires with Optic Rotated Right (270°) are installed on the LEFT Side of Pole

Luminaires with Optic Rotated Left (90°) are installed on the RIGHT Side of Pole

Note: The hand hole location will depend on the drilling configuration ordered for the pole.

ECF-S EcoForm small

Area luminaire

Specifications

Housing

One-piece die cast aluminum housing with integral arm and separate, self-retained hinged, one-piece die cast door frame. Luminaire housing rated to IP66, tested in accordance to Section 9 of IEC 60598-1.

Vibration resistance

Luminaire is tested and rated 3G over 100,000 cycles conforming to standards set forth by ANSI C136.31-2010. Testing includes vibration in three axes, all performed on the same luminaire.

Light engine

Light engine comprises of a module of 16-LED aluminum metal clad board fully sealed with optics offered in multiples of 2, 3, and 4 modules or 32, 48, and 64 LEDs. Module is RoHS compliant. Color temperatures: 3000K +/-125K, 4000K, 5000K +/- 200K. Minimum CRI of 70. LED light engine is rated IP66 in accordance to Section 9 of IEC 60598-1.

Energy saving benefits

System efficacy up to 133 lms/W with significant energy savings over Pulse Start Metal Halide luminaires. Optional control options provide added energy savings during unoccupied periods.

Optical systems

Type 2, 3, 4, 5, 5W, and AFR distributions available. Internal Shield option mounts to LED optics and is available with Type 2, 3, 4, and AFR distributions. Types 2, 3, 4, and AFR when specified and used as rotated, are factory set only. Performance tested per LM-79 and TM-15 (IESNA) certifying its photometric performance. Luminaire designed with 0% uplight (U0 per IESNA TM-15).

Mounting

Standard luminaire arm mounts to 4" O.D. round poles. Can also be used with 5" O.D. poles. Square pole adapter included with every luminaire. Round Pole Adapter (RPA) required for 3-3.9" poles. EcoForm features a retrofit arm kit. When specified with the retrofit arm (RAM) option, EcoForm seamlessly simplifies site conversions to LED by eliminating the need for additional pole drilling on most existing poles. RAM will be boxed separately. Also optional are slipfitter and wall mounting accessories.

Control options

0-10V dimming (DD): Access to 0-10V dimming leads supplied through back of luminaire (for secondary dimming controls by others). Cannot be used with other control options.

Dual Circuit Control (DCC): Luminaire equipped with the ability to have two separate circuits controlling drivers and light engines independently. Permits separate switching of separate modules controlled by use of two sets of leads, one for each circuit. Not recommended to be used with other control options, motion response, or photocells.

SiteWise (SW): SiteWise system includes a controller fully integrated in the luminaire that enables the luminaires to communicate with a dimming signal transmitter cabinet located on site using patented central dimming technology. A locally accessible mobile app allows users to access the system and set functionalities such as ON/OFF, dimming levels and scheduling. SiteWise is available with motion response options in order to bring the light back to 100% when motion is detected. Cannot be used with other control options or photocell options. Additional functionalities are available such as communication with indoor lighting and connection to BMS systems. Complete information on the control system can be found on the SiteWise website at philips.com/sitewise.

Automatic Profile Dimming (CS/CM/CE/CA): Standard dimming profile of 30% or 50% provide flexibility towards energy savings goals while optimizing light levels during specific dark hours. When used in combination with not programmed motion response it overrides the controller's schedule when motion is detected. After 5 minutes with no motion, it will return to the automatic dimming profile schedule. Automatic dimming profile scheduled with the following settings:

- **CS50/CS30:** Security for 7 hours night duration (Ex., 11 PM – 6 AM)
- **CM50/CM30:** Median for 8 hours night duration (Ex., 10 PM – 6 AM)
- **CE50/CE30:** Economy for 9 hours night duration (Ex., 9 PM – 6 AM)
- **CA50/CA30:** for all night (during all dark hours)

All above profiles are calculated from mid point of the night. Dimming is set for 6 hours after the mid point and 1, 2, or 3 hours before depending of the duration of dimming. Cannot be used with other dimming control options.

Field Adjustable Wattage Selector (FAWS): Luminaire equipped with the ability to manually adjust the wattage in the field to reduce total luminaire lumen output and light levels. Comes pre-set to the highest position at the lumen output selected. Use chart below to estimate reduction in lumen output desired. Cannot be used with other control options or motion response.

FAWS Position	Percent of Typical Lumen Output
1	25%
2	50%
3	55%
4	65%
5	75%
6	80%
7	85%
8	90%
9	95%
10	100%

Note: Typical value accuracy +/- 5%

Wireless system (LLC): Optional wireless controller integral to luminaire ready to be connected to a Limelight system (sold by others). The system allows you to wirelessly manage the entire site, independent lighting groups or individual luminaires while on-site or remotely. Based on a high-density mesh network with an easy to use web-based portal, you can conveniently access, monitor and manage your lighting network remotely. Wireless controls can be combined with site and area, pedestrian, and parking garage luminaires as well, for a completely connected outdoor solution. Equipped with motion response with #3 lens for 8-25' mounting heights. Also available with remote pod accessory where pod is mounted separate from luminaire to pole or wall.

LLC wireless controller with #3 lens

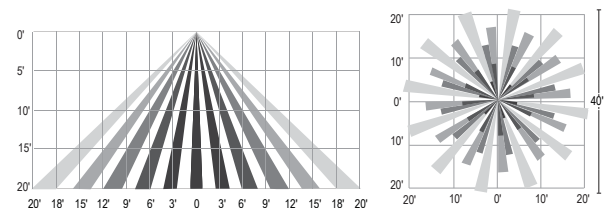

Motion response options

Bi-Level Infrared Motion Response (BL-IMRI): Motion Response module is mounted integral to luminaire factory pre-programmed to 50% dimming when not ordered with other control options. BL-IMRI is set/operates in the following fashion: The motion sensor is set to a constant 50%. When motion is detected by the PIR sensor, the luminaire returns to full power/light output. Dimming on low is factory set to 50% with 5 minutes default in "full power" prior to dimming back to low. When no motion is detected for 5 minutes, the motion response system reduces the wattage by 50%, to 50% of the normal constant wattage reducing the light level. Other dimming settings can be provided if different dimming levels are required. This can also be done with FSIR-100 Wireless Remote Programming Tool (contact Technical Support for details).

Infrared Motion Response with Other Controls: When used in combination with other controls (Automatic Dimming Profile and SiteWise), motion response device will simply override controller's schedule with the added benefits of a combined dimming profile and sensor detection. In this configuration, the motion response device cannot be re-programmed with FSIR-100 Wireless Remote Programming Tool. The profile can only be re-programmed via the controller.

ECF-S EcoForm small

Area luminaire

Specifications

Infrared Motion Response Lenses (IMRI3/IMRI7): Infrared Motion Response Integral module is available with two different sensor lens types to accommodate various mounting heights and occupancy detection ranges. Lens #3 (IMRI3) is designed for mounting heights up to 20' with a 40' diameter coverage area. Lens #7 is designed for higher mounting heights up to 40' with larger coverage areas up to 100' diameter coverage area. See charts for approximate detection patterns:

IMRI3 Luminaire or remote mount controller with #3 lens

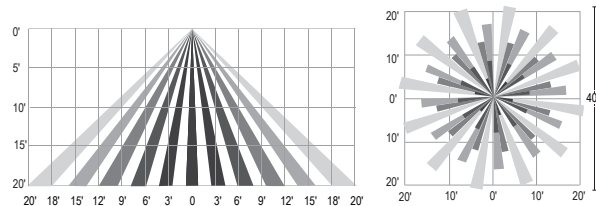

IMRI7 Luminaire or remote mount controller with #7 lens

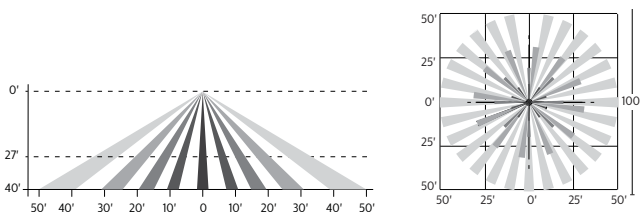

Infrared Motion Response Outboard (IMRO): Infrared Motion Response Outboard can be used in combination with automatic profile dimming and stand alone motion response. The pole mounted motion sensor is a PIR (passive infrared) device that can be mounted to a pole. One motion sensor per pole is required. Sensor finish is white Wattstopper EW-200-120-W or the EW-200-277-W. Order MS-A-120 or MS-A-277 separately. IMRO sensors require single voltage 120V or 277V input. If motion is detected during the time that the luminaire is operating at profile dimming mode specified, the luminaire returns to 100% power and light output. The luminaire remains on high until no motion is detected for the duration period, after which the luminaire returns back to automatic profile dimming. Duration period is factory set at 15 minutes, and is field adjustable from 5 minutes up to 15 minutes. The area motion detector provides coverage equal to up to 6 times the sensor height above ground, 270° from the front-center of the sensor (see chart for approximate detection patterns).

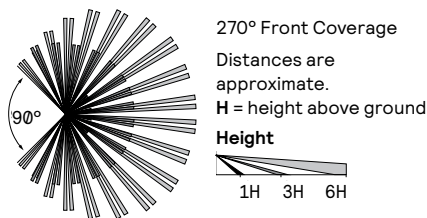

Pole Details: IMRO requires that the pole include additional hand hole 15 feet above the pole base, normally oriented 180° to the standard hand hole. For Gardco poles, order the pole with the Motion Sensor Mounting (MSM) option

which includes the hand hole and a special hand hole cover plate for the sensor with a 1/2" NPT receptacle centered on the hand hole cover plate into which the motion sensor mounts. Once the motion sensor is connected to the hand hole cover plate, then wiring connections are completed in the pole. The plate (complete with motion sensor attached and wired) is then mounted to the hand hole. If poles are supplied by others, the customer is responsible for providing suitable mounting accommodations for the motion sensor in the pole (see Gardco Poles specification sheets for more information).

Electrical

Twist-Lock Receptacle (TLRD5/TLRD7/TLRPC): Twist Lock Receptacle with 5 pins enabling dimming or with 7 pins with additional functionality (by others) can be used with a twistlock photoelectric cell or a shorting cap. Dimming Receptacle Type B (5-pin) and Type D-24 (7-pin) in accordance to ANSI C136.41. Can be used with third-party control system. Receptacle located on top of luminaire housing. When specifying receptacle with twistlock photoelectric cell, voltage must be specified. When ordering Twist-lock receptacle (TLRD5 or TLRD7), photocell or shorting cap is not included.

Driver: Driver efficiency (>90% standard). 120-480V available (restrictions apply). Open/short circuit protection. Optional 0-10V dimming to 10% power. RoHS compliant.

Button Photocontrol (PCB): Button style design for internal luminaires mounting applications. The photocontrol is constructed of a high impact UV stabilized polycarbonate housing. Rated voltage of 120V or 208-277V with a load rating of 1000 VA. The photocell will turn on with 1-4Fc of ambient light.

Surge protection (SP1/SP2): Surge protection device tested in accordance with ANSI/IEEE C62.45 per ANSI/IEEE C62.41.2 Scenario I Category C High Exposure 10kV/10kA waveforms for Line-Ground, Line-Neutral and Neutral-Ground, and in accordance with DOE MSSLC Model Specification for LED Roadway Luminaires Appendix D Electrical Immunity High test level 10kV/10kA. 20kV / 10kA surge protection device that provides extra protection beyond the SP1 10kV/10kA level.

Listings

UL/cUL wet location listed to the UL 1598 standard, suitable for use in ambient temperatures from -40° to 40°C (-40° to 104°F). Most EcoForm configurations are qualified under Premium and Standard DesignLights Consortium® categories. Consult DLC Qualified Products list to confirm your specific luminaire selection is approved. CCTs 3000K and warmer are Dark Sky Approved.

Finish

Each standard color luminaire receives a fade and abrasion resistant, electrostatically applied, thermally cured, triglycidal isocyanurate (TGIC) textured polyester powdercoat finish. Standard colors include bronze (BZ), black (BK), white (WH), dark gray (DGY), and medium gray (MGY). Consult factory for specs on optional or custom colors.

Service Tag

Each individual luminaire is uniquely identifiable, thanks to the Service tag application. With a simple scan of a QR code, placed on the inside of the mast door, you gain instant access to the luminaire configuration, making installation and maintenance operations faster and easier, no matter what stage of the luminaire's lifetime. Just download the APP and register your product right away. For more details visit: signify.com

Warranty

EcoForm luminaires feature a 5-year limited warranty. See signify.com/warranties for complete details and exclusions.

The information presented in this document is not intended as any commercial offer and does not form part of any quotation or contract.





— DRILLED PER FIXTURE REQUIREMENTS:
D1- DRILLED FOR 1 FIXTURE
D2- DRILLED FOR 2 FIXTURES AT 90° OR 180°
D3- DRILLED FOR 3 FIXTURES AT 90° OR 120°
D4- DRILLED FOR 4 FIXTURES

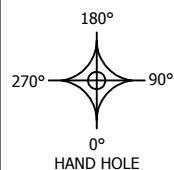

DRAWN: L. GRUNIS	3/19/2015
CHECKED	
REVISION:	DATE:
APPROVED:	
QUOTE:	
S.O.#	
REF:	SCALE: NONE

**UNITED
LIGHTING
STANDARDS**
A DWM COMPANY

23171 Groesbeck Hwy.
Warren, MI 48089
P: (586) 774-5650 | F: (586) 774-5706
www.unitedlightingstandards.com

2		1	
POLE SPECIFICATIONS			
NO.	COMPONENT		MAT'L DESIGNATION
1.	POLE SHAFT		6063-T6
2.	BASE PLATE		A356-T6
3.	ANCHOR BOLTS		F1554 GR. 55
4.	GALVANIZED HARDWARE		A153
FINISH SPECIFICATIONS			
POLES SHALL HAVE A POLYESTER POWDER COAT FINISH IN A STANDARD COLOR.			
POLE DIMENSIONS			
POLE HG'T. (FT.)	TOP DIA. (IN.)	BOTTOM DIA. (IN.)	GAGE
16'	4.00	4.00	.125
MTG. HG'T. (FT.)			
16'			
BASE PLATE DIMENSIONS			
BOLT CIRCLE (IN.)	BASE PLATE DIM. (IN.)	BOLT HOLE (IN.)	PLATE THK. (IN.)
6.75	9.62 DIA	.88	.75
ANCHOR BOLT DIMENSIONS			
ANCHOR BOLT DIA. (IN.)		ANCHOR BOLT LENGTH (IN.)	
.75		20.00	
ALLOWABLE WIND LOADING (SQ. FT.)			
WIND*	120 MPH	130 MPH	140 MPH
FPA	4.9	3.9	3.1
			2.5
			1.9
			1.5
			1.1

*2010 FBC / ASCE 7 (3 SEC. GUST FACTOR)

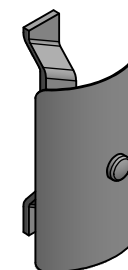

2.00 X 4.00 HAND HOLE COVER

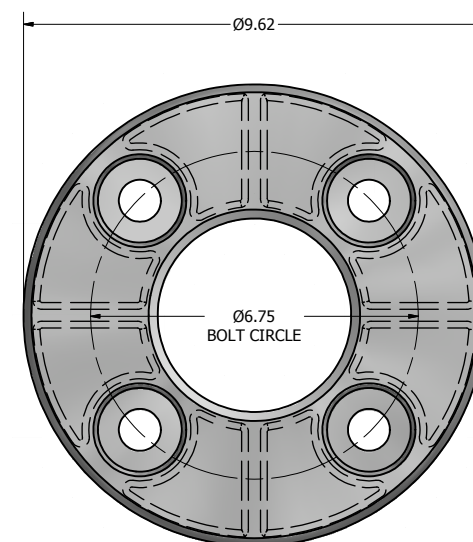

Ø9.62 X 1.88 THK. BASE CASTING

SOME GEOGRAPHICAL AREAS HAVE SPECIAL WIND CONDITIONS THAT CAN CREATE WIND INDUCED VIBRATIONS CAUSING A FATIGUE PROBLEM. NO METHOD HAS YET BEEN FOUND FOR PREDICTING DESTRUCTIVE LIGHTING POLE VIBRATION. THESE CONDITIONS ARE UNIQUE AND CANNOT BE GUARANTEED AGAINST, AND ARE THE RESPONSIBILITY OF A LOCAL SITE ENGINEER.

TITLE:

CATALOG:

DWG NO: RSA-4161

SIZE: C	SHEET 1 OF 1
---------	--------------



Gardco EcoForm Gen-2 combines economy with performance in an LED area luminaire. Capable of delivering up to 26,400 lumens or more in a compact, low profile LED luminaire, EcoForm offers a new level of customer value. EcoForm features an innovative retrofit arm kit, simplifying site conversions to LED by eliminating the need to drill additional holes in most existing poles. Integral control systems available for further energy savings. Includes Service Tag, our innovative way to provide assistance throughout the life of the product.

Project:	
Location:	
Cat.No:	
Type:	
Lamps:	Qty:
Notes:	

Ordering guide

example: ECF-S-64L-900-NW-G2-AR-5-120-HIS-MGY

Prefix	Number of LEDs	Drive Current	LED Color - Generation	Mounting	Distribution	Voltage	Options					Finish
							Dimming controls	Motion sensing lens	Photo-sensing	Electrical	Luminaire	
ECF-S												
ECF-S EcoForm site and area, small	32L 32 LEDs (2 modules)	530 530 mA 700 700 mA 1A 1050 mA 1.2A 1200 mA	WW-G2 Warm White 3000K, 70 CRI Generation 2 NW-G2 Neutral White 4000K, 70 CRI Generation 2	AR Arm Mount (standard) ² <i>The following mounting kits must be ordered separately (See accessories)</i> SF Slip Fitter Mount ³ (fits to 2 3/8" O.D. tenon) WS Wall mount with surface conduit rear entry permitted RAM Retrofit arm mount kit ²	Type 2 2 Type 2 2-90 Rotated left 90° 2-270 Rotated right 270° Type 3 3 Type 3 3-90 Rotated left 90° 3-270 Rotated right 270° Type 4 4 Type 4 4-90 Rotated left 90° 4-270 Rotated right 270° Type 5 5 Type 5 5W Type 5W AFR Auto Front Row AFR-90 Auto Front Row, Rotated left 90° AFR-270 Auto Front Row, Rotated right 270°	120 120V 208 208V 240 240V 277 277V 347 347V 480 480V UNV 120-277V (50/60Hz) HVU 347-480V (50/60Hz)	DD 0-10V External dimming (by others) ⁴ DCC Dual Circuit Control ^{4,5,6} FAWS Field Adjustable Wattage Selector ^{4,5} SW Interface module for SiteWise ^{4,6,7} LLC Integral wireless module ^{4,6,8} BL Bi-level functionality ⁴ DynaDimmer: Automatic Profile Dimming CS50 Safety 50% Dimming, 7 hours ^{4,8} CM50 Median 50% Dimming, 8 hours ^{4,8} CE50 Economy 50% Dimming, 9 hours ^{4,8} DA50 All Night 50% Dimming ^{4,8} CS30 Safety 30% Dimming, 7 hours ^{4,8} CM30 Median 30% Dimming, 8 hours ^{4,8} CE30 Economy 30% Dimming, 9 hours ^{4,8} DA30 All Night 30% Dimming ^{4,8}	IMRI3 Integral with #3 lens ¹⁵ IMRI7 Integral with #7 lens ¹⁶ IMRO Pole mounted motion sensor ¹⁵ (see accessories)	PCB Photocontrol Button ^{8,9} TLRD5 Twist Lock Receptacle 5 Pin ¹⁰ TLRD7 Twist Lock Receptacle 7 Pin ¹⁰ TLRPC Twist Lock Receptacle w/ Photocell ^{9,11}	Fusing F1 Single (120, 277, 347VAC) ⁹ F2 Double (208, 240, 480VAC) ⁹ Pole Mount Fusing FP1 Single (120, 277, 347VAC) ⁹ FP2 Double (208, 240, 480VAC) ⁹ FP3 Canadian Double Pull (208, 240, 480VAC) ⁹ Surge Protection (10kA standard) SP2 Increased 20kA	Square Pole Adapter included in standard product TB Terminal Block ¹² RPA Round Pole Adapter (fits to 3"-3.9" O.D. pole) ¹³ HIS Internal Housing Side Shield ¹⁴	Textured BK Black WH White BZ Bronze DGY Dark Gray MGY Medium Gray Customer specified RAL Specify optional color or RAL (ex: RAL7024) CC Custom color (Must supply color chip for required factory quote)

1. BL-IMRI3/7 equipped with out-boarded sensor housing when voltage is HVU (347-480V)
2. Mounts to a 4" round pole with adapter included for square poles.
3. Limited to a maximum of 45 degrees aiming above horizontal.
4. Not available with other dimming control options.
5. Not available with motion sensor.
6. Not available with photocontrol.

7. Available only in 120 or 277V.
8. Not available in 347 or 480V
9. Must specify input voltage.
10. Dimming will not be connected to NEMA receptacle if ordering with other control options.
11. Not available in 480V.
12. Not available with DCC.
13. Not available with SF and WS. RPAs provided with black finish standard.

14. HIS not available with Type 5 and 5W optics.
15. Available only with SW, LLC, and BL control options.
16. Available only with SW and BL control options.

ECF-S EcoForm small

Area luminaire

EcoForm Accessories (ordered separately, field installed)

Controls Accessories

Pole Mount Motion Sensor

MS-A-120V 120V Input
MS-A-277V 277V Input

Wireless system

Remote mount module

LLCR3-(F) #3 lens

Central Remote Motion Response

(used connected to SiteWise main panel)

MS2-A-FVR-3

MS2-A-FVR-7

Shielding Accessories

House Side shield

Standard optic orientation:

HIS-80-H¹⁴ Internal House Side Shield for 80 LEDs (5 modules)

HIS-96-H¹⁴ Internal House Side Shield for 96 LEDs (6 modules)

Optic at 90 or 270 orientation:

HIS-80-V¹⁴ Internal House Side Shield for 80 LEDs (5 modules)

HIS-96-V¹⁴ Internal House Side Shield for 96 LEDs (6 modules)

14. Not available with Type 5 or 5W optics

Luminaire Accessories

ECF-BD-G2

Bird deterrent

ECF-RAM-G2-(F)

Retrofit Arm mount kit

ECF-SF-G2-(F)

Slip Fitter Mount (fits to 2 3/8" O.D. tenon)

ECF-WG-G2-(F)

Wall mount with surface conduit rear entry permitted

EcoForm PTF2

(pole top fitter fits 23/8-21/2" OD x 4" depth tenon)

PTF2-ECF-S/L-1-90-(F) 1 luminaire at 90°
PTF2-ECF-S/L-2-90-(F) 2 luminaires at 90°
PTF2-ECF-S/L-2-180-(F) 2 luminaires at 180°
PTF2-ECF-S/L-3-90-(F) 3 luminaires at 90°
PTF2-ECF-S/L-4-90-(F) 4 luminaires at 90°
PTF2-ECF-S/L-3-120-(F) 3 luminaires at 120°

(F) = Specify finish

EcoForm PTF3

(pole top fitter fits 3-31/2" OD x 6" depth tenon)

PTF3-ECF-S/L-1-90-(F) 1 luminaire at 90°
PTF3-ECF-S/L-2-90-(F) 2 luminaires at 90°
PTF3-ECF-S/L-2-180-(F) 2 luminaires at 180°
PTF3-ECF-S/L-3-90-(F) 3 luminaires at 90°
PTF3-ECF-S/L-4-90-(F) 4 luminaires at 90°
PTF3-ECF-S/L-3-120-(F) 3 luminaires at 120°

EcoForm PTF4

(pole top fitter fits 31/2-4" OD x 6" depth tenon)

PTF4-ECF-S/L-1-90-(F) 1 luminaire at 90°
PTF4-ECF-S/L-2-90-(F) 2 luminaires at 90°
PTF4-ECF-S/L-2-180-(F) 2 luminaires at 180°
PTF4-ECF-S/L-3-90-(F) 3 luminaires at 90°
PTF4-ECF-S/L-4-90-(F) 4 luminaires at 90°
PTF4-ECF-S/L-3-120-(F) 3 luminaires at 120°

Predicted Lumen Depreciation Data

Predicted performance derived from LED manufacturer's data and engineering design estimates, based on IESNA LM-80 methodology.

Actual experience may vary due to field application conditions. L₇₀ is the predicted time when LED performance depreciates to 70% of initial lumen output. Calculated per IESNA TM21-11. Published L₇₀ hours limited to 6 times actual LED test hours

Ambient Temperature °C	Driver mA	Calculated L ₇₀ Hours	L ₇₀ per TM-21	Lumen Maintenance % at 60,000 hrs
25°C	up to 1200 mA	>100,000 hours	>60,000 hours	>88%

Optical distribution

Based on configuration ECF-S-48L-1A-NW-G2 (159W) mounted at 20ft.

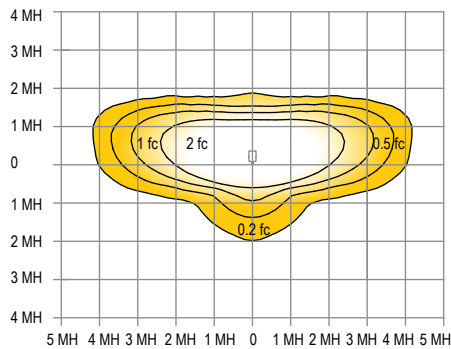

Type 2

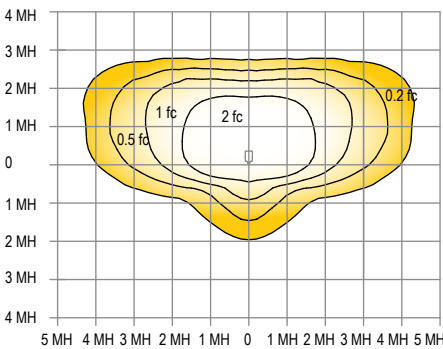

Type 3

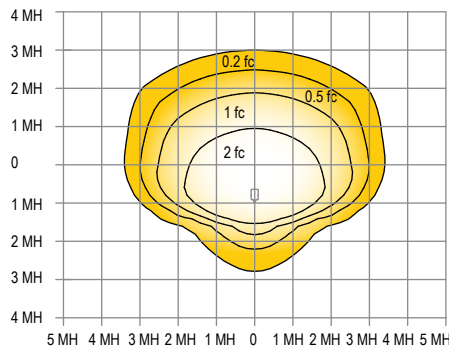

Type 4

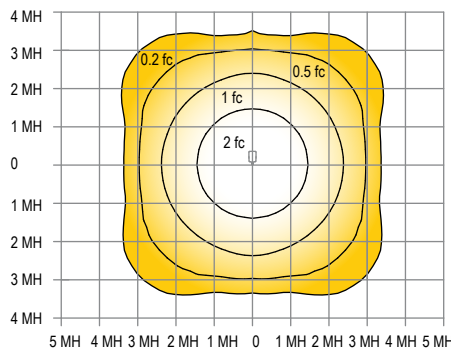

Type 5

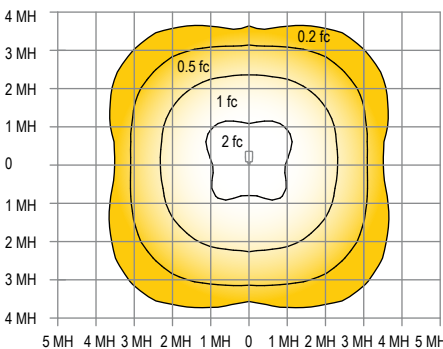

Type 5W

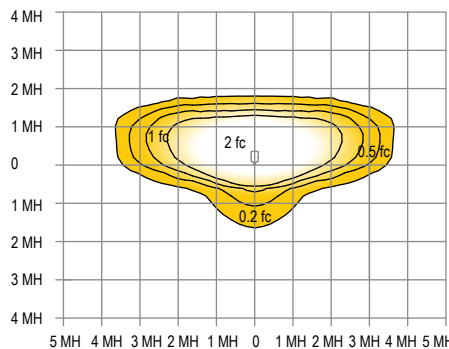

AFR

ECF-S EcoForm small

Area luminaire

3000K LED Wattage and Lumen Values

Ordering Code	Total LEDs	LED Current (mA)	Color Temp.	Average System Watts	Type 2			Type 3			Type 4		
					Lumen Output	BUG Rating	Efficacy (LPW)	Lumen Output	BUG Rating	Efficacy (LPW)	Lumen Output	BUG Rating	Efficacy (LPW)
ECF-S-32L-530-WW-G2-x	32	530	3000	56	6,178	B2-U0-G1	111	6,044	B1-U0-G2	109	6,323	B1-U0-G2	114
ECF-S-32L-700-WW-G2-x	32	700	3000	73	7,968	B2-U0-G2	109	7,795	B1-U0-G2	107	8,156	B1-U0-G2	112
ECF-S-32L-1A-WW-G2-x	32	1050	3000	106	11,218	B2-U0-G2	106	10,974	B2-U0-G2	104	11,482	B2-U0-G2	109
ECF-S-32L-1.2A-WW-G2-x	32	1200	3000	122	12,443	B3-U0-G2	102	12,173	B2-U0-G2	100	12,736	B2-U0-G3	105
ECF-S-48L-900-WW-G2-x	48	900	3000	135	14,768	B3-U0-G3	109	14,448	B2-U0-G3	107	15,116	B2-U0-G3	112
ECF-S-48L-1A-WW-G2-x	48	1050	3000	159	16,723	B3-U0-G3	105	16,360	B3-U0-G3	103	17,116	B2-U0-G3	108
ECF-S-48L-1.2A-WW-G2-x	48	1200	3000	183	18,564	B3-U0-G3	102	18,162	B3-U0-G3	99	19,001	B3-U0-G4	104
ECF-S-64L-900-WW-G2-x	64	900	3000	178	19,545	B3-U0-G3	110	19,121	B3-U0-G3	108	20,005	B3-U0-G4	113
ECF-S-64L-1A-WW-G2-x	64	1050	3000	206	22,020	B3-U0-G3	107	21,543	B3-U0-G4	105	22,538	B3-U0-G4	109

Ordering Code	Total LEDs	LED Current (mA)	Color Temp.	Average System Watts	Type 5			Type 5W			Type AFR		
					Lumen Output	BUG Rating	Efficacy (LPW)	Lumen Output	BUG Rating	Efficacy (LPW)	Lumen Output	BUG Rating	Efficacy (LPW)
ECF-S-32L-530-WW-G2-x	32	530	3000	56	6,400	B2-U0-G1	115	6,672	B3-U0-G2	120	6,458	B3-U0-G2	116
ECF-S-32L-700-WW-G2-x	32	700	3000	73	8,254	B2-U0-G1	113	8,606	B3-U0-G2	118	8,330	B4-U0-G2	114
ECF-S-32L-1A-WW-G2-x	32	1050	3000	106	11,621	B3-U0-G2	110	12,116	B4-U0-G2	115	11,727	B4-U0-G2	111
ECF-S-32L-1.2A-WW-G2-x	32	1200	3000	122	12,890	B3-U0-G2	106	13,440	B4-U0-G2	111	13,008	B4-U0-G2	107
ECF-S-48L-900-WW-G2-x	48	900	3000	135	15,299	B3-U0-G2	113	15,951	B4-U0-G2	118	15,438	B4-U0-G2	114
ECF-S-48L-1A-WW-G2-x	48	1050	3000	159	17,324	B3-U0-G2	109	18,062	B4-U0-G2	114	17,482	B5-U0-G3	110
ECF-S-48L-1.2A-WW-G2-x	48	1200	3000	183	19,231	B3-U0-G2	105	20,051	B5-U0-G3	110	19,407	B5-U0-G3	106
ECF-S-64L-900-WW-G2-x	64	900	3000	178	20,247	B3-U0-G2	114	21,111	B5-U0-G3	119	20,432	B5-U0-G3	115
ECF-S-64L-1A-WW-G2-x	64	1050	3000	206	22,811	B3-U0-G2	111	23,784	B5-U0-G3	116	23,020	B5-U0-G3	112

4000K LED Wattage and Lumen Values

Ordering Code	Total LEDs	LED Current (mA)	Color Temp.	Average System Watts	Type 2			Type 3			Type 4		
					Lumen Output	BUG Rating	Efficacy (LPW)	Lumen Output	BUG Rating	Efficacy (LPW)	Lumen Output	BUG Rating	Efficacy (LPW)
ECF-S-32L-530-NW-G2-x	32	530	4000	56	6,864	B2-U0-G2	123	6,715	B1-U0-G2	121	7,025	B1-U0-G2	126
ECF-S-32L-700-NW-G2-x	32	700	4000	73	8,853	B2-U0-G2	121	8,661	B2-U0-G2	119	9,062	B1-U0-G2	124
ECF-S-32L-1A-NW-G2-x	32	1050	4000	106	12,464	B3-U0-G2	118	12,194	B2-U0-G2	115	12,757	B2-U0-G3	121
ECF-S-32L-1.2A-NW-G2-x	32	1200	4000	122	13,826	B3-U0-G3	114	13,526	B2-U0-G3	111	14,151	B2-U0-G3	116
ECF-S-48L-900-NW-G2-x	48	900	4000	135	16,409	B3-U0-G3	121	16,053	B2-U0-G3	119	16,795	B2-U0-G3	124
ECF-S-48L-1A-NW-G2-x	48	1050	4000	159	18,581	B3-U0-G3	117	18,178	B3-U0-G3	115	19,018	B2-U0-G4	120
ECF-S-48L-1.2A-NW-G2-x	48	1200	4000	183	20,627	B3-U0-G3	113	20,180	B3-U0-G4	110	21,112	B3-U0-G4	116
ECF-S-64L-900-NW-G2-x	64	900	4000	178	21,717	B3-U0-G3	122	21,246	B3-U0-G4	119	22,228	B3-U0-G4	125
ECF-S-64L-1A-NW-G2-x	64	1050	4000	206	24,467	B3-U0-G3	119	23,936	B3-U0-G4	116	25,043	B3-U0-G4	122

Ordering Code	Total LEDs	LED Current (mA)	Color Temp.	Average System Watts	Type 5			Type 5W			Type AFR		
					Lumen Output	BUG Rating	Efficacy (LPW)	Lumen Output	BUG Rating	Efficacy (LPW)	Lumen Output	BUG Rating	Efficacy (LPW)
ECF-S-32L-530-NW-G2-x	32	530	4000	56	7,414	B3-U0-G2	133	7,175	B3-U0-G2	129	7,111	B2-U0-G1	128
ECF-S-32L-700-NW-G2-x	32	700	4000	73	9,563	B3-U0-G2	131	9,255	B4-U0-G2	127	9,172	B2-U0-G1	126
ECF-S-32L-1A-NW-G2-x	32	1050	4000	106	13,462	B4-U0-G2	127	13,030	B4-U0-G2	123	12,912	B3-U0-G2	122
ECF-S-32L-1.2A-NW-G2-x	32	1200	4000	122	14,933	B4-U0-G2	123	14,453	B4-U0-G2	119	14,322	B3-U0-G2	118
ECF-S-48L-900-NW-G2-x	48	900	4000	135	17,723	B4-U0-G2	131	17,154	B5-U0-G3	127	16,999	B3-U0-G2	126
ECF-S-48L-1A-NW-G2-x	48	1050	4000	159	20,069	B5-U0-G3	126	19,424	B5-U0-G3	122	19,248	B3-U0-G2	121
ECF-S-48L-1.2A-NW-G2-x	48	1200	4000	183	22,279	B5-U0-G3	122	21,563	B5-U0-G3	118	21,368	B3-U0-G2	117
ECF-S-64L-900-NW-G2-x	64	900	4000	178	23,456	B5-U0-G3	132	22,702	B5-U0-G3	128	22,497	B3-U0-G2	127
ECF-S-64L-1A-NW-G2-x	64	1050	4000	206	26,427	B5-U0-G3	128	25,577	B5-U0-G4	124	25,346	B3-U0-G2	123

ECF-S EcoForm small

Area luminaire

5000K LED Wattage and Lumen Values

Ordering Code	Total LEDs	LED Current (mA)	Color Temp.	Average System Watts	Type 2			Type 3			Type 4		
					Lumen Output	BUG Rating	Efficacy (LPW)	Lumen Output	BUG Rating	Efficacy (LPW)	Lumen Output	BUG Rating	Efficacy (LPW)
ECF-S-32L-530-CW-G2-x	32	530	5000	56	6,658	B2-U0-G2	120	6,514	B1-U0-G2	117	6,815	B1-U0-G2	122
ECF-S-32L-700-CW-G2-x	32	700	5000	73	8,588	B2-U0-G2	118	8,402	B2-U0-G2	115	8,790	B1-U0-G2	121
ECF-S-32L-1A-CW-G2-x	32	1050	5000	106	12,090	B3-U0-G2	114	11,828	B2-U0-G2	112	12,375	B2-U0-G3	117
ECF-S-32L-1.2A-CW-G2-x	32	1200	5000	122	13,411	B3-U0-G3	110	13,120	B2-U0-G3	108	13,726	B2-U0-G3	113
ECF-S-48L-900-CW-G2-x	48	900	5000	135	15,917	B3-U0-G3	118	15,572	B2-U0-G3	115	16,291	B2-U0-G3	121
ECF-S-48L-1A-CW-G2-x	48	1050	5000	159	18,023	B3-U0-G3	114	17,633	B3-U0-G3	111	18,447	B2-U0-G4	116
ECF-S-48L-1.2A-CW-G2-x	48	1200	5000	183	20,008	B3-U0-G3	110	19,574	B3-U0-G4	107	20,479	B3-U0-G4	112
ECF-S-64L-900-CW-G2-x	64	900	5000	178	21,065	B3-U0-G3	118	20,609	B3-U0-G4	116	21,561	B3-U0-G4	121
ECF-S-64L-1A-CW-G2-x	64	1050	5000	206	23,733	B3-U0-G3	115	23,218	B3-U0-G4	113	24,291	B3-U0-G4	118

Ordering Code	Total LEDs	LED Current (mA)	Color Temp.	Average System Watts	Type 5			Type 5W			Type AFR		
					Lumen Output	BUG Rating	Efficacy (LPW)	Lumen Output	BUG Rating	Efficacy (LPW)	Lumen Output	BUG Rating	Efficacy (LPW)
ECF-S-32L-530-CW-G2-x	32	530	5000	56	6,897	B2-U0-G1	124	7,191	B3-U0-G2	129	6,960	B3-U0-G2	125
ECF-S-32L-700-CW-G2-x	32	700	5000	73	8,896	B2-U0-G1	122	9,276	B3-U0-G2	127	8,978	B4-U0-G2	123
ECF-S-32L-1A-CW-G2-x	32	1050	5000	106	12,524	B3-U0-G2	119	13,058	B4-U0-G2	124	12,639	B4-U0-G2	120
ECF-S-32L-1.2A-CW-G2-x	32	1200	5000	122	13,893	B3-U0-G2	114	14,485	B4-U0-G2	119	14,020	B4-U0-G2	115
ECF-S-48L-900-CW-G2-x	48	900	5000	135	16,489	B3-U0-G2	122	17,192	B4-U0-G2	127	16,639	B5-U0-G3	123
ECF-S-48L-1A-CW-G2-x	48	1050	5000	159	18,671	B3-U0-G2	118	19,467	B5-U0-G3	123	18,841	B5-U0-G3	119
ECF-S-48L-1.2A-CW-G2-x	48	1200	5000	183	20,727	B3-U0-G2	113	21,611	B5-U0-G3	118	20,916	B5-U0-G3	114
ECF-S-64L-900-CW-G2-x	64	900	5000	178	21,822	B3-U0-G2	123	22,753	B5-U0-G3	128	22,021	B5-U0-G3	124
ECF-S-64L-1A-CW-G2-x	64	1050	5000	206	24,586	B3-U0-G2	119	25,634	B5-U0-G3	124	24,810	B5-U0-G4	120

ECF-S EcoForm small

Area luminaire

Dimensions

Standard Arm (AR)

Weight: 22 Lbs (9.9 Kg) EPA: 0.21ft² (.019m²)

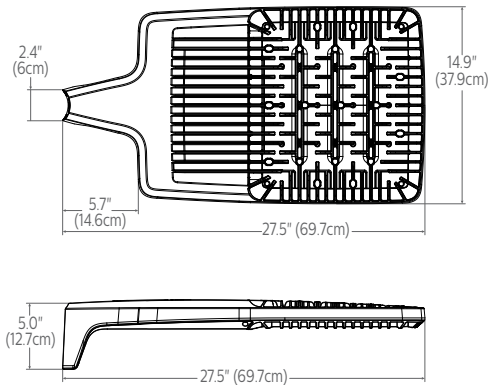

Wall (WS)

Weight: 27 Lbs. (12. 2Kg)EPA: 0.27ft² (.025m²)

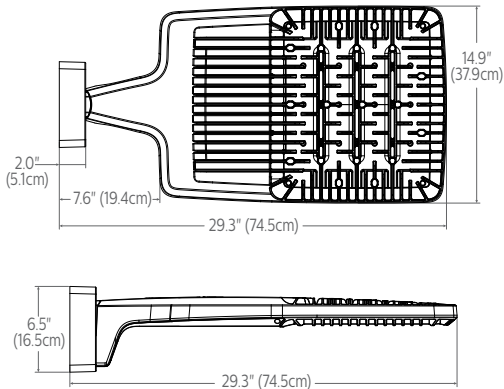

Retrofit Arm (RAM)

Weight: 24 Lbs (10.9 Kg) EPA: 0.24ft² (.022m²)

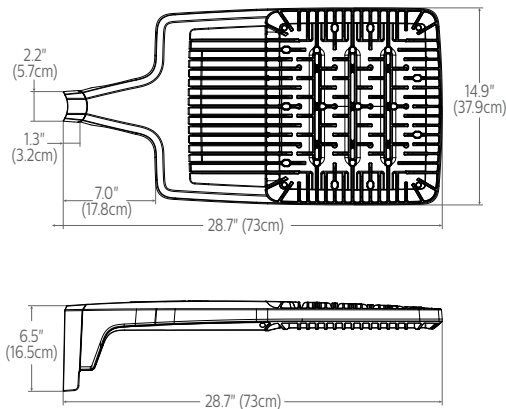

Slip fitter (SF)

Weight: 27 Lbs (12.2 Kg) EPA: 0.33ft² (.031m²)

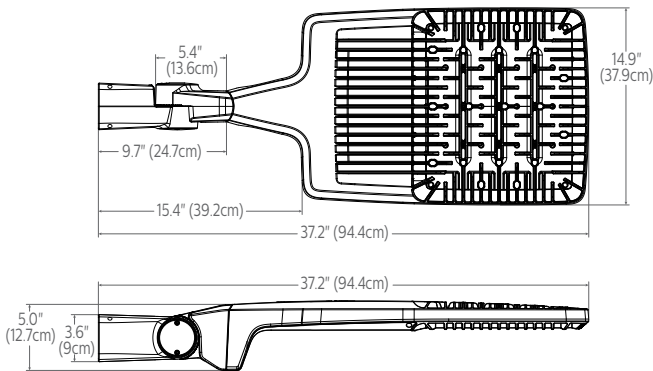

Outboard IMR-HVU sensor

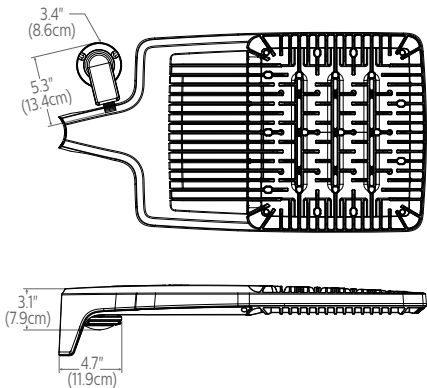

Standard Arm (AR) drill pattern

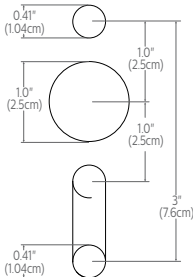

Retrofit Arm (RAM) drill pattern

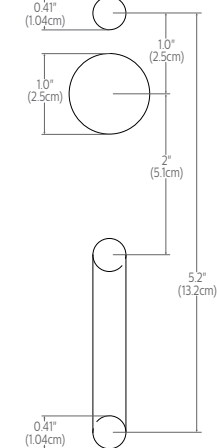

ECF-S EcoForm small

Area luminaire

Optical Orientation Information

Standard Optic Position

Luminaires ordered with asymmetric optical systems in the standard optic position will have the optical system oriented as shown below:

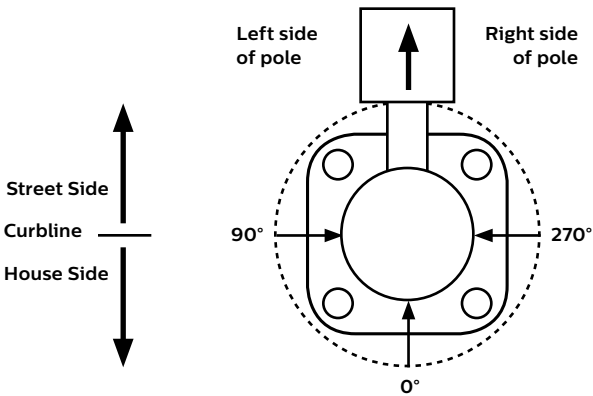

Note: The hand hole will normally be located on the pole at the 0° point.

Optic Rotated Left (90°) Optic Position

Luminaires ordered with optical systems in the Optic Rotated Left (90°) optic position will have the optical system oriented as shown below (Type 5 and 5W optics are not available with factory set rotatable optics):

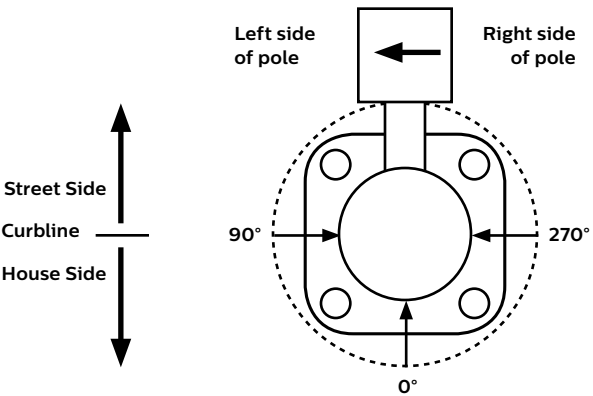

Note: The hand hole will normally be located on the pole at the 0° point.

Optic Rotated Right (270°) Optic Position

Luminaires ordered with optical systems in the Optic Rotated Right (270°) optic position will have the optical system oriented as shown below (Type 5 and 5W optics are not available with factory set rotatable optics):

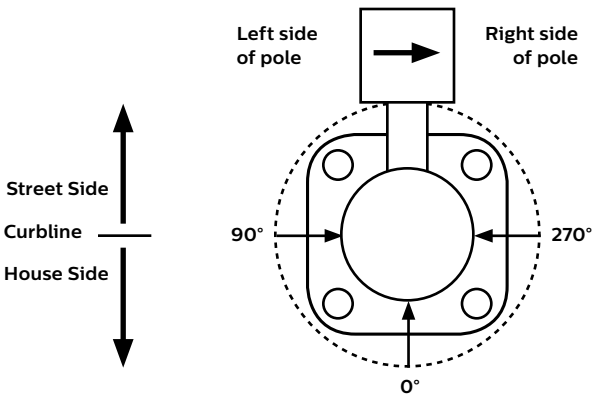

Note: The hand hole will normally be located on the pole at the 0° point.

Twin Luminaire Assemblies with Type-90/Type-270 Rotated Optical Systems

Twin luminaire assemblies installed with rotated optical systems are an excellent way to direct light toward the interior of the site (Street Side) without additional equipment. It is important, however, that care be exercised to insure that luminaires are installed in the proper location.

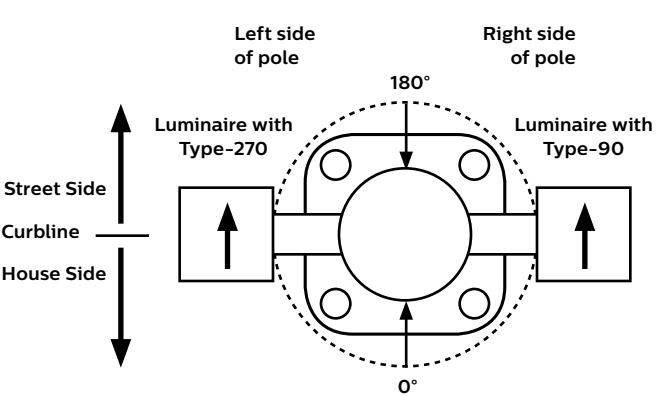

Luminaires with Optic Rotated Right (270°) are installed on the LEFT Side of Pole

Luminaires with Optic Rotated Left (90°) are installed on the RIGHT Side of Pole

Note: The hand hole location will depend on the drilling configuration ordered for the pole.

ECF-S EcoForm small

Area luminaire

Specifications

Housing

One-piece die cast aluminum housing with integral arm and separate, self-retained hinged, one-piece die cast door frame. Luminaire housing rated to IP66, tested in accordance to Section 9 of IEC 60598-1.

Vibration resistance

Luminaire is tested and rated 3G over 100,000 cycles conforming to standards set forth by ANSI C136.31-2010. Testing includes vibration in three axes, all performed on the same luminaire.

Light engine

Light engine comprises of a module of 16-LED aluminum metal clad board fully sealed with optics offered in multiples of 2, 3, and 4 modules or 32, 48, and 64 LEDs. Module is RoHS compliant. Color temperatures: 3000K +/-125K, 4000K, 5000K +/- 200K. Minimum CRI of 70. LED light engine is rated IP66 in accordance to Section 9 of IEC 60598-1.

Energy saving benefits

System efficacy up to 133 lms/W with significant energy savings over Pulse Start Metal Halide luminaires. Optional control options provide added energy savings during unoccupied periods.

Optical systems

Type 2, 3, 4, 5, 5W, and AFR distributions available. Internal Shield option mounts to LED optics and is available with Type 2, 3, 4, and AFR distributions. Types 2, 3, 4, and AFR when specified and used as rotated, are factory set only. Performance tested per LM-79 and TM-15 (IESNA) certifying its photometric performance. Luminaire designed with 0% uplight (U0 per IESNA TM-15).

Mounting

Standard luminaire arm mounts to 4" O.D. round poles. Can also be used with 5" O.D. poles. Square pole adapter included with every luminaire. Round Pole Adapter (RPA) required for 3-3.9" poles. EcoForm features a retrofit arm kit. When specified with the retrofit arm (RAM) option, EcoForm seamlessly simplifies site conversions to LED by eliminating the need for additional pole drilling on most existing poles. RAM will be boxed separately. Also optional are slipfitter and wall mounting accessories.

Control options

0-10V dimming (DD): Access to 0-10V dimming leads supplied through back of luminaire (for secondary dimming controls by others). Cannot be used with other control options.

Dual Circuit Control (DCC): Luminaire equipped with the ability to have two separate circuits controlling drivers and light engines independently. Permits separate switching of separate modules controlled by use of two sets of leads, one for each circuit. Not recommended to be used with other control options, motion response, or photocells.

SiteWise (SW): SiteWise system includes a controller fully integrated in the luminaire that enables the luminaires to communicate with a dimming signal transmitter cabinet located on site using patented central dimming technology. A locally accessible mobile app allows users to access the system and set functionalities such as ON/OFF, dimming levels and scheduling. SiteWise is available with motion response options in order to bring the light back to 100% when motion is detected. Cannot be used with other control options or photocell options. Additional functionalities are available such as communication with indoor lighting and connection to BMS systems. Complete information on the control system can be found on the SiteWise website at philips.com/sitewise.

Automatic Profile Dimming (CS/CM/CE/CA): Standard dimming profile of 30% or 50% provide flexibility towards energy savings goals while optimizing light levels during specific dark hours. When used in combination with not programmed motion response it overrides the controller's schedule when motion is detected. After 5 minutes with no motion, it will return to the automatic dimming profile schedule. Automatic dimming profile scheduled with the following settings:

- **CS50/CS30:** Security for 7 hours night duration (Ex., 11 PM – 6 AM)
- **CM50/CM30:** Median for 8 hours night duration (Ex., 10 PM – 6 AM)
- **CE50/CE30:** Economy for 9 hours night duration (Ex., 9 PM – 6 AM)
- **CA50/CA30:** for all night (during all dark hours)

All above profiles are calculated from mid point of the night. Dimming is set for 6 hours after the mid point and 1, 2, or 3 hours before depending of the duration of dimming. Cannot be used with other dimming control options.

Field Adjustable Wattage Selector (FAWS): Luminaire equipped with the ability to manually adjust the wattage in the field to reduce total luminaire lumen output and light levels. Comes pre-set to the highest position at the lumen output selected. Use chart below to estimate reduction in lumen output desired. Cannot be used with other control options or motion response.

FAWS Position	Percent of Typical Lumen Output
1	25%
2	50%
3	55%
4	65%
5	75%
6	80%
7	85%
8	90%
9	95%
10	100%

Note: Typical value accuracy +/- 5%

Wireless system (LLC): Optional wireless controller integral to luminaire ready to be connected to a Limelight system (sold by others). The system allows you to wirelessly manage the entire site, independent lighting groups or individual luminaires while on-site or remotely. Based on a high-density mesh network with an easy to use web-based portal, you can conveniently access, monitor and manage your lighting network remotely. Wireless controls can be combined with site and area, pedestrian, and parking garage luminaires as well, for a completely connected outdoor solution. Equipped with motion response with #3 lens for 8-25' mounting heights. Also available with remote pod accessory where pod is mounted separate from luminaire to pole or wall.

LLC wireless controller with #3 lens

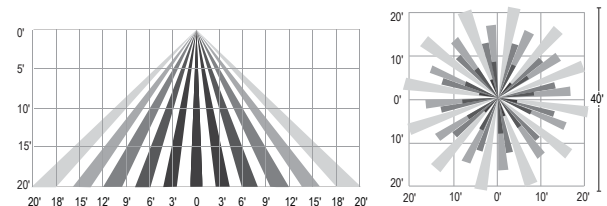

Motion response options

Bi-Level Infrared Motion Response (BL-IMRI): Motion Response module is mounted integral to luminaire factory pre-programmed to 50% dimming when not ordered with other control options. BL-IMRI is set/operates in the following fashion: The motion sensor is set to a constant 50%. When motion is detected by the PIR sensor, the luminaire returns to full power/light output. Dimming on low is factory set to 50% with 5 minutes default in "full power" prior to dimming back to low. When no motion is detected for 5 minutes, the motion response system reduces the wattage by 50%, to 50% of the normal constant wattage reducing the light level. Other dimming settings can be provided if different dimming levels are required. This can also be done with FSIR-100 Wireless Remote Programming Tool (contact Technical Support for details).

Infrared Motion Response with Other Controls: When used in combination with other controls (Automatic Dimming Profile and SiteWise), motion response device will simply override controller's schedule with the added benefits of a combined dimming profile and sensor detection. In this configuration, the motion response device cannot be re-programmed with FSIR-100 Wireless Remote Programming Tool. The profile can only be re-programmed via the controller.

ECF-S EcoForm small

Area luminaire

Specifications

Infrared Motion Response Lenses (IMRI3/IMRI7): Infrared Motion Response Integral module is available with two different sensor lens types to accommodate various mounting heights and occupancy detection ranges. Lens #3 (IMRI3) is designed for mounting heights up to 20' with a 40' diameter coverage area. Lens #7 is designed for higher mounting heights up to 40' with larger coverage areas up to 100' diameter coverage area. See charts for approximate detection patterns:

IMRI3 Luminaire or remote mount controller with #3 lens

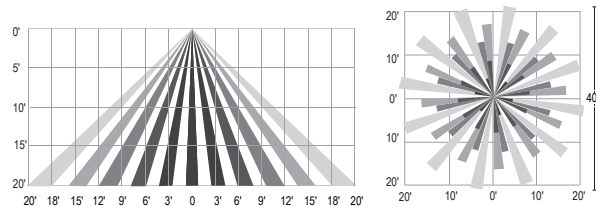

IMRI7 Luminaire or remote mount controller with #7 lens

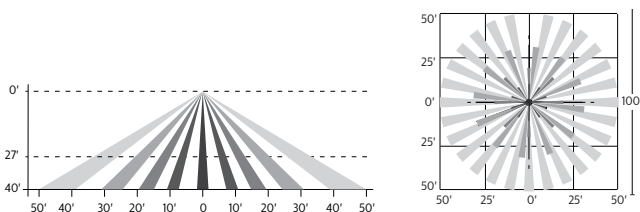

Infrared Motion Response Outboard (IMRO): Infrared Motion Response Outboard can be used in combination with automatic profile dimming and stand alone motion response. The pole mounted motion sensor is a PIR (passive infrared) device that can be mounted to a pole. One motion sensor per pole is required. Sensor finish is white Wattstopper EW-200-120-W or the EW-200-277-W. Order MS-A-120 or MS-A-277 separately. IMRO sensors require single voltage 120V or 277V input. If motion is detected during the time that the luminaire is operating at profile dimming mode specified, the luminaire returns to 100% power and light output. The luminaire remains on high until no motion is detected for the duration period, after which the luminaire returns back to automatic profile dimming. Duration period is factory set at 15 minutes, and is field adjustable from 5 minutes up to 15 minutes. The area motion detector provides coverage equal to up to 6 times the sensor height above ground, 270° from the front-center of the sensor (see chart for approximate detection patterns).

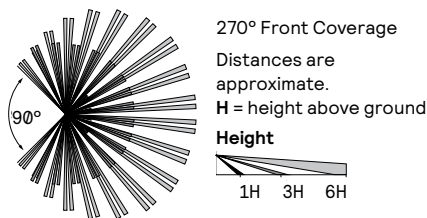

Pole Details: IMRO requires that the pole include additional hand hole 15 feet above the pole base, normally oriented 180° to the standard hand hole. For Gardco poles, order the pole with the Motion Sensor Mounting (MSM) option

which includes the hand hole and a special hand hole cover plate for the sensor with a 1/2" NPT receptacle centered on the hand hole cover plate into which the motion sensor mounts. Once the motion sensor is connected to the hand hole cover plate, then wiring connections are completed in the pole. The plate (complete with motion sensor attached and wired) is then mounted to the hand hole. If poles are supplied by others, the customer is responsible for providing suitable mounting accommodations for the motion sensor in the pole (see Gardco Poles specification sheets for more information).

Electrical

Twist-Lock Receptacle (TLRD5/TLRD7/TLRPC): Twist Lock Receptacle with 5 pins enabling dimming or with 7 pins with additional functionality (by others) can be used with a twistlock photoelectric cell or a shorting cap. Dimming Receptacle Type B (5-pin) and Type D-24 (7-pin) in accordance to ANSI C136.41. Can be used with third-party control system. Receptacle located on top of luminaire housing. When specifying receptacle with twistlock photoelectric cell, voltage must be specified. When ordering Twist-lock receptacle (TLRD5 or TLRD7), photocell or shorting cap is not included.

Driver: Driver efficiency (>90% standard). 120-480V available (restrictions apply). Open/short circuit protection. Optional 0-10V dimming to 10% power. RoHS compliant.

Button Photocontrol (PCB): Button style design for internal luminaires mounting applications. The photocontrol is constructed of a high impact UV stabilized polycarbonate housing. Rated voltage of 120V or 208-277V with a load rating of 1000 VA. The photocell will turn on with 1-4Fc of ambient light.

Surge protection (SP1/SP2): Surge protection device tested in accordance with ANSI/IEEE C62.45 per ANSI/IEEE C62.41.2 Scenario I Category C High Exposure 10kV/10kA waveforms for Line-Ground, Line-Neutral and Neutral-Ground, and in accordance with DOE MSSLC Model Specification for LED Roadway Luminaires Appendix D Electrical Immunity High test level 10kV/10kA. 20kV / 10kA surge protection device that provides extra protection beyond the SP1 10kV/10kA level.

Listings

UL/cUL wet location listed to the UL 1598 standard, suitable for use in ambient temperatures from -40° to 40°C (-40° to 104°F). Most EcoForm configurations are qualified under Premium and Standard DesignLights Consortium® categories. Consult DLC Qualified Products list to confirm your specific luminaire selection is approved. CCTs 3000K and warmer are Dark Sky Approved.

Finish

Each standard color luminaire receives a fade and abrasion resistant, electrostatically applied, thermally cured, triglycidal isocyanurate (TGIC) textured polyester powdercoat finish. Standard colors include bronze (BZ), black (BK), white (WH), dark gray (DGY), and medium gray (MGY). Consult factory for specs on optional or custom colors.

Service Tag

Each individual luminaire is uniquely identifiable, thanks to the Service tag application. With a simple scan of a QR code, placed on the inside of the mast door, you gain instant access to the luminaire configuration, making installation and maintenance operations faster and easier, no matter what stage of the luminaire's lifetime. Just download the APP and register your product right away. For more details visit: signify.com

Warranty

EcoForm luminaires feature a 5-year limited warranty. See signify.com/warranties for complete details and exclusions.

The information presented in this document is not intended as any commercial offer and does not form part of any quotation or contract.



S9275 Series

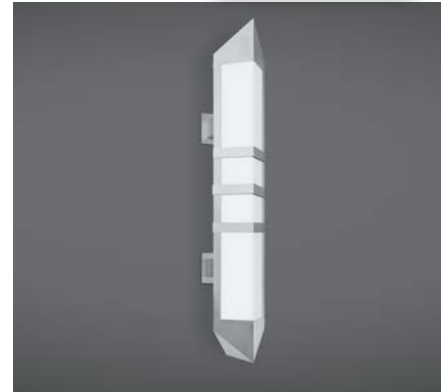
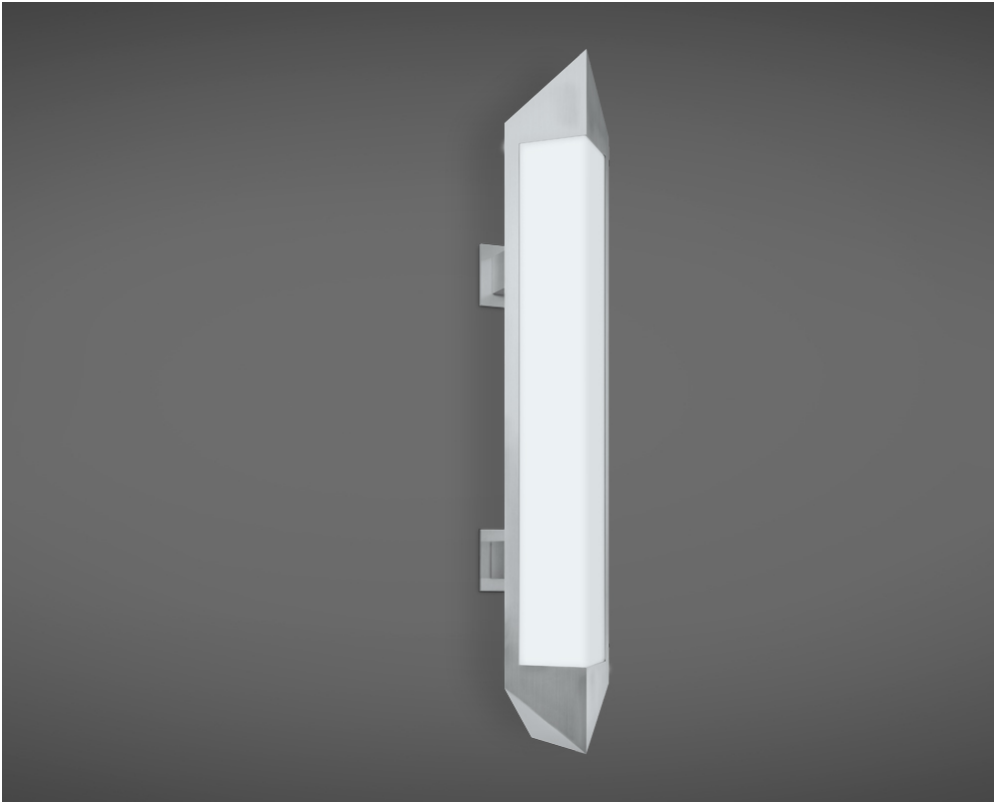

DIMENSIONS

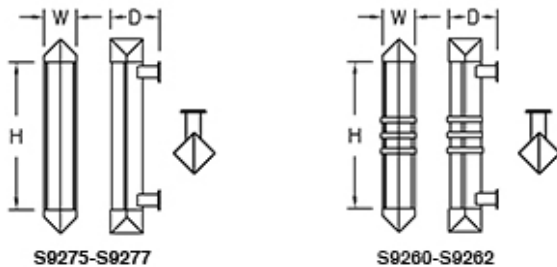

W	H	D	MC	BASE MODEL NO.
8"	26"	12"	8 1/2"	S9260-L24
8"	36"	12"	8 1/2"	S9261-L34
8"	50"	12"	8 1/2"	S9262-L48
8"	26"	12"	8 1/2"	S9275-L24
8"	36"	12"	8 1/2"	S9276-L34
8"	50"	12"	8 1/2"	S9277-L48

SPECIFICATIONS

Driver: 0-10V dimming to 1%, 120/277

Mounting: Mounts to all Standard Electrical Junction Boxes (by others) With Hardware Provided. Silicone Seal Required (by others).

FEATURES

- Opal Acrylic Lens
- Solid Aluminum End-Caps
- Solid Aluminum Bar Stock Material
- Stainless Steel Fastener

ORDER AS A COMPLETE UNIT:

Model No. + Lamp Code + CCT + Finish + Option Code

S9260-L24	+	27K	+	PT	+	Option
S9261-L34		30K		BA		
S9262-L48		35K				
S9275-L24						
S9276-L34						
S9277-L48						

FINISHES

BA Brushed Aluminum

PT Powder Coated Finishes*

*(Specify Color Code from the list of Powder Coating Finishes [except interior only metallics])

OPTIONS

EML Emergency Battery Pack with LED Lighting (Remote – Requires Additional Power Cable)

LIGHT OUTPUT

LXX = ~ 63 LPW Delivered Lumens (Example: L24= 24 x 63 = 1,512 Lumens)

** Try our new **Shimmer Metallic Paints**, Formulated for Exterior Conditions.

S9275 Series



- UL Listed for Wet Location
- LED 0-10V Dimming Driver

www.ScottArchLighting.com | Tel (707) 864-2172 | Fax (707) 864-2182
© Copyright 2019 Scott Architectural Lighting. All Rights Reserved. Made in the USA.





Gardco EcoForm Gen-2 combines economy with performance in an LED area luminaire. Capable of delivering up to 26,400 lumens or more in a compact, low profile LED luminaire, EcoForm offers a new level of customer value. EcoForm features an innovative retrofit arm kit, simplifying site conversions to LED by eliminating the need to drill additional holes in most existing poles. Integral control systems available for further energy savings. Includes Service Tag, our innovative way to provide assistance throughout the life of the product.

Project:	
Location:	
Cat.No:	
Type:	
Lamps:	Qty:
Notes:	

Ordering guide

example: ECF-S-64L-900-NW-G2-AR-5-120-HIS-MGY

Prefix	Number of LEDs	Drive Current	LED Color - Generation	Mounting	Distribution	Voltage	Options					Finish
							Dimming controls	Motion sensing lens	Photo-sensing	Electrical	Luminaire	
ECF-S												
ECF-S EcoForm site and area, small	32L 32 LEDs (2 modules)	530 530 mA 700 700 mA 1A 1050 mA 1.2A 1200 mA	WW-G2 Warm White 3000K, 70 CRI Generation 2 NW-G2 Neutral White 4000K, 70 CRI Generation 2	AR Arm Mount (standard) ² <i>The following mounting kits must be ordered separately (See accessories)</i> SF Slip Fitter Mount ³ (fits to 2 3/8" O.D. tenon) WS Wall mount with surface conduit rear entry permitted RAM Retrofit arm mount kit ²	Type 2 2 Type 2 2-90 Rotated left 90° 2-270 Rotated right 270° Type 3 3 Type 3 3-90 Rotated left 90° 3-270 Rotated right 270° Type 4 4 Type 4 4-90 Rotated left 90° 4-270 Rotated right 270° Type 5 5 Type 5 5W Type 5W AFR Auto Front Row AFR-90 Auto Front Row, Rotated left 90° AFR-270 Auto Front Row, Rotated right 270°	120 120V 208 208V 240 240V 277 277V 347 347V 480 480V UNV 20-277V (50/60Hz) HVU 347-480V (50/60Hz)	DD 0-10V External dimming (by others) ⁴ DCC Dual Circuit Control ^{4,5,6} FAWS Field Adjustable Wattage Selector ^{4,5} SW Interface module for SiteWise ^{4,6,7} LLC Integral wireless module ^{4,6,8} BL Bi-level functionality ^{4,4} DynaDimmer: Automatic Profile Dimming CS50 Safety 50% Dimming, 7 hours ^{4,8} CM50 Median 50% Dimming, 8 hours ^{4,8} CE50 Economy 50% Dimming, 9 hours ^{4,8} DA50 All Night 50% Dimming ^{4,8} CS30 Safety 30% Dimming, 7 hours ^{4,8} CM30 Median 30% Dimming, 8 hours ^{4,8} CE30 Economy 30% Dimming, 9 hours ^{4,8} DA30 All Night 30% Dimming ^{4,8}	IMRI3 Integral with #3 lens ¹⁵ IMRI7 Integral with #7 lens ¹⁶ IMRO Pole mounted motion sensor ¹⁵ (see accessories)	PCB Photocontrol Button ^{8,9} TLRD5 Twist Lock Receptacle 5 Pin ¹⁰ TLRD7 Twist Lock Receptacle 7 Pin ¹⁰ TLRPC Twist Lock Receptacle w/ Photocell ^{9,11}	Fusing F1 Single (120, 277, 347VAC) ⁹ F2 Double (208, 240, 480VAC) ⁹ Pole Mount Fusing FP1 Single (120, 277, 347VAC) ⁹ FP2 Double (208, 240, 480VAC) ⁹ FP3 Canadian Double Pull (208, 240, 480VAC) ⁹ Surge Protection (10kA standard) SP2 Increased 20kA	Square Pole Adapter included in standard product TB Terminal Block ¹² RPA Round Pole Adapter (fits to 3"-3.9" O.D. pole) ¹³ HIS Internal Housing Side Shield ¹⁴	Textured BK Black WH White BZ Bronze DGY Dark Gray MGY Medium Gray Customer specified RAL Specify optional color or RAL (ex: RAL7024) CC Custom color (Must supply color chip for required factory quote)

- BL-IMRI3/7 equipped with out-boarded sensor housing when voltage is HVU (347-480V)
- Mounts to a 4" round pole with adapter included for square poles.
- Limited to a maximum of 45 degrees aiming above horizontal.
- Not available with other dimming control options.
- Not available with motion sensor.
- Not available with photocontrol.

- Available only in 120 or 277V.
- Not available in 347 or 480V
- Must specify input voltage.
- Dimming will not be connected to NEMA receptacle if ordering with other control options.
- Not available in 480V.
- Not available with DCC.
- Not available with SF and WS. RPAs provided with black finish standard.

- HIS not available with Type 5 and 5W optics.
- Available only with SW, LLC, and BL control options.
- Available only with SW and BL control options.

ECF-S EcoForm small

Area luminaire

EcoForm Accessories (ordered separately, field installed)

Controls Accessories

Pole Mount Motion Sensor

MS-A-120V 120V Input
MS-A-277V 277V Input

Wireless system

Remote mount module

LLCR3-(F) #3 lens

Central Remote Motion Response

(used connected to SiteWise main panel)

MS2-A-FVR-3

MS2-A-FVR-7

Shielding Accessories

House Side shield

Standard optic orientation:

HIS-80-H¹⁴ Internal House Side Shield for 80 LEDs (5 modules)
HIS-96-H¹⁴ Internal House Side Shield for 96 LEDs (6 modules)

Optic at 90 or 270 orientation:

HIS-80-V¹⁴ Internal House Side Shield for 80 LEDs (5 modules)
HIS-96-V¹⁴ Internal House Side Shield for 96 LEDs (6 modules)

14. Not available with Type 5 or 5W optics

Luminaire Accessories

ECF-BD-G2 Bird deterrent
ECF-RAM-G2-(F) Retrofit Arm mount kit
ECF-SF-G2-(F) Slip Fitter Mount (fits to 2 3/8" O.D. tenon)
ECF-WS-G2-(F) Wall mount with surface conduit rear entry permitted

EcoForm PTF2
(pole top fitter fits 23/8-21/2" OD x 4" depth tenon)

PTF2-ECF-S/L-1-90-(F) 1 luminaire at 90°
PTF2-ECF-S/L-2-90-(F) 2 luminaires at 90°
PTF2-ECF-S/L-2-180-(F) 2 luminaires at 180°
PTF2-ECF-S/L-3-90-(F) 3 luminaires at 90°
PTF2-ECF-S/L-4-90-(F) 4 luminaires at 90°
PTF2-ECF-S/L-3-120-(F) 3 luminaires at 120°

EcoForm PTF3
(pole top fitter fits 3-31/2" OD x 6" depth tenon)

PTF3-ECF-S/L-1-90-(F) 1 luminaire at 90°
PTF3-ECF-S/L-2-90-(F) 2 luminaires at 90°
PTF3-ECF-S/L-2-180-(F) 2 luminaires at 180°
PTF3-ECF-S/L-3-90-(F) 3 luminaires at 90°
PTF3-ECF-S/L-4-90-(F) 4 luminaires at 90°
PTF3-ECF-S/L-3-120-(F) 3 luminaires at 120°

EcoForm PTF4
(pole top fitter fits 31/2-4" OD x 6" depth tenon)

PTF4-ECF-S/L-1-90-(F) 1 luminaire at 90°
PTF4-ECF-S/L-2-90-(F) 2 luminaires at 90°
PTF4-ECF-S/L-2-180-(F) 2 luminaires at 180°
PTF4-ECF-S/L-3-90-(F) 3 luminaires at 90°
PTF4-ECF-S/L-4-90-(F) 4 luminaires at 90°
PTF4-ECF-S/L-3-120-(F) 3 luminaires at 120°

(F) = Specify finish

Predicted Lumen Depreciation Data

Predicted performance derived from LED manufacturer's data and engineering design estimates, based on IESNA LM-80 methodology. Actual experience may vary due to field application conditions. L₇₀ is the predicted time when LED performance depreciates to 70% of initial lumen output. Calculated per IESNA TM21-11. Published L₇₀ hours limited to 6 times actual LED test hours

Ambient Temperature °C	Driver mA	Calculated L ₇₀ Hours	L ₇₀ per TM-21	Lumen Maintenance % at 60,000 hrs
25°C	up to 1200 mA	>100,000 hours	>60,000 hours	>88%

Optical distribution

Based on configuration ECF-S-48L-1A-NW-G2 (159W) mounted at 20ft.

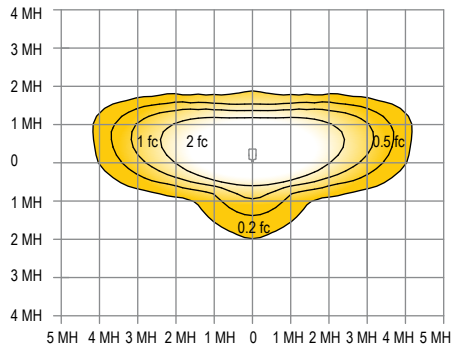

Type 2

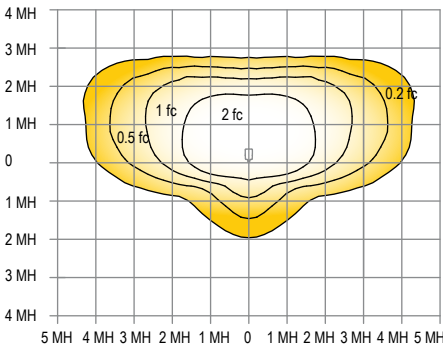

Type 3

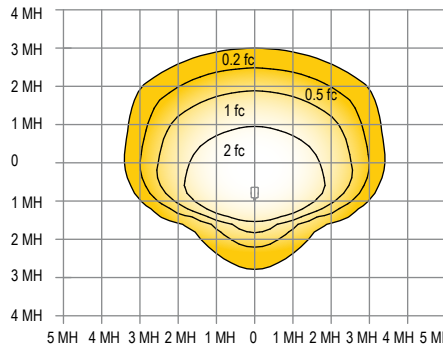

Type 4

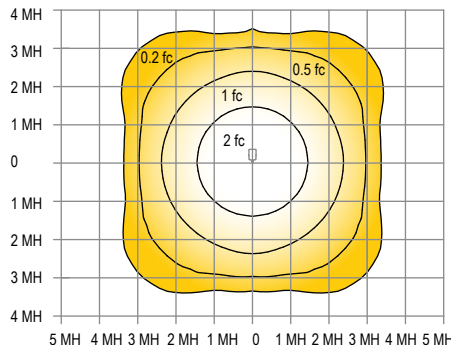

Type 5

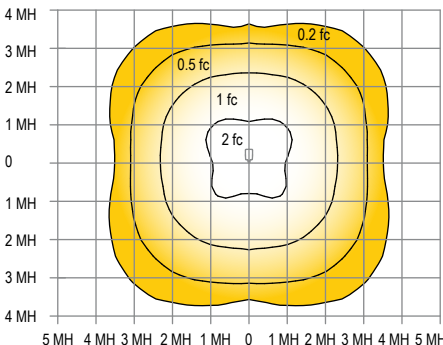

Type 5W

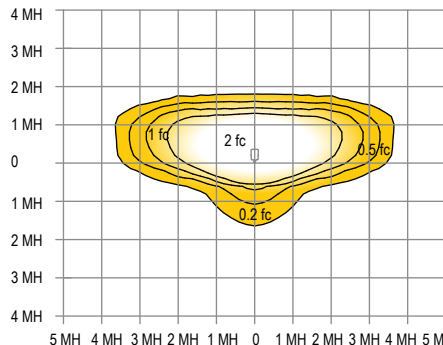

AFR

ECF-S EcoForm small

Area luminaire

3000K LED Wattage and Lumen Values

Ordering Code	Total LEDs	LED Current (mA)	Color Temp.	Average System Watts	Type 2			Type 3			Type 4		
					Lumen Output	BUG Rating	Efficacy (LPW)	Lumen Output	BUG Rating	Efficacy (LPW)	Lumen Output	BUG Rating	Efficacy (LPW)
ECF-S-32L-530-WW-G2-x	32	530	3000	56	6,178	B2-U0-G1	111	6,044	B1-U0-G2	109	6,323	B1-U0-G2	114
ECF-S-32L-700-WW-G2-x	32	700	3000	73	7,968	B2-U0-G2	109	7,795	B1-U0-G2	107	8,156	B1-U0-G2	112
ECF-S-32L-1A-WW-G2-x	32	1050	3000	106	11,218	B2-U0-G2	106	10,974	B2-U0-G2	104	11,482	B2-U0-G2	109
ECF-S-32L-1.2A-WW-G2-x	32	1200	3000	122	12,443	B3-U0-G2	102	12,173	B2-U0-G2	100	12,736	B2-U0-G3	105
ECF-S-48L-900-WW-G2-x	48	900	3000	135	14,768	B3-U0-G3	109	14,448	B2-U0-G3	107	15,116	B2-U0-G3	112
ECF-S-48L-1A-WW-G2-x	48	1050	3000	159	16,723	B3-U0-G3	105	16,360	B3-U0-G3	103	17,116	B2-U0-G3	108
ECF-S-48L-1.2A-WW-G2-x	48	1200	3000	183	18,564	B3-U0-G3	102	18,162	B3-U0-G3	99	19,001	B3-U0-G4	104
ECF-S-64L-900-WW-G2-x	64	900	3000	178	19,545	B3-U0-G3	110	19,121	B3-U0-G3	108	20,005	B3-U0-G4	113
ECF-S-64L-1A-WW-G2-x	64	1050	3000	206	22,020	B3-U0-G3	107	21,543	B3-U0-G4	105	22,538	B3-U0-G4	109

Ordering Code	Total LEDs	LED Current (mA)	Color Temp.	Average System Watts	Type 5			Type 5W			Type AFR		
					Lumen Output	BUG Rating	Efficacy (LPW)	Lumen Output	BUG Rating	Efficacy (LPW)	Lumen Output	BUG Rating	Efficacy (LPW)
ECF-S-32L-530-WW-G2-x	32	530	3000	56	6,400	B2-U0-G1	115	6,672	B3-U0-G2	120	6,458	B3-U0-G2	116
ECF-S-32L-700-WW-G2-x	32	700	3000	73	8,254	B2-U0-G1	113	8,606	B3-U0-G2	118	8,330	B4-U0-G2	114
ECF-S-32L-1A-WW-G2-x	32	1050	3000	106	11,621	B3-U0-G2	110	12,116	B4-U0-G2	115	11,727	B4-U0-G2	111
ECF-S-32L-1.2A-WW-G2-x	32	1200	3000	122	12,890	B3-U0-G2	106	13,440	B4-U0-G2	111	13,008	B4-U0-G2	107
ECF-S-48L-900-WW-G2-x	48	900	3000	135	15,299	B3-U0-G2	113	15,951	B4-U0-G2	118	15,438	B4-U0-G2	114
ECF-S-48L-1A-WW-G2-x	48	1050	3000	159	17,324	B3-U0-G2	109	18,062	B4-U0-G2	114	17,482	B5-U0-G3	110
ECF-S-48L-1.2A-WW-G2-x	48	1200	3000	183	19,231	B3-U0-G2	105	20,051	B5-U0-G3	110	19,407	B5-U0-G3	106
ECF-S-64L-900-WW-G2-x	64	900	3000	178	20,247	B3-U0-G2	114	21,111	B5-U0-G3	119	20,432	B5-U0-G3	115
ECF-S-64L-1A-WW-G2-x	64	1050	3000	206	22,811	B3-U0-G2	111	23,784	B5-U0-G3	116	23,020	B5-U0-G3	112

4000K LED Wattage and Lumen Values

Ordering Code	Total LEDs	LED Current (mA)	Color Temp.	Average System Watts	Type 2			Type 3			Type 4		
					Lumen Output	BUG Rating	Efficacy (LPW)	Lumen Output	BUG Rating	Efficacy (LPW)	Lumen Output	BUG Rating	Efficacy (LPW)
ECF-S-32L-530-NW-G2-x	32	530	4000	56	6,864	B2-U0-G2	123	6,715	B1-U0-G2	121	7,025	B1-U0-G2	126
ECF-S-32L-700-NW-G2-x	32	700	4000	73	8,853	B2-U0-G2	121	8,661	B2-U0-G2	119	9,062	B1-U0-G2	124
ECF-S-32L-1A-NW-G2-x	32	1050	4000	106	12,464	B3-U0-G2	118	12,194	B2-U0-G2	115	12,757	B2-U0-G3	121
ECF-S-32L-1.2A-NW-G2-x	32	1200	4000	122	13,826	B3-U0-G3	114	13,526	B2-U0-G3	111	14,151	B2-U0-G3	116
ECF-S-48L-900-NW-G2-x	48	900	4000	135	16,409	B3-U0-G3	121	16,053	B2-U0-G3	119	16,795	B2-U0-G3	124
ECF-S-48L-1A-NW-G2-x	48	1050	4000	159	18,581	B3-U0-G3	117	18,178	B3-U0-G3	115	19,018	B2-U0-G4	120
ECF-S-48L-1.2A-NW-G2-x	48	1200	4000	183	20,627	B3-U0-G3	113	20,180	B3-U0-G4	110	21,112	B3-U0-G4	116
ECF-S-64L-900-NW-G2-x	64	900	4000	178	21,717	B3-U0-G3	122	21,246	B3-U0-G4	119	22,228	B3-U0-G4	125
ECF-S-64L-1A-NW-G2-x	64	1050	4000	206	24,467	B3-U0-G3	119	23,936	B3-U0-G4	116	25,043	B3-U0-G4	122

Ordering Code	Total LEDs	LED Current (mA)	Color Temp.	Average System Watts	Type 5			Type 5W			Type AFR		
					Lumen Output	BUG Rating	Efficacy (LPW)	Lumen Output	BUG Rating	Efficacy (LPW)	Lumen Output	BUG Rating	Efficacy (LPW)
ECF-S-32L-530-NW-G2-x	32	530	4000	56	7,414	B3-U0-G2	133	7,175	B3-U0-G2	129	7,111	B2-U0-G1	128
ECF-S-32L-700-NW-G2-x	32	700	4000	73	9,563	B3-U0-G2	131	9,255	B4-U0-G2	127	9,172	B2-U0-G1	126
ECF-S-32L-1A-NW-G2-x	32	1050	4000	106	13,462	B4-U0-G2	127	13,030	B4-U0-G2	123	12,912	B3-U0-G2	122
ECF-S-32L-1.2A-NW-G2-x	32	1200	4000	122	14,933	B4-U0-G2	123	14,453	B4-U0-G2	119	14,322	B3-U0-G2	118
ECF-S-48L-900-NW-G2-x	48	900	4000	135	17,723	B4-U0-G2	131	17,154	B5-U0-G3	127	16,999	B3-U0-G2	126
ECF-S-48L-1A-NW-G2-x	48	1050	4000	159	20,069	B5-U0-G3	126	19,424	B5-U0-G3	122	19,248	B3-U0-G2	121
ECF-S-48L-1.2A-NW-G2-x	48	1200	4000	183	22,279	B5-U0-G3	122	21,563	B5-U0-G3	118	21,368	B3-U0-G2	117
ECF-S-64L-900-NW-G2-x	64	900	4000	178	23,456	B5-U0-G3	132	22,702	B5-U0-G3	128	22,497	B3-U0-G2	127
ECF-S-64L-1A-NW-G2-x	64	1050	4000	206	26,427	B5-U0-G3	128	25,577	B5-U0-G4	124	25,346	B3-U0-G2	123

ECF-S EcoForm small

Area luminaire

5000K LED Wattage and Lumen Values

Ordering Code	Total LEDs	LED Current (mA)	Color Temp.	Average System Watts	Type 2			Type 3			Type 4		
					Lumen Output	BUG Rating	Efficacy (LPW)	Lumen Output	BUG Rating	Efficacy (LPW)	Lumen Output	BUG Rating	Efficacy (LPW)
ECF-S-32L-530-CW-G2-x	32	530	5000	56	6,658	B2-U0-G2	120	6,514	B1-U0-G2	117	6,815	B1-U0-G2	122
ECF-S-32L-700-CW-G2-x	32	700	5000	73	8,588	B2-U0-G2	118	8,402	B2-U0-G2	115	8,790	B1-U0-G2	121
ECF-S-32L-1A-CW-G2-x	32	1050	5000	106	12,090	B3-U0-G2	114	11,828	B2-U0-G2	112	12,375	B2-U0-G3	117
ECF-S-32L-1.2A-CW-G2-x	32	1200	5000	122	13,411	B3-U0-G3	110	13,120	B2-U0-G3	108	13,726	B2-U0-G3	113
ECF-S-48L-900-CW-G2-x	48	900	5000	135	15,917	B3-U0-G3	118	15,572	B2-U0-G3	115	16,291	B2-U0-G3	121
ECF-S-48L-1A-CW-G2-x	48	1050	5000	159	18,023	B3-U0-G3	114	17,633	B3-U0-G3	111	18,447	B2-U0-G4	116
ECF-S-48L-1.2A-CW-G2-x	48	1200	5000	183	20,008	B3-U0-G3	110	19,574	B3-U0-G4	107	20,479	B3-U0-G4	112
ECF-S-64L-900-CW-G2-x	64	900	5000	178	21,065	B3-U0-G3	118	20,609	B3-U0-G4	116	21,561	B3-U0-G4	121
ECF-S-64L-1A-CW-G2-x	64	1050	5000	206	23,733	B3-U0-G3	115	23,218	B3-U0-G4	113	24,291	B3-U0-G4	118

Ordering Code	Total LEDs	LED Current (mA)	Color Temp.	Average System Watts	Type 5			Type 5W			Type AFR		
					Lumen Output	BUG Rating	Efficacy (LPW)	Lumen Output	BUG Rating	Efficacy (LPW)	Lumen Output	BUG Rating	Efficacy (LPW)
ECF-S-32L-530-CW-G2-x	32	530	5000	56	6,897	B2-U0-G1	124	7,191	B3-U0-G2	129	6,960	B3-U0-G2	125
ECF-S-32L-700-CW-G2-x	32	700	5000	73	8,896	B2-U0-G1	122	9,276	B3-U0-G2	127	8,978	B4-U0-G2	123
ECF-S-32L-1A-CW-G2-x	32	1050	5000	106	12,524	B3-U0-G2	119	13,058	B4-U0-G2	124	12,639	B4-U0-G2	120
ECF-S-32L-1.2A-CW-G2-x	32	1200	5000	122	13,893	B3-U0-G2	114	14,485	B4-U0-G2	119	14,020	B4-U0-G2	115
ECF-S-48L-900-CW-G2-x	48	900	5000	135	16,489	B3-U0-G2	122	17,192	B4-U0-G2	127	16,639	B5-U0-G3	123
ECF-S-48L-1A-CW-G2-x	48	1050	5000	159	18,671	B3-U0-G2	118	19,467	B5-U0-G3	123	18,841	B5-U0-G3	119
ECF-S-48L-1.2A-CW-G2-x	48	1200	5000	183	20,727	B3-U0-G2	113	21,611	B5-U0-G3	118	20,916	B5-U0-G3	114
ECF-S-64L-900-CW-G2-x	64	900	5000	178	21,822	B3-U0-G2	123	22,753	B5-U0-G3	128	22,021	B5-U0-G3	124
ECF-S-64L-1A-CW-G2-x	64	1050	5000	206	24,586	B3-U0-G2	119	25,634	B5-U0-G3	124	24,810	B5-U0-G4	120

Area lumineaire

Standard Arm (AR)

Wall (WS)

Weight: 27 Lbs. (12.2Kg) EPA: 0.27ft² (.025m²)

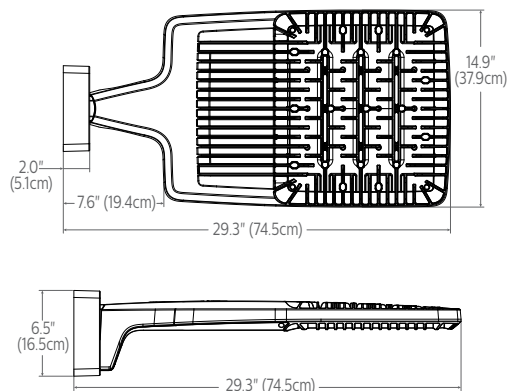
Slip fitter (**SF**)

Weight: 27 Lbs (12.2 Kg) EPA: 0.33ft² (.031m²)

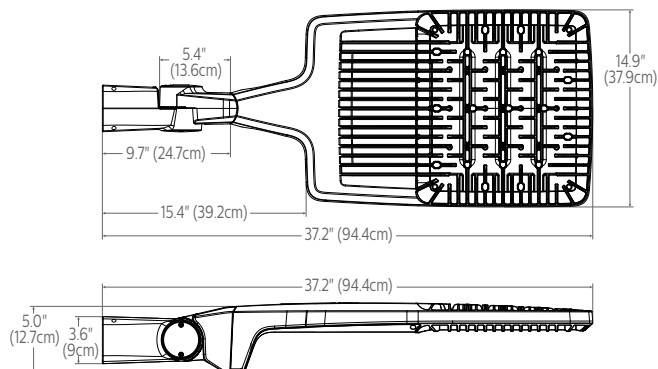

Standard Arm (AR)
drill pattern

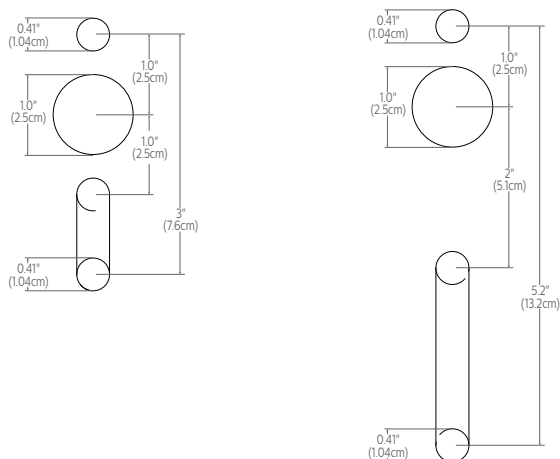

Retrofit Arm (**RAM**)
drill pattern

ECF-S EcoForm small

Area luminaire

Optical Orientation Information

Standard Optic Position

Luminaires ordered with asymmetric optical systems in the standard optic position will have the optical system oriented as shown below:

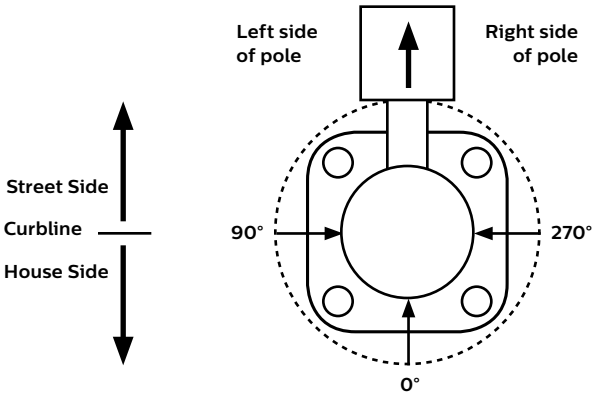

Note: The hand hole will normally be located on the pole at the 0° point.

Optic Rotated Left (90°) Optic Position

Luminaires ordered with optical systems in the Optic Rotated Left (90°) optic position will have the optical system oriented as shown below (Type 5 and 5W optics are not available with factory set rotatable optics):

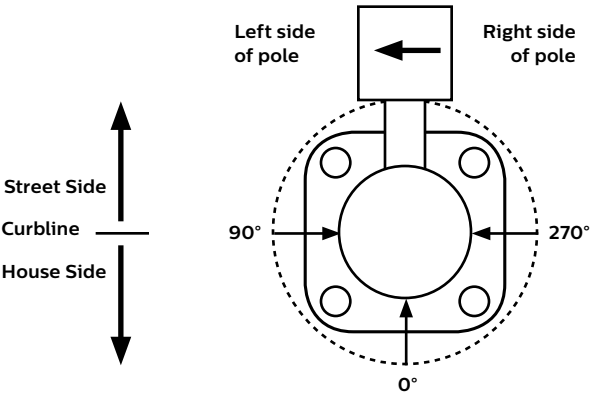

Note: The hand hole will normally be located on the pole at the 0° point.

Optic Rotated Right (270°) Optic Position

Luminaires ordered with optical systems in the Optic Rotated Right (270°) optic position will have the optical system oriented as shown below (Type 5 and 5W optics are not available with factory set rotatable optics):

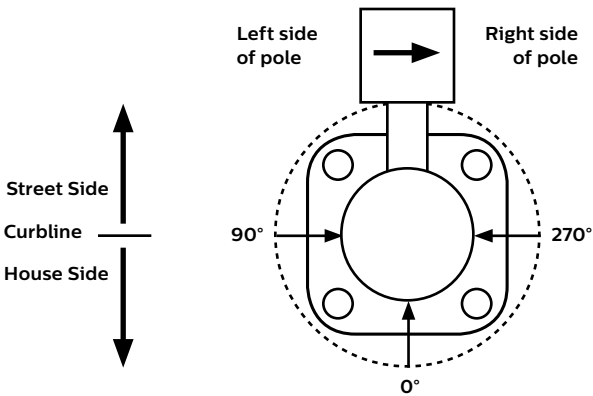

Note: The hand hole will normally be located on the pole at the 0° point.

Twin Luminaire Assemblies with Type-90/Type-270 Rotated Optical Systems

Twin luminaire assemblies installed with rotated optical systems are an excellent way to direct light toward the interior of the site (Street Side) without additional equipment. It is important, however, that care be exercised to insure that luminaires are installed in the proper location.

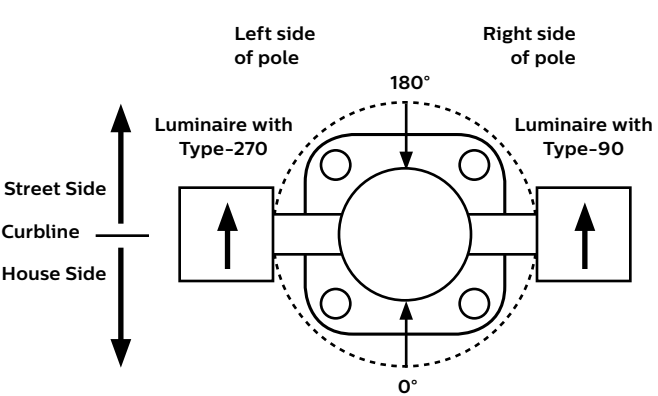

Luminaires with Optic Rotated Right (270°) are installed on the LEFT Side of Pole

Luminaires with Optic Rotated Left (90°) are installed on the RIGHT Side of Pole

Note: The hand hole location will depend on the drilling configuration ordered for the pole.

ECF-S EcoForm small

Area luminaire

Specifications

Housing

One-piece die cast aluminum housing with integral arm and separate, self-retained hinged, one-piece die cast door frame. Luminaire housing rated to IP66, tested in accordance to Section 9 of IEC 60598-1.

Vibration resistance

Luminaire is tested and rated 3G over 100,000 cycles conforming to standards set forth by ANSI C136.31-2010. Testing includes vibration in three axes, all performed on the same luminaire.

Light engine

Light engine comprises of a module of 16-LED aluminum metal clad board fully sealed with optics offered in multiples of 2, 3, and 4 modules or 32, 48, and 64 LEDs. Module is RoHS compliant. Color temperatures: 3000K +/-125K, 4000K, 5000K +/- 200K. Minimum CRI of 70. LED light engine is rated IP66 in accordance to Section 9 of IEC 60598-1.

Energy saving benefits

System efficacy up to 133 lms/W with significant energy savings over Pulse Start Metal Halide luminaires. Optional control options provide added energy savings during unoccupied periods.

Optical systems

Type 2, 3, 4, 5, 5W, and AFR distributions available. Internal Shield option mounts to LED optics and is available with Type 2, 3, 4, and AFR distributions. Types 2, 3, 4, and AFR when specified and used as rotated, are factory set only. Performance tested per LM-79 and TM-15 (IESNA) certifying its photometric performance. Luminaire designed with 0% uplight (U0 per IESNA TM-15).

Mounting

Standard luminaire arm mounts to 4" O.D. round poles. Can also be used with 5" O.D. poles. Square pole adapter included with every luminaire. Round Pole Adapter (RPA) required for 3-3.9" poles. EcoForm features a retrofit arm kit. When specified with the retrofit arm (RAM) option, EcoForm seamlessly simplifies site conversions to LED by eliminating the need for additional pole drilling on most existing poles. RAM will be boxed separately. Also optional are slipfitter and wall mounting accessories.

Control options

0-10V dimming (DD): Access to 0-10V dimming leads supplied through back of luminaire (for secondary dimming controls by others). Cannot be used with other control options.

Dual Circuit Control (DCC): Luminaire equipped with the ability to have two separate circuits controlling drivers and light engines independently. Permits separate switching of separate modules controlled by use of two sets of leads, one for each circuit. Not recommended to be used with other control options, motion response, or photocells.

SiteWise (SW): SiteWise system includes a controller fully integrated in the luminaire that enables the luminaires to communicate with a dimming signal transmitter cabinet located on site using patented central dimming technology. A locally accessible mobile app allows users to access the system and set functionalities such as ON/OFF, dimming levels and scheduling. SiteWise is available with motion response options in order to bring the light back to 100% when motion is detected. Cannot be used with other control options or photocell options. Additional functionalities are available such as communication with indoor lighting and connection to BMS systems. Complete information on the control system can be found on the SiteWise website at philips.com/sitewise.

Automatic Profile Dimming (CS/CM/CE/CA): Standard dimming profile of 30% or 50% provide flexibility towards energy savings goals while optimizing light levels during specific dark hours. When used in combination with not programmed motion response it overrides the controller's schedule when motion is detected. After 5 minutes with no motion, it will return to the automatic dimming profile schedule. Automatic dimming profile scheduled with the following settings:

- **CS50/CS30:** Security for 7 hours night duration (Ex., 11 PM – 6 AM)
- **CM50/CM30:** Median for 8 hours night duration (Ex., 10 PM – 6 AM)
- **CE50/CE30:** Economy for 9 hours night duration (Ex., 9 PM – 6 AM)
- **CA50/CA30:** for all night (during all dark hours)

All above profiles are calculated from mid point of the night. Dimming is set for 6 hours after the mid point and 1, 2, or 3 hours before depending of the duration of dimming. Cannot be used with other dimming control options.

Field Adjustable Wattage Selector (FAWS): Luminaire equipped with the ability to manually adjust the wattage in the field to reduce total luminaire lumen output and light levels. Comes pre-set to the highest position at the lumen output selected. Use chart below to estimate reduction in lumen output desired. Cannot be used with other control options or motion response.

FAWS Position	Percent of Typical Lumen Output
1	25%
2	50%
3	55%
4	65%
5	75%
6	80%
7	85%
8	90%
9	95%
10	100%

Note: Typical value accuracy +/- 5%

Wireless system (LLC): Optional wireless controller integral to luminaire ready to be connected to a Limelight system (sold by others). The system allows you to wirelessly manage the entire site, independent lighting groups or individual luminaires while on-site or remotely. Based on a high-density mesh network with an easy to use web-based portal, you can conveniently access, monitor and manage your lighting network remotely. Wireless controls can be combined with site and area, pedestrian, and parking garage luminaires as well, for a completely connected outdoor solution. Equipped with motion response with #3 lens for 8-25' mounting heights. Also available with remote pod accessory where pod is mounted separate from luminaire to pole or wall.

LLC wireless controller with #3 lens

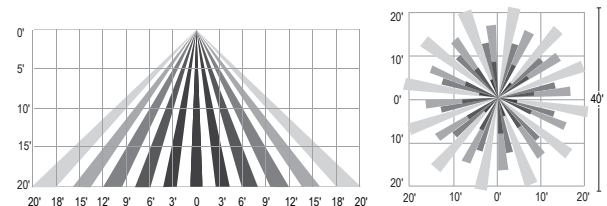

Motion response options

Bi-Level Infrared Motion Response (BL-IMRI): Motion Response module is mounted integral to luminaire factory pre-programmed to 50% dimming when not ordered with other control options. BL-IMRI is set/operates in the following fashion: The motion sensor is set to a constant 50%. When motion is detected by the PIR sensor, the luminaire returns to full power/light output. Dimming on low is factory set to 50% with 5 minutes default in "full power" prior to dimming back to low. When no motion is detected for 5 minutes, the motion response system reduces the wattage by 50%, to 50% of the normal constant wattage reducing the light level. Other dimming settings can be provided if different dimming levels are required. This can also be done with FSIR-100 Wireless Remote Programming Tool (contact Technical Support for details).

Infrared Motion Response with Other Controls: When used in combination with other controls (Automatic Dimming Profile and SiteWise), motion response device will simply override controller's schedule with the added benefits of a combined dimming profile and sensor detection. In this configuration, the motion response device cannot be re-programmed with FSIR-100 Wireless Remote Programming Tool. The profile can only be re-programmed via the controller.

ECF-S EcoForm small

Area luminaire

Specifications

Infrared Motion Response Lenses (IMRI3/IMRI7): Infrared Motion Response Integral module is available with two different sensor lens types to accommodate various mounting heights and occupancy detection ranges. Lens #3 (IMRI3) is designed for mounting heights up to 20' with a 40' diameter coverage area. Lens #7 is designed for higher mounting heights up to 40' with larger coverage areas up to 100' diameter coverage area. See charts for approximate detection patterns:

IMRI3 Luminaire or remote mount controller with #3 lens

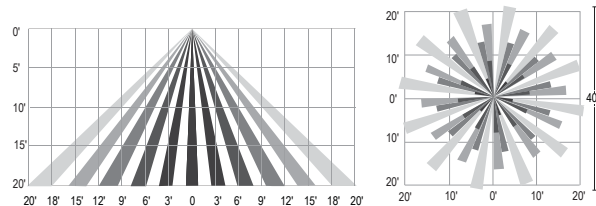

IMRI7 Luminaire or remote mount controller with #7 lens

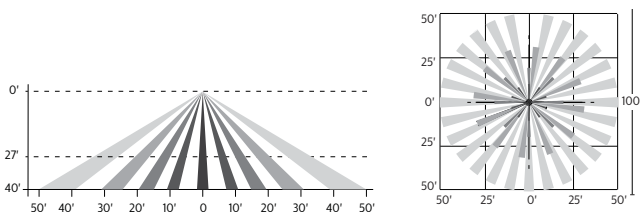

Infrared Motion Response Outboard (IMRO): Infrared Motion Response Outboard can be used in combination with automatic profile dimming and stand alone motion response. The pole mounted motion sensor is a PIR (passive infrared) device that can be mounted to a pole. One motion sensor per pole is required. Sensor finish is white Wattstopper EW-200-120-W or the EW-200-277-W. Order MS-A-120 or MS-A-277 separately. IMRO sensors require single voltage 120V or 277V input. If motion is detected during the time that the luminaire is operating at profile dimming mode specified, the luminaire returns to 100% power and light output. The luminaire remains on high until no motion is detected for the duration period, after which the luminaire returns back to automatic profile dimming. Duration period is factory set at 15 minutes, and is field adjustable from 5 minutes up to 15 minutes. The area motion detector provides coverage equal to up to 6 times the sensor height above ground, 270° from the front-center of the sensor (see chart for approximate detection patterns).

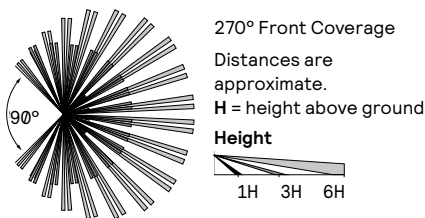

Pole Details: IMRO requires that the pole include additional hand hole 15 feet above the pole base, normally oriented 180° to the standard hand hole. For Gardco poles, order the pole with the Motion Sensor Mounting (MSM) option

which includes the hand hole and a special hand hole cover plate for the sensor with a 1/2" NPT receptacle centered on the hand hole cover plate into which the motion sensor mounts. Once the motion sensor is connected to the hand hole cover plate, then wiring connections are completed in the pole. The plate (complete with motion sensor attached and wired) is then mounted to the hand hole. If poles are supplied by others, the customer is responsible for providing suitable mounting accommodations for the motion sensor in the pole (see Gardco Poles specification sheets for more information).

Electrical

Twist-Lock Receptacle (TLRD5/TLRD7/TLRPC): Twist Lock Receptacle with 5 pins enabling dimming or with 7 pins with additional functionality (by others) can be used with a twistlock photoelectric cell or a shorting cap. Dimming Receptacle Type B (5-pin) and Type D-24 (7-pin) in accordance to ANSI C136.41. Can be used with third-party control system. Receptacle located on top of luminaire housing. When specifying receptacle with twistlock photoelectric cell, voltage must be specified. When ordering Twist-lock receptacle (TLRD5 or TLRD7), photocell or shorting cap is not included.

Driver: Driver efficiency (>90% standard). 120-480V available (restrictions apply). Open/short circuit protection. Optional 0-10V dimming to 10% power. RoHS compliant.

Button Photocontrol (PCB): Button style design for internal luminaires mounting applications. The photocontrol is constructed of a high impact UV stabilized polycarbonate housing. Rated voltage of 120V or 208-277V with a load rating of 1000 VA. The photocell will turn on with 1-4Fc of ambient light.

Surge protection (SP1/SP2): Surge protection device tested in accordance with ANSI/IEEE C62.45 per ANSI/IEEE C62.41.2 Scenario I Category C High Exposure 10kV/10kA waveforms for Line-Ground, Line-Neutral and Neutral-Ground, and in accordance with DOE MSSLC Model Specification for LED Roadway Luminaires Appendix D Electrical Immunity High test level 10kV/10kA. 20kV / 10kA surge protection device that provides extra protection beyond the SP1 10kV/10kA level.

Listings

UL/cUL wet location listed to the UL 1598 standard, suitable for use in ambient temperatures from -40° to 40°C (-40° to 104°F). Most EcoForm configurations are qualified under Premium and Standard DesignLights Consortium® categories. Consult DLC Qualified Products list to confirm your specific luminaire selection is approved. CCTs 3000K and warmer are Dark Sky Approved.

Finish

Each standard color luminaire receives a fade and abrasion resistant, electrostatically applied, thermally cured, triglycidal isocyanurate (TGIC) textured polyester powdercoat finish. Standard colors include bronze (BZ), black (BK), white (WH), dark gray (DGY), and medium gray (MGY). Consult factory for specs on optional or custom colors.

Service Tag

Each individual luminaire is uniquely identifiable, thanks to the Service tag application. With a simple scan of a QR code, placed on the inside of the mast door, you gain instant access to the luminaire configuration, making installation and maintenance operations faster and easier, no matter what stage of the luminaire's lifetime. Just download the APP and register your product right away. For more details visit: signify.com

Warranty

EcoForm luminaires feature a 5-year limited warranty. See signify.com/warranties for complete details and exclusions.

The information presented in this document is not intended as any commercial offer and does not form part of any quotation or contract.



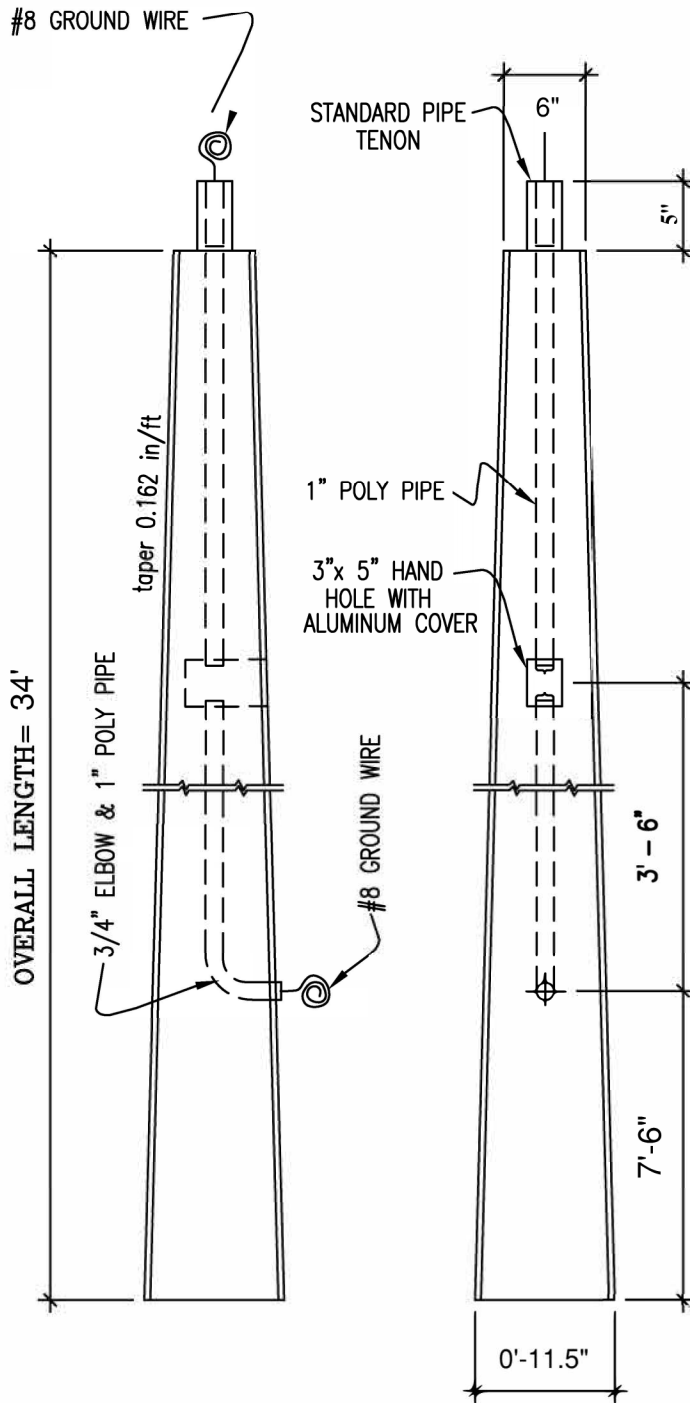

LENGTH OF POLE	34 FT.			
EMBEDMENT SPECIFIED	9 FT.			
HEIGHT ABOVE GROUND	25 FT.			
WEIGHT	2700 LBS.			
WIND VELOCITY (mph)	150	160	170	180
MAXIMUM EPA* (sq. ft.)	12.1	10.6	9.4	8.4

Above embedment shown in SAND.
Other embedment depth may be required for other soil condition.

STANDARD PIPE TENON SIZE CIRCLE ONE:	
Nominal Diameter (in)	Outside Diameter (in)
2"	2 3/8"
2 1/2"	2 7/8"
3"	3 1/2"
3 1/2"	4"
4"	4 1/2"

Please order tenon by nominal diameter.

Signature: _____

Date: _____

34 ft. TYPE II -0 POLE