

SITE PLAN KEYNOTES

- 01 NEW 6' HIGH CHAIN LINK FENCE. SEE DETAIL 2/A0.13
- 02 NEW CONCRETE WALK.
- 03 NEW LANDSCAPE AREA.
- 04 EXISTING ASPHALT PARKING LOT TO BE RESURFACED
- 05 EXISTING CONCRETE SIDEWALK TO REMAIN
- 06 SAW CUT CONCRETE JOINTS.
- 07 (2) 6' HIGH X 8' WIDE PICKET GATES. SEE DETAIL 3/A0.13
- 08 ENTRANCE STRUCTURE, SEE DRAWINGS ON SHEET A0.12
- 09 NEW DO NOT ENTER AND STOP SIGNS.
- 10 EXISTING LANDSCAPING TO REMAIN
- 11 2 NEW HANDICAP PARKING SPACES.
- 12 10 EXISTING PARKING SPACES TO BE RESURFACED
- 13 6 EXISTING PARKING SPACES TO BE RESURFACED
- 14 NEW CONCRETE CURB TO REPLACE EXISTING
- 15 EXISTING LANDSCAPE STRIP
- 16 PROPOSED FIRE HYDRANT
- 17 PROPOSED WATER METER
- 18 EXISTING CHAIN LINK FENCE AND ROLLING GATE TO REMAIN
- 19 EXISTING SIGN TO REMAIN
- 20 NEW CONCRETE CURB
- 21 PROPOSED NEW ONE WAY EXIT
- 22 TUBULAR BAR GATE ON POST WITH KEEPER POST ON OTHER SIDE. SEE DETAIL 1/A0.13
- 23 PROPOSED CONCESSION BUILDING ROOF. SEE SHEET A2.50 FOR ROOF PLAN ENLARGEMENT. SEE SHEET A2.10 FOR FLOOR PLAN ENLARGEMENTS
- 24 CANOPY ROOF. PROPOSED COVERED WALKWAY BELOW. SEE A0.11
- 25 PROPOSED METAL BUILDING ROOF. SEE SHEETS A1.50A AND A1.50B FOR ROOF PLAN ENLARGEMENTS. SEE SHEETS A1.10A AND A1.10B FOR FLOOR PLAN ENLARGEMENTS
- 26 NEW CATCH BASIN
- 27 EXISTING CHAIN LINK FENCE TO REMAIN
- 28 EXISTING LIGHT TO REMAIN
- 29 PROPERTY LINE
- 30 UTILITY EASEMENT LINE
- 31 EXISTING FPL POLE AND LIGHT
- 32 NEW RETENTION AREA
- 33 OVERHEAD POWERLINES
- 34 LANDSCAPE AREA WITH NEW TREES AND SHRUBS
- 35 PROPOSED CLEANOUT CAP FLUSH AT FINISHED FLOOR
- 36 EXISTING PARKING AREA TO BE RESURFACED
- 37 EXISTING FPL ELECTRIC POLE

NOTES:
SEE CIVIL, LANDSCAPE & IRRIGATION DRAWINGS FOR ADDITIONAL INFORMATION.



WALTERS
ZACKRIA
ARCHITECTS

3813 N. ANDREW'S WAY
FORT LAUDERDALE, FL 33309
PHONE: (954) 522-4123
FAX: (954) 522-4128
www.wza-architects.com

Abbas H. Zackria, FL AR 91520
Florida Registration: AA3600978
CORPORATE NAME: WALTERS ZACKRIA ASSOCIATES, PLLC REGISTERED IN THE STATE OF FLORIDA. WRITTEN DIMENSIONS TAKE PRECEDENCE OVER SCALED DIMENSIONS. THESE DRAWINGS ARE THE PROPERTY OF WALTERS ZACKRIA ASSOCIATES, PLLC, AND SHALL NOT BE REPRODUCED WITHOUT WRITTEN PERMISSION FROM A PRINCIPAL OF THE FIRM OR BE LIABLE FOR THE FULLEST LEGAL RECOURSE. CONTRACTOR SHALL VERIFY ALL EXISTING CONDITIONS AND DIMENSIONS AND NOTIFY THE ARCHITECT OF ANY DISCREPANCIES PRIOR TO EXECUTION OF WORK.

MARGATE CRA
MARGATE SPORTS PARK
1695 BANKS ROAD
MARGATE FL 33063

DRAWN BY: AC
CHECKED BY: OM
DATE: 03/02/2020
REVISIONS:

1914
SHEET
A0.10

SITE PLAN



1

SITE PLAN
SCALE: 1/8"=1'-0"

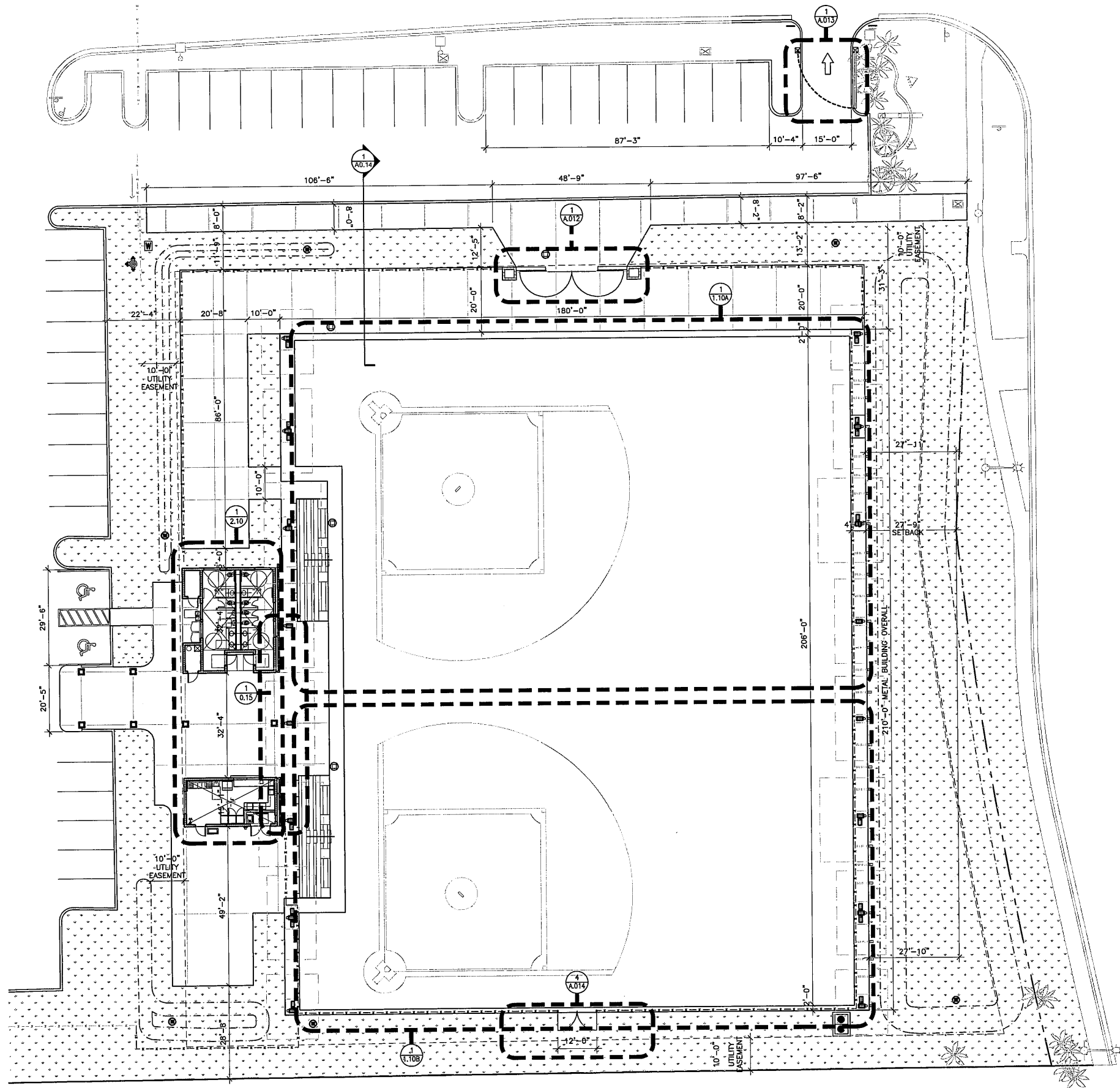

1

BUILDING FLOOR PLANS ON SITE

SCALE: 1/8" = 1'-0"



**WALTERS
ZACKRIA
ARCHITECTS**

5913 N. ANDREWS WAY
FORT LAUDERDALE, FL 33309
PHONE: (954) 522-4123
FAX: (954) 522-4128
www.wza-architects.com

Abbas H. Zackria, FL AR 91520
Florida Registration: A26000979

CORPORATE NAME: WALTERS, ZACKRIA ASSOCIATES, PLLC, REGISTERED IN THE STATE OF FLORIDA. WRITTEN DIMENSIONS TAKE PRECEDENCE OVER SCALED DIMENSIONS. THESE DRAWINGS ARE THE PROPERTY OF WALTERS, ZACKRIA ASSOCIATES, PLLC, AND SHALL NOT BE REPRODUCED WITHOUT WRITTEN PERMISSION FROM A PRINCIPAL OF THE FIRM OR BE LIABLE FOR THE FULLEST LEGAL RECOURSE. CONTRACTOR SHALL VERIFY ALL EXISTING CONDITIONS AND DIMENSIONS AND NOTIFY THE ARCHITECT OF ANY DISCREPANCIES PRIOR TO EXECUTION OF WORK.

**MARGATE CRA
MARGATE SPORTS PARK
1695 BANKS ROAD
MARGATE FL 33063**

DRAWN BY: ZM
CHECKED BY: OM
DATE: 03/02/2020
REVISIONS:

1914

SHEET

A0.11

BUILDING FLOOR PLANS
ON SITE